

LED CYLINDER PENDANT

**LED CYLINDER
INSTALLATION INSTRUCTIONS**



RISK OF FIRE AND ELECTRICAL SHOCK. FIXTURE MUST BE INSTALLED BY A QUALIFIED ELECTRICIAN ONLY IN ACCORDANCE WITH NATIONAL, LOCAL BUILDING AND ELECTRICAL CODES. DISCONNECT POWER AT ELECTRICAL PANEL BEFORE SERVICING.

► **4" Pendant With Cable**

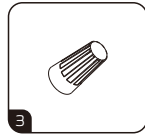
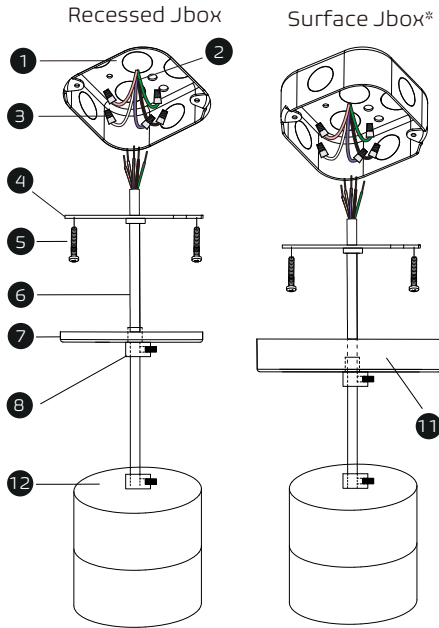

Wire Nut

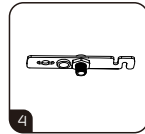

Junction Box Crossbar

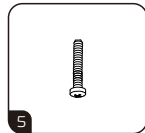

Screw PM4*22

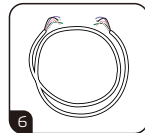

Power Cord

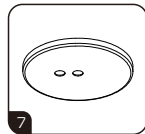

4" Canopy Power Feed

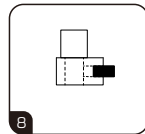

Cable Clip

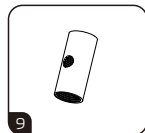

Cable Holder

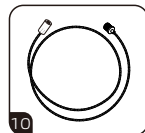

Aircraft Cable

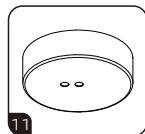

6" Canopy Power Feed

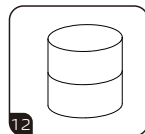

4" /6" /8" Lamp

► **6" And 8"* Pendant With Cable**

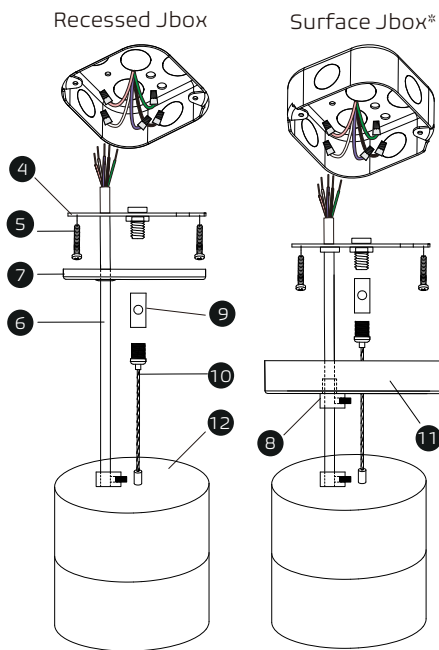

*8" fixture and custom mounting options available via Special Order. Please call 1-800-624-4488 for more information.

► **PARTS**

- 1 4" Octagon Junction Box (By Others)
- 2 Power Cord (By Others)
- 3 Wire Nut
- 4 Junction Box Crossbar
- 5 Screw PM4*22
- 6 Power Cord
- 7 4" Canopy Power Feed
- 8 Cable Clip
- 9 Cable Holder
- 10 Aircraft Cable
- 11 6" Canopy Power Feed
- 12 4" /6" /8"* Lamp

IMPORTANT

1. Read all instructions.
2. Install in accordance with national and local electrical code regulations.
3. This product is intended to be installed and serviced by a qualified, licensed electrician.
4. Do not install in wet locations. For dry and damp use only.
5. Turn off electrical power before installing or servicing fixture in any way.
6. To reduce the risk of fire and overheating, make sure all connections are tight.
7. Under no circumstances can the lighting fixture be covered with heat insulation gasket or similar materials.

WIRING

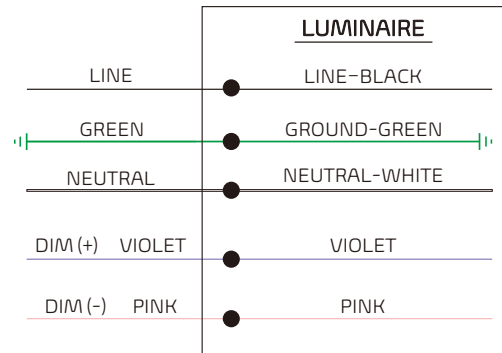

STRUCTURE OF LAMP

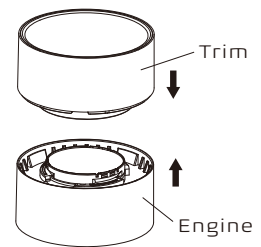

When trim and engine are separated, attached together, and secure them with clockwise direction.