

**MINDRIVE 60™** is a miniature LED driver that you can use with confidence. It meets FCC consumer limits for radiated RF and carries a 5-year warranty. It's compact size fits in tight spaces and 90% efficiency helps it run cool.

- 60W Maximum Load
- Phase Dimmable
- Also Operates Without Dimmer
- 12V or 24V Output

# MINDRIVE 60™



## APPLICATIONS

- ▶ Tape Lighting
- ▶ Undercabinet
- ▶ Linear
- ▶ Cove Lighting
- ▶ Toe Kick
- ▶ Puck Lights

## KEY BENEFITS

### Documented Dimming Performance

- Phase Dimmable with ELV, CL and Caseta
- Minimum dimming level by dimmer model
- Dimmer list accessible with QR code

### Use with Confidence

- Meets FCC limits for consumer devices
- 5 Year Warranty

### Easy to Install

- Fits in single-gang switch box



Size:  
2.9" x 1.6" x 0.9"

# MINDRIVE 60™ Mini Constant Voltage LED Driver

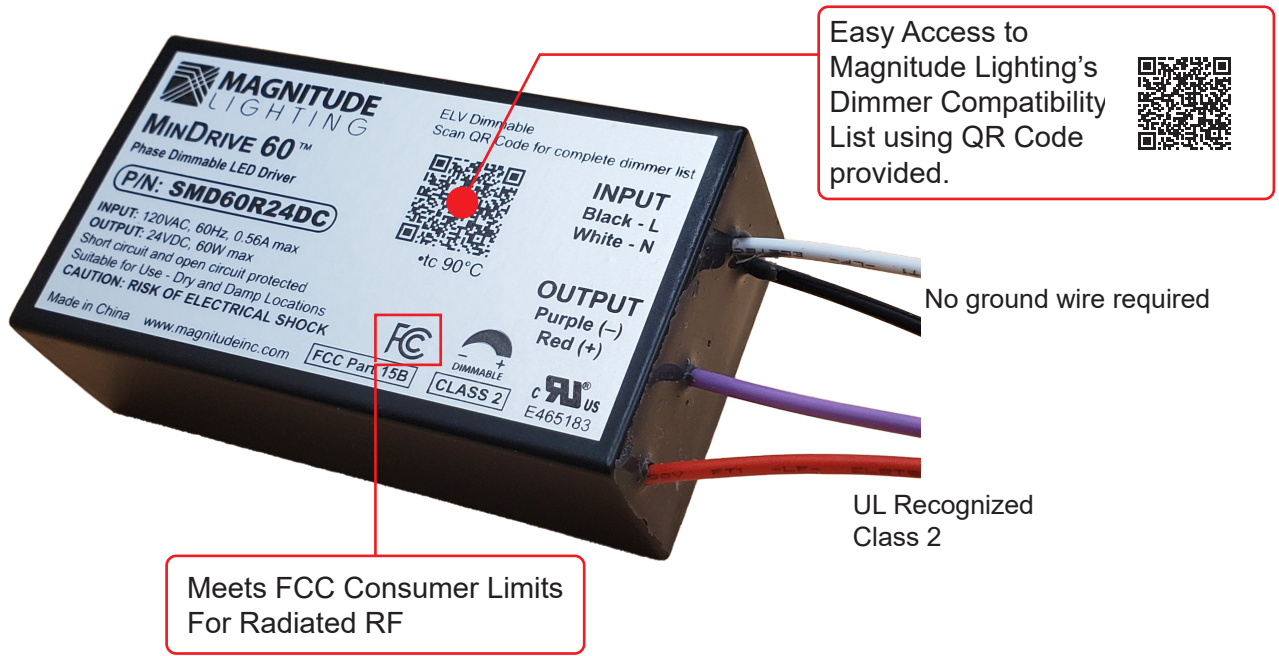

ORDERING GUIDE					
Part Number	Max Load	Input	Output	Dimming	Class 2
SMD60R12DC	60W	120VAC	12W	Phase	Yes
SMD60R24DC	60W	120VAC	24W	Phase	Yes

PRODUCT SIZE	
Width	2.9" (74mm)
Height	1.6" (41mm)
Depth	0.9" (23mm)

## MECHANICAL DIAGRAM

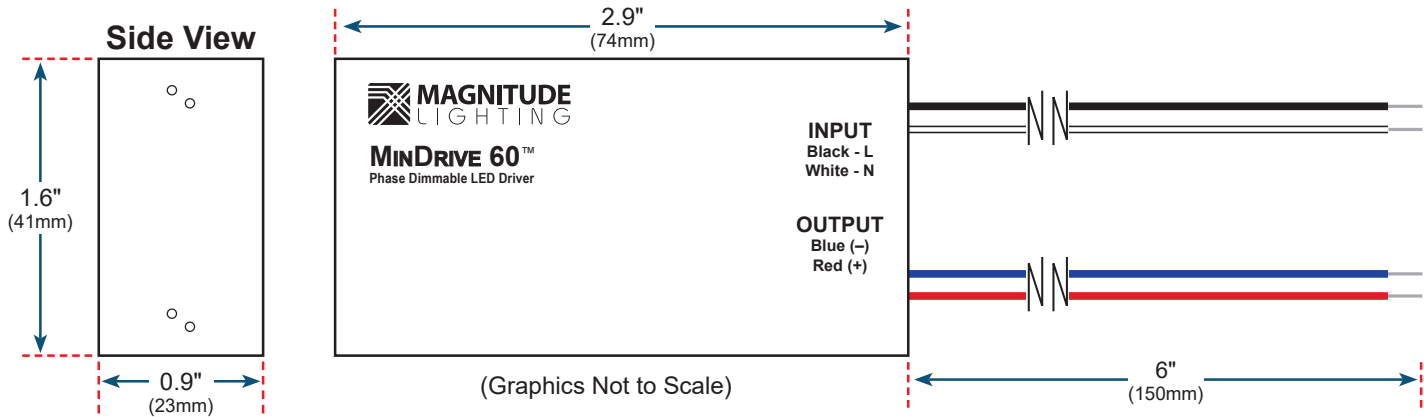

16782 Von Karman Ave.  
 Units 32 & 33  
 Irvine, California 92606  
 Email: [info@magnitudeinc.com](mailto:info@magnitudeinc.com)  
 Phone: (714) 312-5080 | Fax: (714) 312-5070  
 Visit us on the web ([magnitudeinc.com](http://magnitudeinc.com))!  
 Copyright© 2023 Magnitude Lighting (REV003)