

TUBUL@RCH T8 – INSTALLATION INSTRUCTIONS

Products covered by this instruction guide¹:

- Tubul@RCH | SMART8

	<p>IMPORTANT SAFETY INSTRUCTIONS</p> <p>THE SMART8 IS CAPABLE OF EITHER UL TYPE-A WITH A BALLAST, OR TYPE-B FOR DIRECT WIRE WITH LINE AND NEUTRAL</p>
---	--

The retrofit kit includes one (1) LED tube, one (1) installation instruction, and one (1) field-applied label.

Risk of fire or electric shock – the electrical rating of this product is 120-277V, the installer must determine whether they have AC120-277V at the luminaire before installation.

Risk of fire or electric shock – retrofit kit installation requires knowledge of florescent lighting luminaires electrical systems. If not qualified, do not attempt installation. Contact a qualified electrician.

Risk of fire or electric shock – install this kit only in the luminaires that have the construction features and dimensions shown in the drawings.

Risk of fire or electric shock – do not use this kit in luminaires that employ shunted bi-pin lamp holders (found in fixtures that use instant start ballasts).

Rick of fire or electric shock – luminaires wiring, ballasts, or other electrical parts may be damaged when drilling for installation of retrofit kit hardware. Check for enclosed wiring and components.

To prevent wiring damage or abrasion, do not expose wiring to edges of sheet metal or other sharp objects.

	<p>FOR DIRECT REPLACEMENT OF FLUORSCENT LAMPS (32W/48T8, 30W/48T8, 28W/48T8, 25W/48T8)</p>
---	---

STEP 1: Disconnect power from fixture

STEP 2: Remove diffuser (if necessary)

STEP 3: Remove the exiting florescent lamps from the luminaire

STEP 4: Install the LED T8 replacement lamp per **错误！未找到引用源。**

STEP 5: Replace diffuser (if removed in STEP 2)

STEP 6: Switch on power to the luminaire

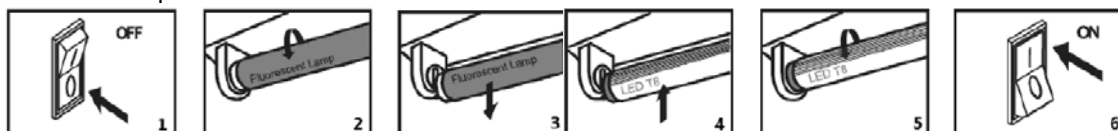

Figure 1

¹ NOTE: Specifications are subject to change without notice.

TUBUL@RCH T8 – INSTALLATION INSTRUCTIONS

	FOR USE AS LED LUMINAIRE CONVERSION RETROFIT KIT
---	---

DANGER – RISK OF SHOCK-DISCONNECT POWER BEFORE INSTALLATION. The retrofit kits including Installation Instructions, LED Lamp, Luminaire Marking Labels.

The T8 LED tubes are intended to retrofit Listed surface mounted, type Non-IC or type IC recessed mounted fluorescent luminaires with or without diffuser for maximum four lamps with lamp to lamp distance 11 cm minimum; Or retrofit surface mounted Listed fluorescent luminaires without diffuser for maximum six lamps with lamp to lamp distance 5.5 cm minimum.

The products are intended to be used in dry and damp locations only.

ELECTRICAL RATINGS:

Model Number	Input Ratings				Nominal Length (FT)
	Voltage (V)	Frequency (Hz)	Current (mA)	Wattage (W)	
LT8F208xxU5	120-277V	50/60Hz	80mA	8W	2FT
LT8F312xxU5	120-277V	50/60Hz	110mA	12W	3FT
LT8F412xxU5	120-277V	50/60Hz	110mA	12W	4FT
LT8F415xxU5	120-277V	50/60Hz	140mA	15W	4FT

- STEP 1:** Shut OFF power work.
- STEP 2:** Remove existing fluorescent tube(s) and diffuser (if applicable) and open the ballast cover.
- STEP 3:** Disconnect luminaire supply wirings L and N to branch circuit as shown in Figure 2.

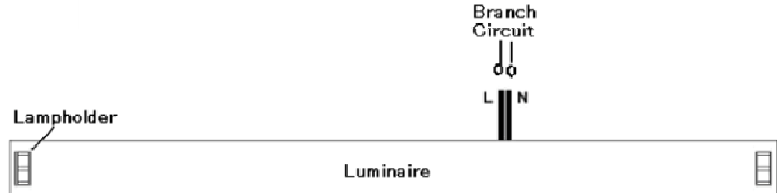

Figure 2

- STEP 4:** Original circuit as shown in Figure 3. Cut lamp holder leads “1, 2, 3, 4, L, N”, then check whether the lamp holder is shunted. Cut as far away from the lamp holders to allow for longer lengths of wire at both lamp holders.

Note: Ballast must be retained in place.

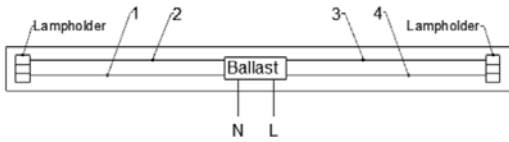

Figure 3

- STEP 5:** Check the lamp holders. If the lamp holders are shunted, go to STEP 6. If the lamp holders are not shunted, go to STEP 7. For “One End” wiring configuration only, “WARNING: To avoid potential fire or shock

TUBUL@RCH T8 – INSTALLATION INSTRUCTIONS

hazard, do not use this retrofit kit in luminaires employing shunted bi-pin lamp holders. Note: Shunted lamp holders are found only in fluorescent luminaires with Instant-Start ballasts. Instant-start ballasts can be identified by the words "Instant Start" or "I.S." marked on the ballast. This designation may be in the form of a statement pertaining to the ballast itself, or may be combined with the marking for the lamps with which the ballast is intended to be used, for example F40T12/IS. For more information, contact the LED luminaire retrofit kit manufacturer.”.

STEP 6: If the lamp holders are shunted, connect one lead from each lamp holder to branch circuit as follows, “Leads 3 and 4” connected to L; “Leads 1 and 2” connected to N as shown in Figure 4

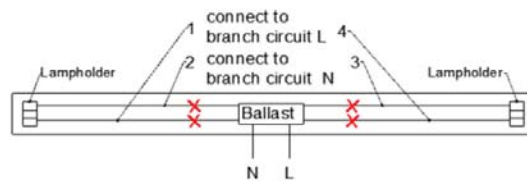

STEP 7a: The lamp holders are not shunted. “One End” or “Both End” wiring can be selected. For “One End” wiring, connect one lead from each lamp holder to branch circuit as follows, “Leads 1” connected to L; “Leads 2” connected to N. or “Leads 4” connected to L; “Leads 3” connected to N.

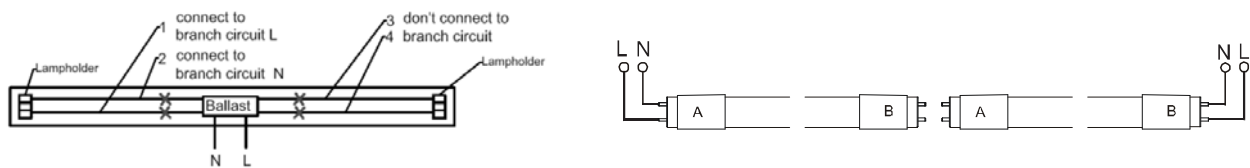

Figure 5

STEP 7b: For “Both Ends” wiring, connect one lead from each lamp holder to branch circuit as follows, “Leads 1 and Leads 2” connected to L; “Leads 3 and Leads 4” connected to N. or “Leads 1” connected to L; “Leads 3” connected to N. as shown in Figure 6.

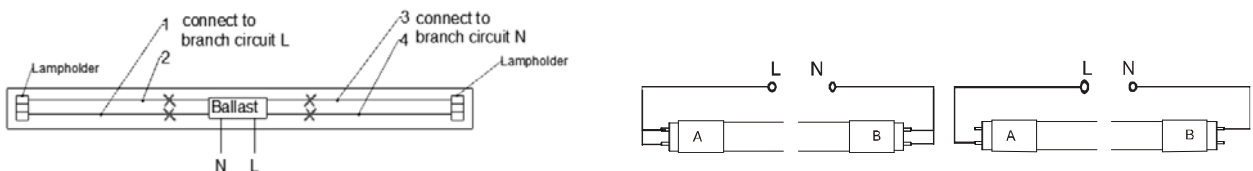

Figure 6

STEP 8: Attach the field-applied label to the luminaire. Install the ballast cover and diffuser (if applicable) back on luminaire, and LED T8 tube as show in Figure 7.

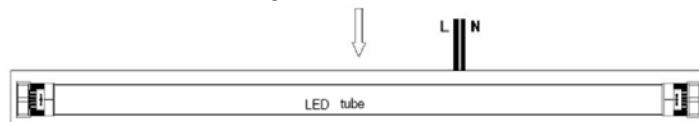

Figure 7

SERVICE CONTACT:

Archipelago Lighting, Inc. | Technical Support | (866) 912-3220 | technical@archipelagolighting.com