



## COLOR SELECTABLE LED DOWNLIGHT

### WARNING, CAUTION, SAFETY AND INSTALLATION INSTRUCTIONS

#### WARNING

- Installation, service, and maintenance of luminaries should be performed by a qualified licensed electrician.
- Fixture should be installed in accordance with these instructions, current electrical codes, and/or the current National Electric Code (NEC).
- To avoid electrical shock, do not turn on fixture with missing or damaged lens.
- There are no serviceable parts inside of the LED module.

#### CAUTION

- Supply conductors (power wiring) connecting the fixture must be rated for a minimum of 90°C (194°F).
- Do not make or alter any holes in the wiring enclosure or in any of the electrical components.
- Do not alter, relocate, or remove wiring, lamp holders, power supply, or any other electrical component.

#### NOTICE

- The electrical rating of this product is 100-277V AC, 60Hz.
- This product is IC rated.

#### Installation Instructions

1. Turn power OFF from the breaker panel before starting installation.
2. Locate a suitable location for the fixture and trace the outline of the cut-out template on the ceiling. Cut the hole following the outline. If needed, refer to Hole Cut Table for appropriate cut-out sizes.
3. Run electrical wire from the switch (power supply) through the mounting hole.

	8"	6"	4"	3"
<b>Hole Cut Sizes</b>	7 9/23" (185mm) Diameter	5 1/2" (140mm) Diameter	4 21/32" (118mm) Diameter	3 1/8" (75mm) Diameter

#### New Construction and Remodel Installation Driver Wiring (See Figures 1-2)

Make sure power is turned off at the breaker panel before proceeding.

1. Open the hardwire box cover and remove the appropriate knockout(s).
2. Insert the electrical supply cable through the knockout and secure with a cable connector (sold separately).
3. Using wire nuts, connect green ground wire to green wire, white wire to white wire, and black wire to black wire in junction box. (see Figure 1).
4. Use the CCT slider switch on the inside of the driver junction box to set the desired color temperature.
5. Push all wiring and connectors back into the box and close the cover, making sure wires are not pinched.
6. Insert hardwire box through the mounting hold (see Figure 2).

For new construction applications: Secure the junction box to studs, joists, or similar fixed structural units.



# COLOR SELECTABLE LED DOWNLIGHT

## WARNING, CAUTION, SAFETY AND INSTALLATION INSTRUCTIONS

For remodel applications: The junction box is not required to be secured to the plates, studs, joists, or structural units.

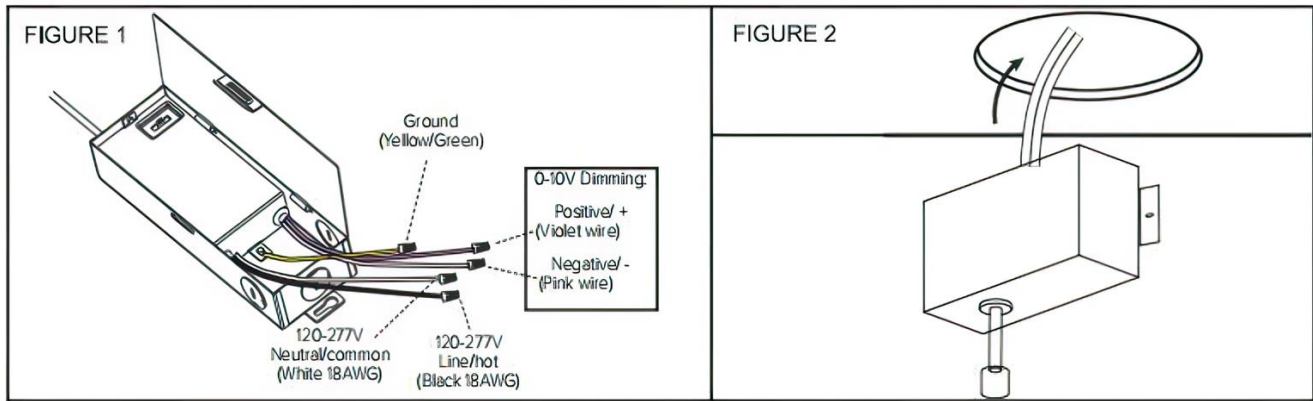

### Fixture Installation (See Figures 3-4)

1. Connect the fixtures to the junction box by inserting and twisting the male/female connectors together (See Figure 3).
2. Push the spring loaded clips on the fixture upwards and insert the fixture base into the mounting hole. Release the clips and the fixture will be pulled flush to the ceiling (See Figure 4).
3. Once assembly is complete, turn on the power.

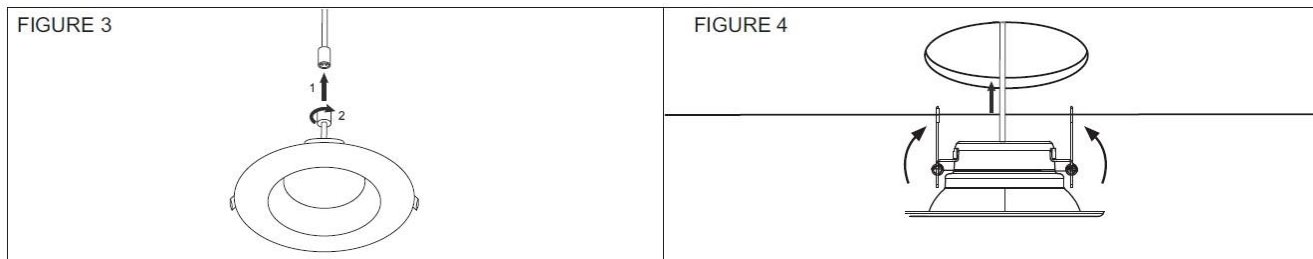

### Care and Maintenance

1. Use only mild soap and water with a soft cloth to clean the fixture. Harsh chemicals will damage the finish. Do not wipe the fixture with a rough cloth as it may scratch the finish or the lens.

### Photometric Distribution Showing Intensity (Candelas)

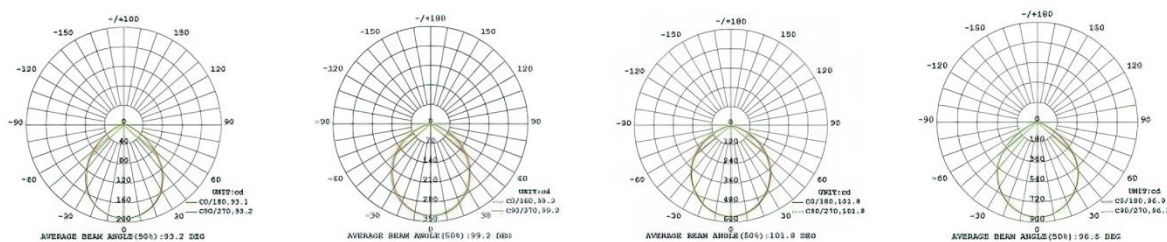



## FCC Compliance Statement

- This device complies with part 15 of the FCC rules. Operation is subject to the following two conditions:
  1. This device may not cause harmful interference, and
  2. This device must accept any interference received, including interference that may cause undesired operation.

## FCC WARNING

- This equipment has been tested and found to comply with the limits for a Class B digital device, pursuant to Part 15 of the FCC Rules. These limits are designed to provide reasonable protection against harmful interference in a residential installation. This equipment generates, uses and can radiate radio frequency energy and, if not installed and used in accordance with the instructions, may cause harmful interference to radio communications. However, there is no guarantee that interference will not occur in a particular installation. If this equipment does cause harmful interference to radio or television reception, which can be determined by turning the equipment off and on, the user is encouraged to try to correct the interference by one or more of the following measures:
  1. Reorient or relocate the receiving antenna.
  2. Increase the separation between the equipment and the receiver.
  3. Connect the equipment into an outlet different from that to which the receiver is connected.
  4. Consult the dealer or an experienced radio/TV technician for help.
- Any changes or modifications not expressly approved by the party responsible for compliance could void the user's authority to operate the equipment.

## **⚠** WARNING

- Before installing, servicing, or performing routine maintenance upon this equipment, follow these general precautions.
- To reduce the risk of death, personal injury, or property damage from fire, electric shock, falling parts, cuts/abrasions, and other hazards, read all warnings and instructions included with and on the fixture box and all fixture labels.
- Proper grounding is required to ensure safety.
- Power must be turned off at the breaker before installation or maintenance.
- This product must be installed in accordance with the applicable installation code by a person familiar with the construction and operation of the product and the hazards involved.
- Wear gloves and eye protection at all times while installing, servicing, or performing maintenance on the luminaire, and avoid direct eye exposure to the light source while it is on.
- To prevent wiring damage or abrasion, do not expose wiring to edges of sheet metal or other sharp objects.
- Do not install damaged product. Inspect luminaire for damage that may have occurred during transit. If damaged, contact the manufacturer immediately.
- These instructions do not purport to cover all details or variations in equipment nor to provide every possible contingency to meet in connection with installation, operation, or maintenance. Should further information be desired or should particular problems arise which are not covered sufficiently for the purchaser's or owner's purposes, contact the manufacturer.

## **⚠** ADVERTENCIA



## COLOR SELECTABLE LED DOWNLIGHT

### WARNING, CAUTION, SAFETY AND INSTALLATION INSTRUCTIONS

- Antes de instalar, reparar o realizar el mantenimiento de rutina de este equipo, siga estas precauciones generales.
- Para reducir el riesgo de muerte, lesiones personales o daños a la propiedad por fuego, descarga eléctrica, caída de piezas, cortes / abrasiones y otros peligros, lea todas las advertencias y instrucciones incluidas con y en la caja del dispositivo y todas las etiquetas del dispositivo.
- Se requiere una conexión a tierra adecuada para garantizar la seguridad.
- Se debe apagar la energía en el disyuntor antes de la instalación o el mantenimiento.
- Este producto debe ser instalado de acuerdo con el código de instalación aplicable por una persona familiarizada con la construcción y operación del producto y los peligros involucrados.
- Utilice guantes y protección para los ojos en todo momento durante la instalación, el servicio o el mantenimiento de la luminaria, y evite la exposición directa de los ojos a la fuente de luz mientras está encendida.
- Para evitar daños o abrasiones en el cableado, no exponga el cableado a bordes de láminas de metal u otros objetos afilados.
- No instale un producto dañado. Inspeccione la luminaria en busca de daños que puedan haber ocurrido durante el tránsito. Si está dañado, comuníquese con el fabricante de inmediato.
- Estas instrucciones no pretenden cubrir todos los detalles o variaciones en el equipo ni proporcionar todas las posibles contingencias a cumplir en relación con la instalación, operación o mantenimiento. Si desea obtener más información o si surgen problemas particulares que no están suficientemente cubiertos para los propósitos del comprador o propietario, comuníquese con el fabricante.