

Installation Instructions

Step1: Loosen 2 screws on both sides.

Step2: Swivel up the housing to 90°, loosen 2 screws by screwdriver.

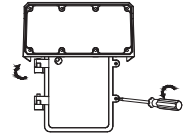
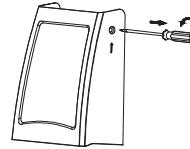

Step3: Take off the fixture towards arrow direction.

Step4: Fix the rear housing on the wall, drill 4 holes at required mounting points, and fix 4 screws (not provided) to the standard junction box on the wall.

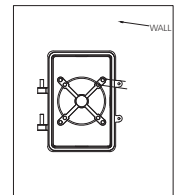
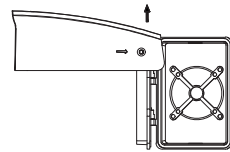

Step5: Slide the top housing into the hinged column on the rear housing.

Step6: Tighten 2 screws (not provided) on the rear housing by screwdriver.

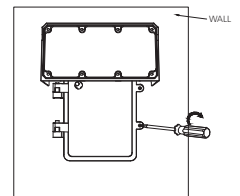
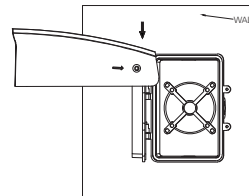

Step7: Loosen 2 screws on both sides, swivel the fixture to your required angle from 0°~90°, then tighten the 2 screws.

Step8: Switch on the power to make sure it works.

