



## Installation Instructions

---

**Step1:** Loosen 2 screws on both sides.

**Step2:**Swivel up the housing to 90°,loosen 2 screws by screwdriver.

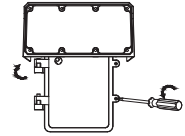
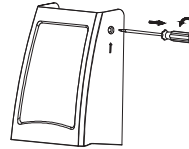

**Step3:**Take off the fixture towards arrow direction.

**Step4:**Fix the rear housing on the wall, drill 4 holes at required mounting points, and fix 4 screws (not provided) to the standard junction box on the wall.

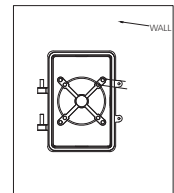
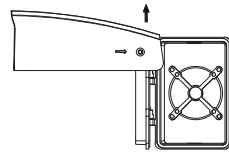

**Step5:**Slide the top housing into the hinged column on the rear housing.

**Step6:**Tighten 2 screws(not provided) on the rear housing by screwdriver.

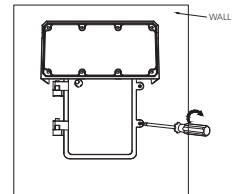
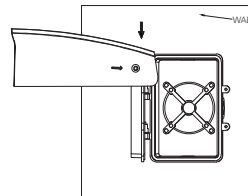

**Step7:**Loosen 2 screws on both sides, swivel the fixture to your required angle from 0°~90°,then tighten the 2 screws.

**Step8:**Switch on the power to make sure it works.

