

## LED SLIM WALL PACK-USER MANUAL

NOTE: Read carefully before installation.

This LED Wall-Pack light uses the latest in solid state lighting technology for long life, low maintenance, and high efficiency. An internal power-factor-corrected switch-mode supply allows it to be used from any nominal 100V-277V, 60Hz AC supply without any variation in light output.

Suitable for use in the following locations:

- Ambient Temp: -40~+45°C(-40~+113°F)
- Wet Locations

WARNING:

- To avoid the risk of fire, explosion, or electric shock, this product should be installed, inspected, and maintained by a qualified electrician only, in accordance with all applicable electrical codes.
- Be certain electrical power is OFF before and during installation and maintenance.
- Luminaire must be connected to a wiring system with an equipment-grounding conductor.

Installation:

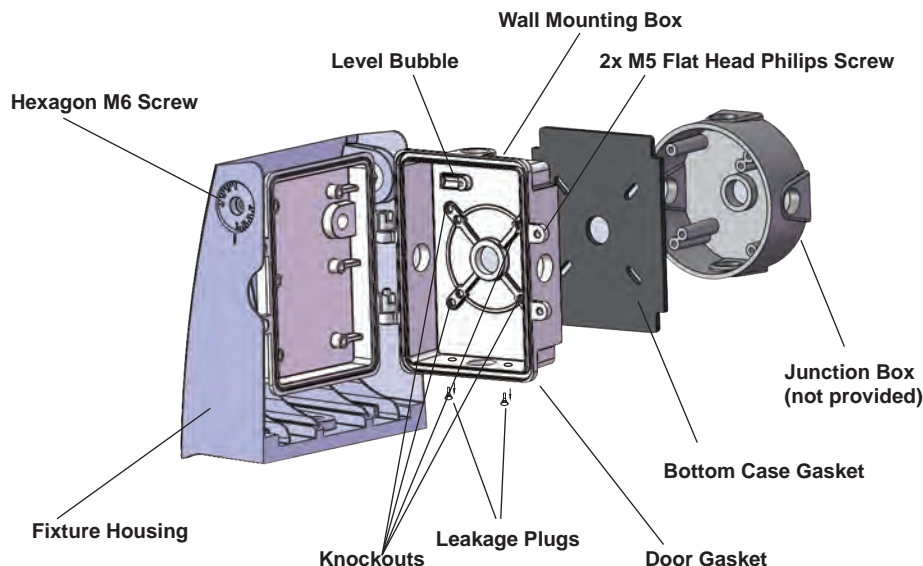
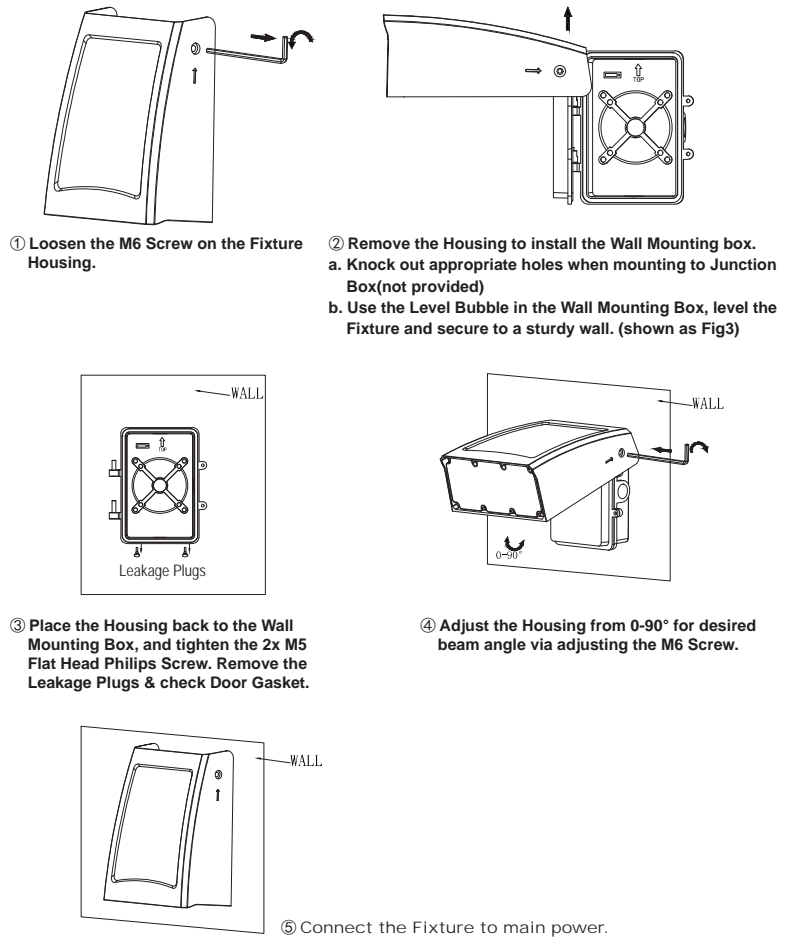

Wiring Diagram:

