

IMPORTANT: READ BEFORE REMOVING FIXTURE FROM CARTON. RETIAN THE MANUAL FOR FUTURE REFERENCE.

SAFETY: This fixture must wired in accordance with the national electrical code and applicable local codes and ordinance. proper grounding is required to insure personal safety. Carefully observe grounding procedure under installation section. All work should be done by a qualified electrician.

- > Risk of electric shock-Disconnect power at fuse or circuit breaker before installing or servicing.
- > Risk of burn-Disconnect power and allow fixture to cool before servicing.
- > Risk of personal injury-Fixture may become damaged and/or unstable if not installed properly.
- > Tighten all fixture components to their recommended torque values.

WARNING: Make certain power is OFF before starting installation or attempting any maintenance.
Contact manufacturer with any questions or concerns regarding installation of this luminaire.

Adjustable Slip Fitter-Suitable for max. tenon size 2 3/8"

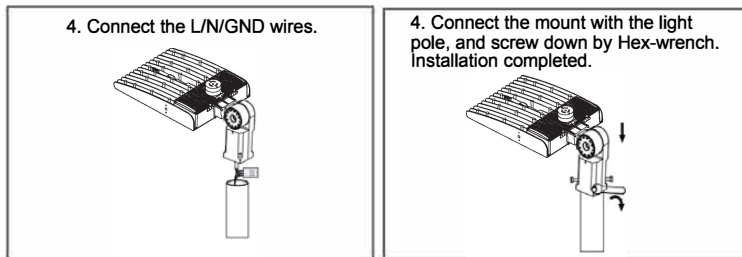
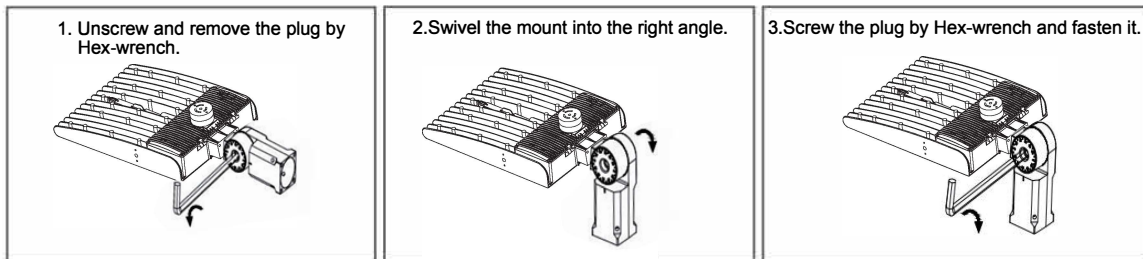

Round Pole Mount-Suitable for 4" to 6" pole and Straight Pole Mount-Suitable for 3" x3" or larger pole

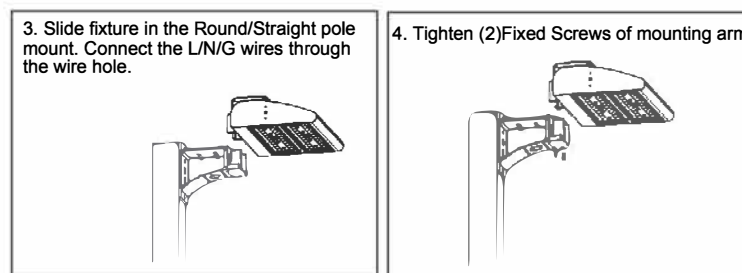
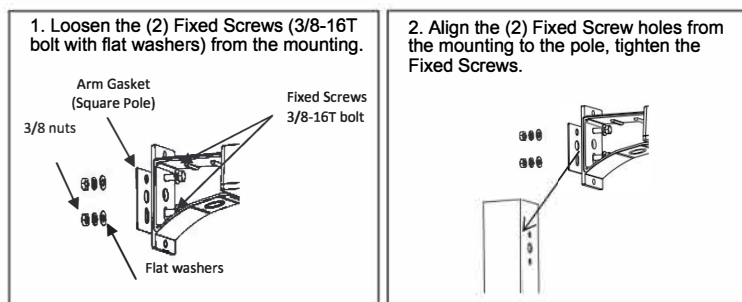

Trunion Installation

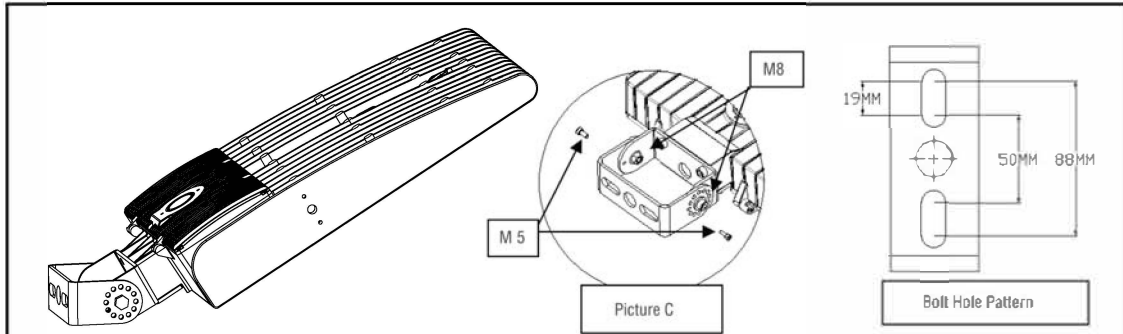

The diagram for Trunion Installation includes three parts: a perspective view of the fixture with a trunion attached, a circular inset labeled 'Picture C' showing a close-up of the trunion being secured with two M8 bolts and two M5 screws, and a 'Bolt Hole Pattern' diagram showing a rectangular layout with a central hole and four corner holes. The dimensions for the bolt hole pattern are 19MM for the distance from the top edge to the top hole, 50MM for the distance between the two central holes, and 88MM for the total width of the fixture.

Step 1: Mount the fixture to suitable flat surface with adequate hardware for that surface;

Step 2: Hold top of fixture, loosen (2) M8 Trunion Bolts and (2) M5 Positioning Screws;

Step 3: Adjust the U Trunion to suitable position;

Step 4: Swivel the fixture until Positioning Screws are in one of the Positioning Holes;

Step 5: Tighten the (2) M8 Trunion Bolts and (2) M5 Positioning Screws (see picture C).

York Bracket Installation

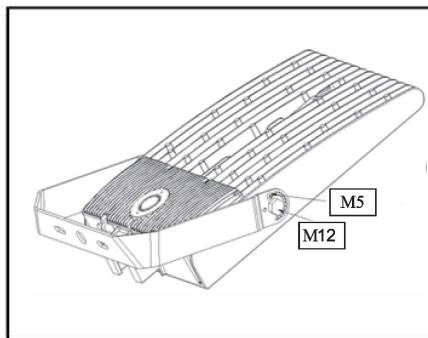

The diagram for York Bracket Installation shows a perspective view of the fixture with a York bracket attached. Two M5 screws are shown securing the bracket to the fixture, and two M12 screws are shown securing the fixture to the bracket.

Step 1: Loosen the (2)M12 and (4)M5 screws;

Step 2: Adjust the fixture to required angle, and tighten (2) M5 positioning screws on one side;

Step 3: Tighten the (2) M12 and the (2) M5 screws on the other side;

Step 4: Connect the L/N/GND wires.

(provided shorting cap)

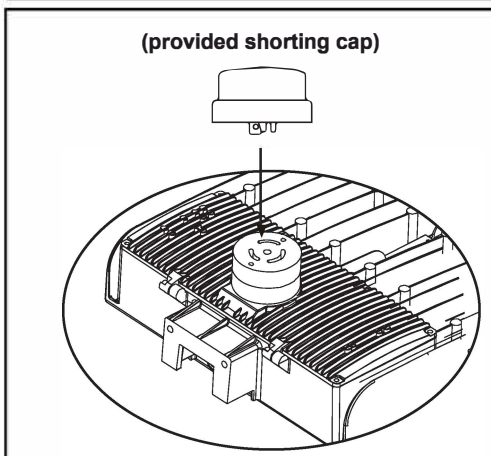

The diagram shows a shorting cap being placed over a three-pin receptacle on the fixture. The cap is shown in a separate view above the fixture, with a line indicating its placement over the pins.

Remarks:

PLT AREA LIGHT UNITS come with receptacles installed on the fixture, end-users can either twist in a 3pin photocell, or the provided shorting cap.