

# LED AREA LIGHTS



## FEATURES

- Well suited light distribution for parking lot and roadway lighting.
- Advanced heat sink design makes fixture light in weight and better at heat dissipation
- Suitable for Wet Locations
- Type V Light Distribution
- IP68 Rated
- UL File Number - E484679



**87% ENERGY EFFICIENCY & LONG LIFE**  
60% MORE ENERGY EFFICIENT THAN STANDARD HID LAMPS  
TYPICAL PAYBACK OF 1 - 3 YEARS

SKU #	Kelvin	Lumens	Wattage	Voltage	CRI	DLC?	Mounting	Life Hours	Warranty
<b>LEDF-10103</b>	<b>4000</b>	<b>9600</b>	<b>75</b>	<b>120-277</b>	<b>70</b>	<b>NO</b>	<b>STRAIGHT</b>	<b>50000</b>	<b>5 years</b>

## ADDITIONAL PHOTOS



## FEATURES

- Longer life span than Metal Halide
- Minimizes Maintenance Checks
- Type V Light Distribution

## TYPICAL APPLICATIONS

- Security Lighting
- Pedestrian Lighting

## WARRANTY

**WARRANTY**      5 Years

## SPECIFICATIONS

### PERFORMANCE

9600 Lumen Output (IES) 75W Power Consumption  
128 lm/W Efficacy (IES) 4000K Color Temperature  
>50000 hrs Lumen Maintenance 120-277 Input Voltage  
0.9 Power Factor  
Effective Projected Areas: 0.207 square feet

### ENVIRONMENTAL

IP68 Rating  
-40°F -113°F Operating Temperature

### PHYSICAL

Dimensions (10.97 in. x 12.4 in. x 2.26 in.)  
Straight Arm Mounting Option  
Housing Die-Casting Aluminum

## PHOTOMETRICS

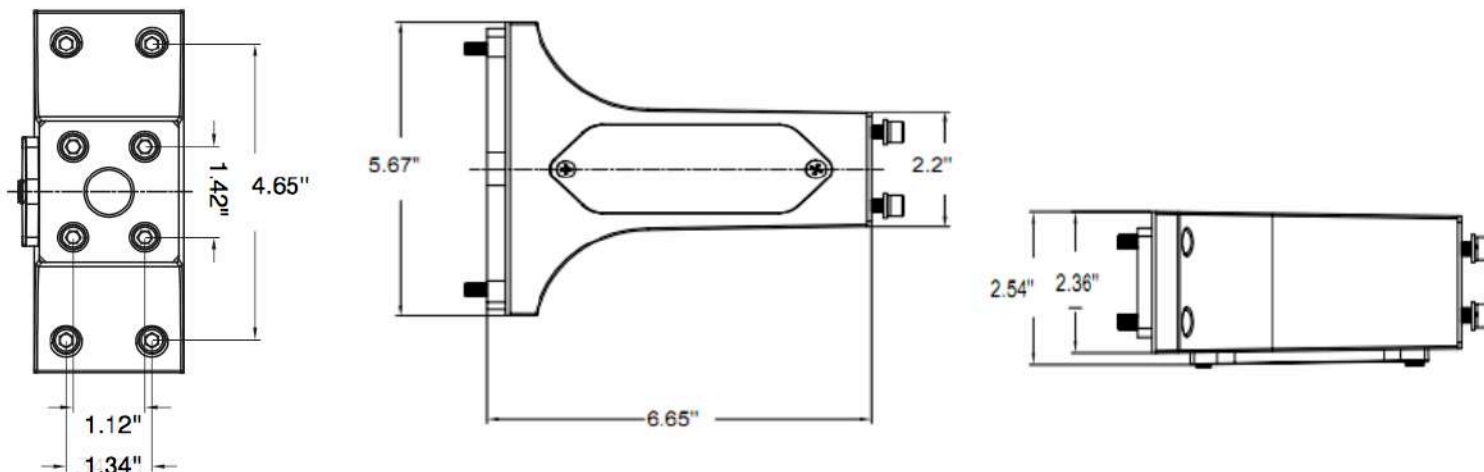

## PHOTOMETRICS

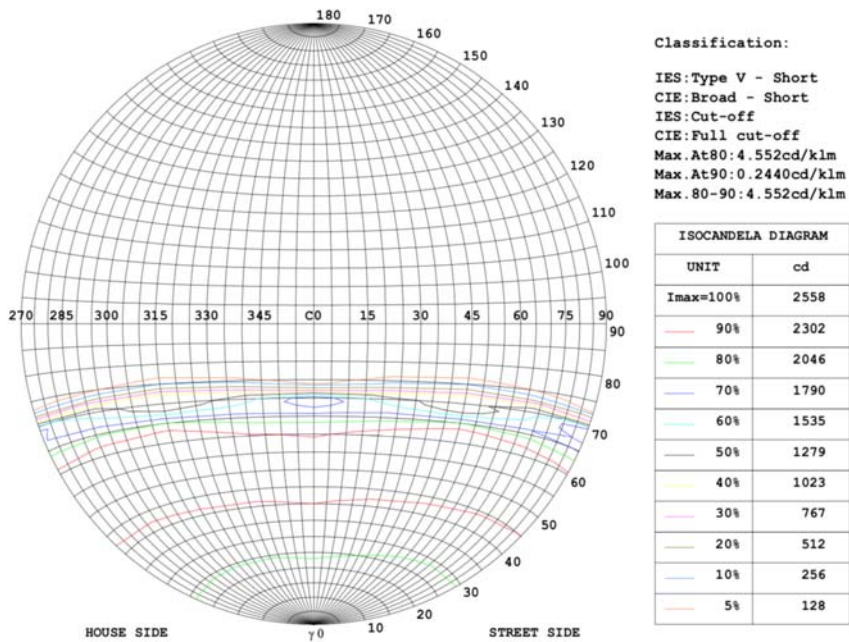
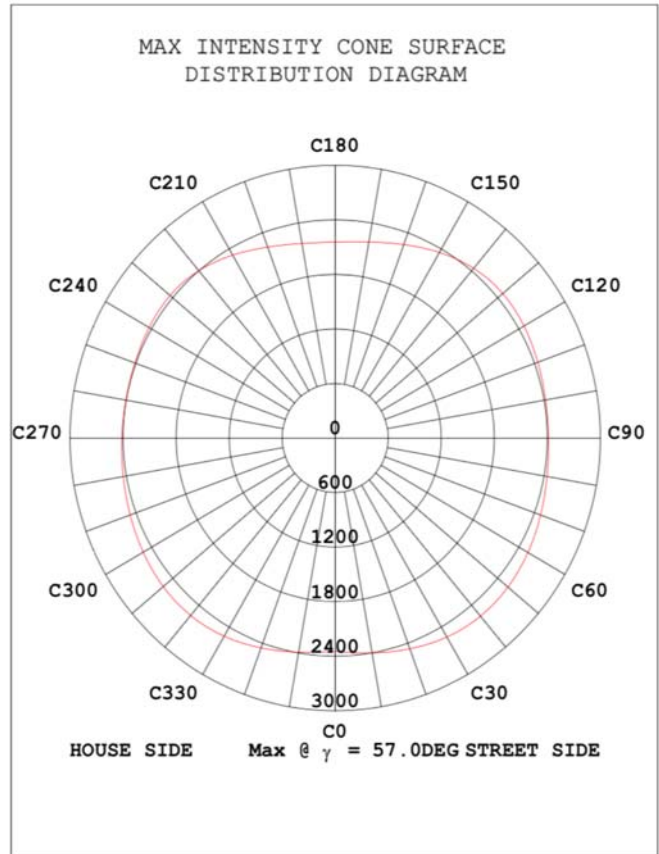
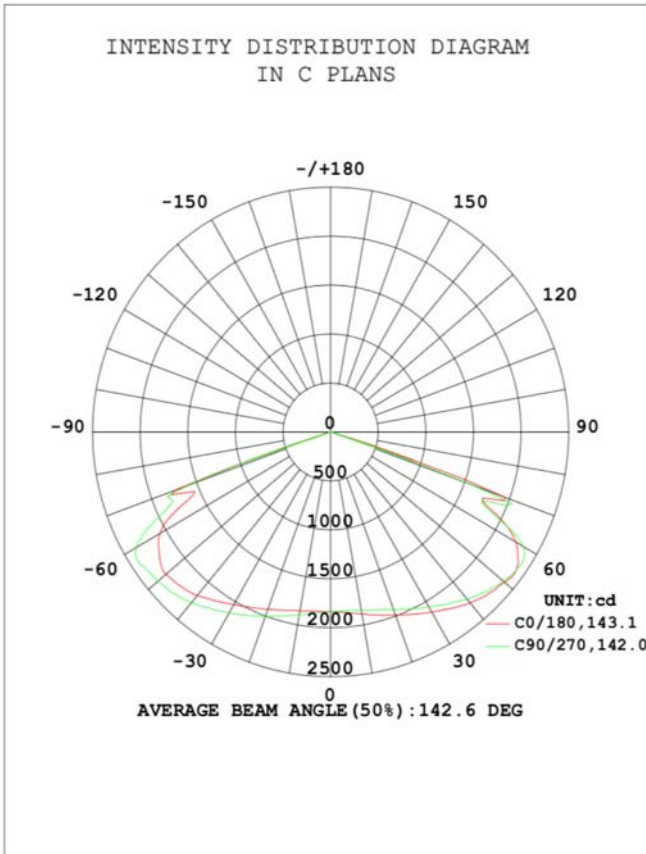

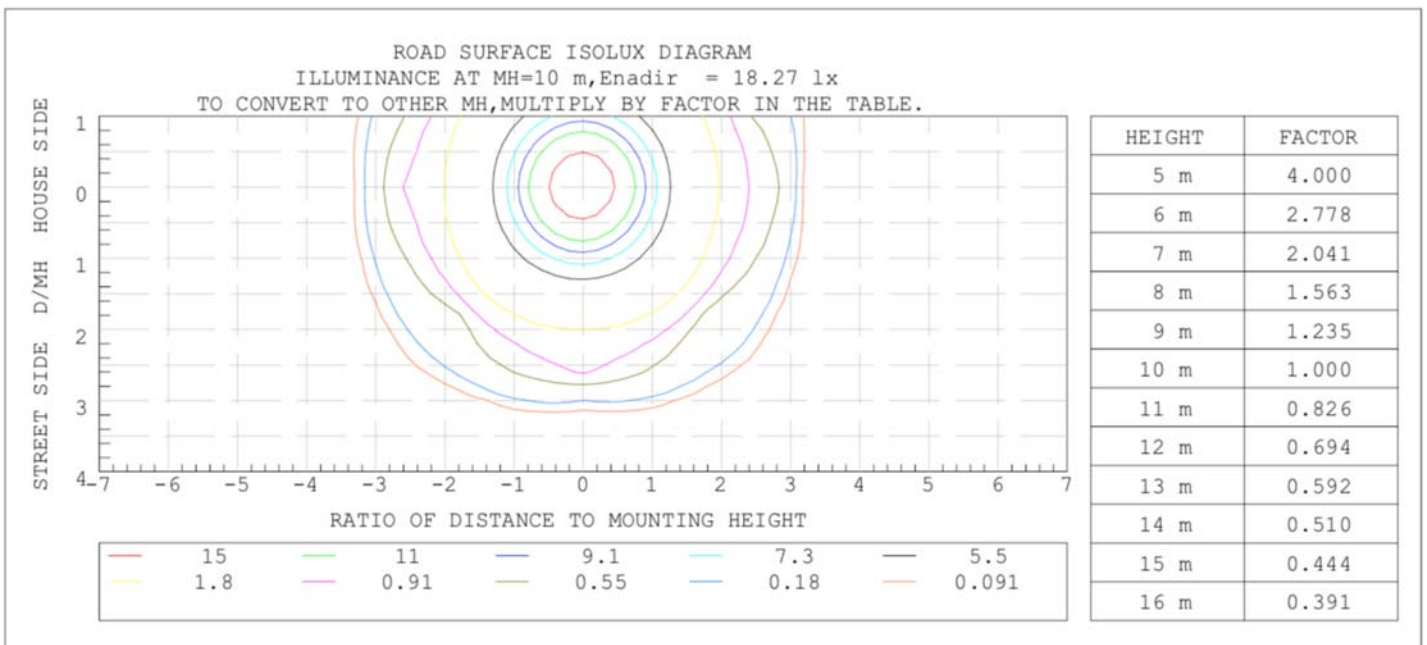
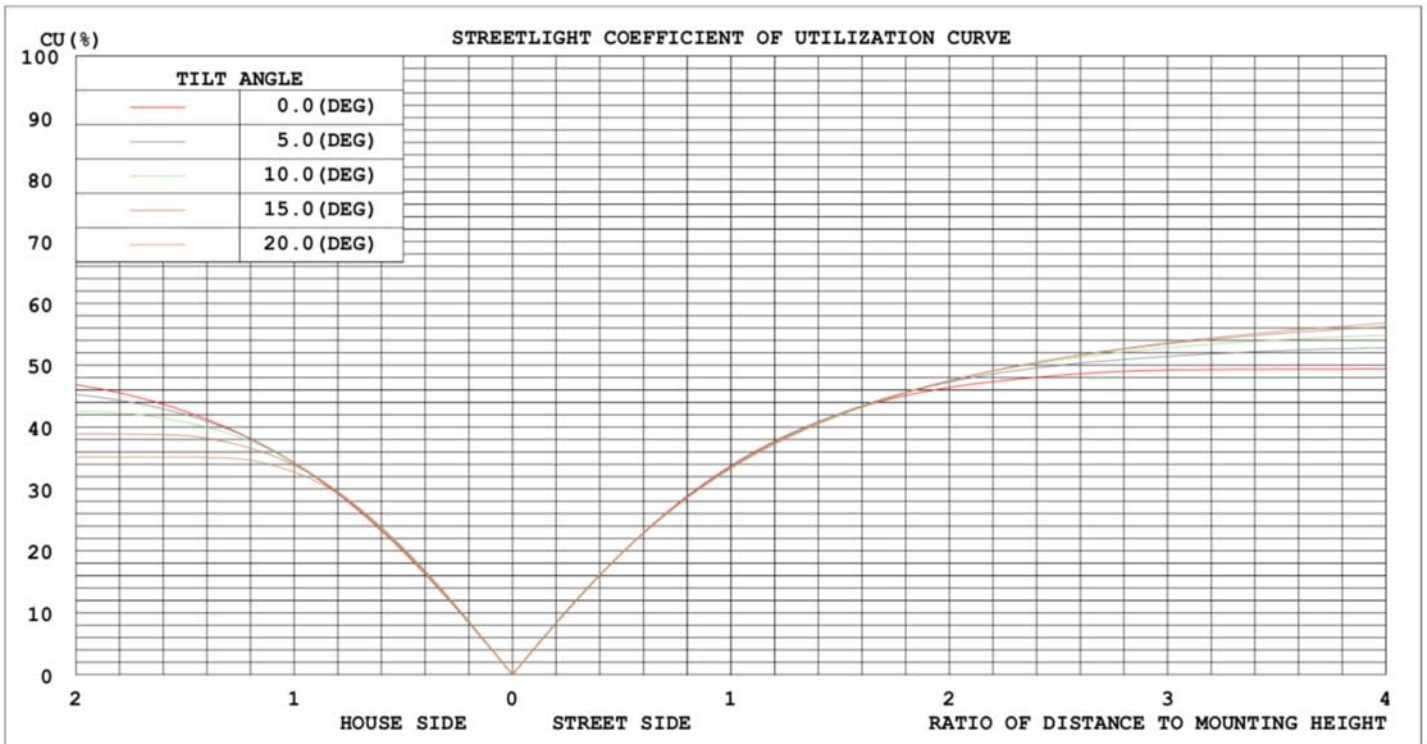



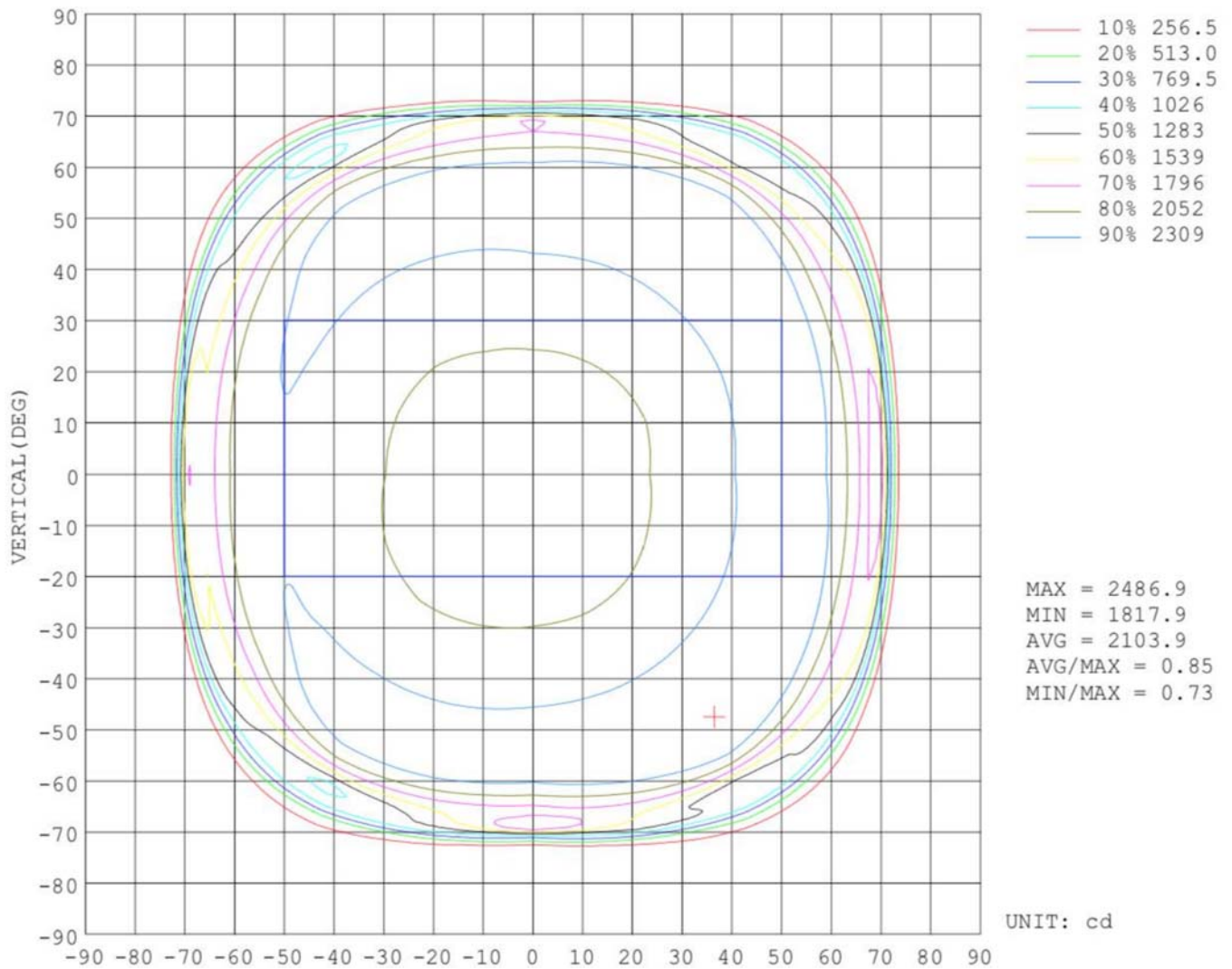

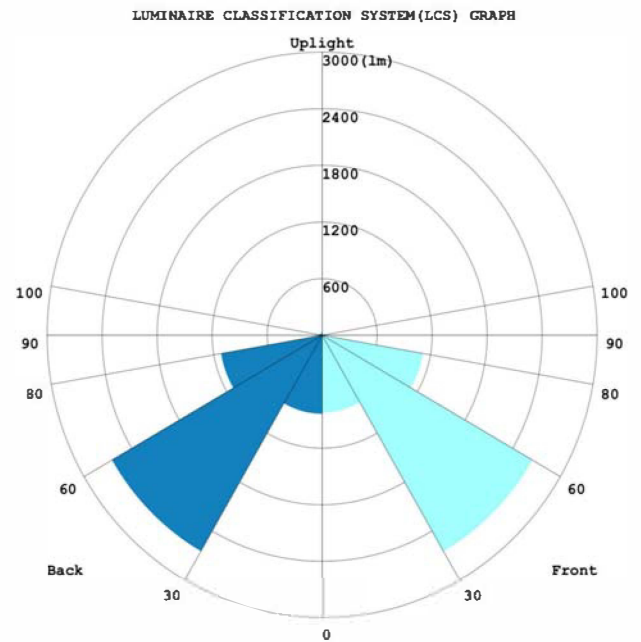
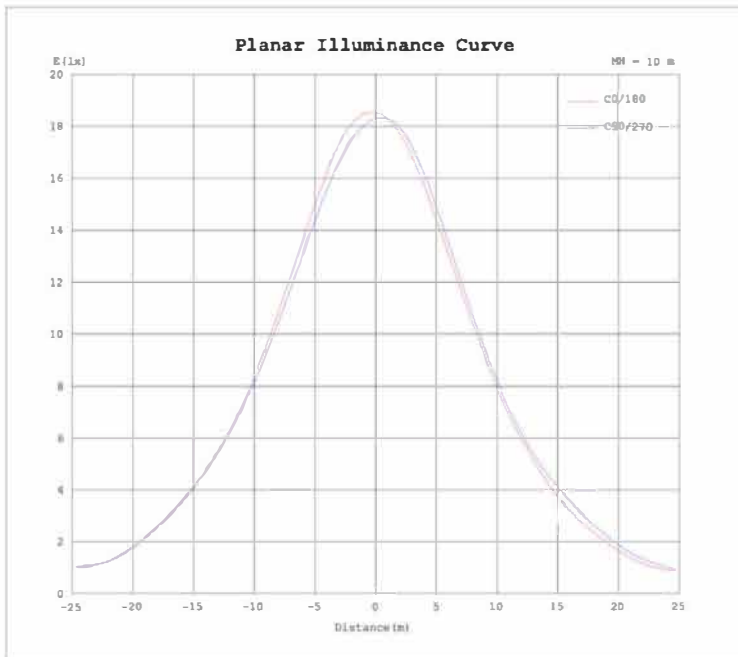

**Improved LED Modules design**

- \*\* No soldering on production line, assembly speed fastened
- \*\* Plug-in pin for LED modules, easy assembly & replace in future
- \*\* Temp of LED Board: 60° C (Ambient Temp=25° C)

**LED Lens**

- \*\* Type III, Type V, 90x120°
- \*\* With small pins on the back side for locating the connection hole on the LED board, to avoid wrong direction assembly.

Waterproof apron for LED modules.

**Extruded aluminum heat sink, coefficient of heat transfer up to 221**

- \*\* Heat dissipation trippled than before
- \*\* Lighter weight
- \*\* LED Modules can directly connected to heat sink, the temp difference between is only 2-3° C
- \*\* Temp for heat sink= 60° C (Ambient Temp=25° C)

**Die-casting aluminum power pack**

- \*\* Reliable structure
- \*\* Better for IP rating
- \*\* Isolates the heat generated from the LED Modules to power supply
- \*\* Simple but reliable way to fix driver, easy to replace in future.

**Patent, Unique slide-in Mount installation**

- \*\* Ideal for inventory
- \*\* Ideal for SKD
- \*\* Easy installation
- \*\* Save labor cost
- \*\* Will not affect light, power & IP rating when changing the mount.

**Clamshell power supply cover**  
Much more convenient for installation, save labor cost.

## STRAIGHT ARM



## Square Pole

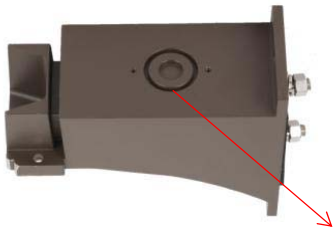

- ◆ Slide-in straight mount option for square pole installation **or directly for wall installation**
- ◆ Min Pole Size: 3"x3"
- ◆ Max Load Weight: 110lbs
- ◆ Reserved for photosensor option

