

## LED MAGNETIC RETROFIT

with for 1' x 4' fluorescent strip fixtures and wraps



Litetronics has simplified the process of converting fluorescent strip fixtures to LED. The 1' x 4' LED Magnetic Retrofit is perfectly suited for upgrading single 4' fixtures, 8' fixtures or continuous row mounting. Both the 1-tube and 2-tube configurations are connectable, offering the ability to daisy chain multiple fixtures in order to cover more ground from one power source. To further support the installation process, each unit is equipped with rare earth magnets at both ends, allowing the installer to magnetically attach the retrofit to the inside of the fixture, leaving them with two free hands for wiring and alignment before securing the final screws.

Each tube configuration generates up to 157 LPW of flicker free, consistent light, which results in a significant reduction in energy use compared to fluorescent fixtures. Another key benefit is a reduction in maintenance. This LED retrofit is rated for a 100,000-hour life (@L70), meaning that you'll see very little degradation over a long period of time and to provide further peace of mind, the it's backed by a 10-year warranty.

### BENEFITS

- Significant reduction in energy use over fluorescent bulbs
- Consistent, flicker free light output over the life of the lamp
- Simple installation process
- Avoid breaking into ceiling plenum
- Ability to daisy chain for continuous row mounting
- Suitable for damp locations
- Compatible with Emergency Battery Backup

### KEY FEATURES

- DLC Premium (157 LPW)
- Rare earth magnets
- 100,000-hour rated life
- 10-year warranty
- Flicker free driver
- Connectability options (direct or via various length cords)
- DLC Premium rating (pending)

### MARKETS

- Schools and universities
- Offices and municipal buildings
- Healthcare facilities and hospitals

### APPLICATIONS

- Grid/drop ceilings
- Fluorescent troffers
- Strip fixtures
- Fluorescent wraps



# LED MAGNETIC RETROFIT ORDERING INFORMATION

## 2-TUBE

WATTS	DESCRIPTION	ORDERING CODE	CCT (K)	RETROFIT LUMENS*	LUMINAIRE LUMENS**
26	1X4 MAGNETIC RF LED 2 TUBES 26W 3500K	RFM262T135	3500	4,080	3,250
26	1X4 MAGNETIC RF LED 2 TUBES 26W 4000K	RFM262T140	4000	4,080	3,250
26	1X4 MAGNETIC RF LED 2 TUBES 26W 5000K	RFM262T150	5000	4,080	3,250

## 1-TUBE

WATTS	DESCRIPTION	ORDERING CODE	CCT (K)	RETROFIT LUMENS*	LUMINAIRE LUMENS**
13	1X4 MAGNETIC RF LED 1 TUBE 13W 4000K	RFM131T140	4000	2,040	1,625

## ACCESSORIES



### CONTINUOUS MOUNTING ACCESSORIES

IMAGE	DESCRIPTION	ORDERING CODE	ACCESSORY USE
A	4'- RETROFIT LAMP TO LAMP EXTENSION-WHITE	RFAC-4FT	Power cable for Retrofits up to 4' apart.
B	8"- RETROFIT LAMP TO LAMP EXTENSION-WHITE	RFAC-8IN	Power cable for Retrofits up to 8" apart
C	RETROFIT DUAL CONNECTOR - WHITE	RFAC	Molded power jumper connects RetroFits end-to-end

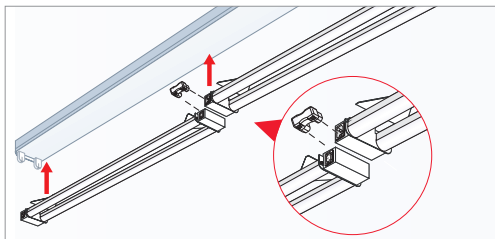

Retrofit power (C) connector shown in operation

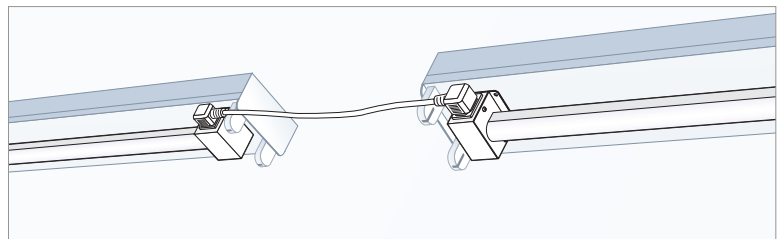

8" Retrofit power (B) connector shown in operation

\* Linear ambient lumens

\*\* Based on Photometric testing consistent with IES LM-79 testing; Lumens will vary based on diffuser and fixture.

## SPECIFICATIONS

**Average rated life:** 100,000 hours @ L70

**Warranty:** 10 years

**Operating temperature:** -5°F to 95°F

**Input voltage:** 120-277V

**Power factor:**  $\geq 0.9$

**CRI:** 82

**UL/cUL listed:** Yes

**RoHS compliant:** Yes

**DLC rating:** Premium

## ACCESSORIES

- Power connectors for continuous row mounting
- Emergency Battery Backup

## SIZING

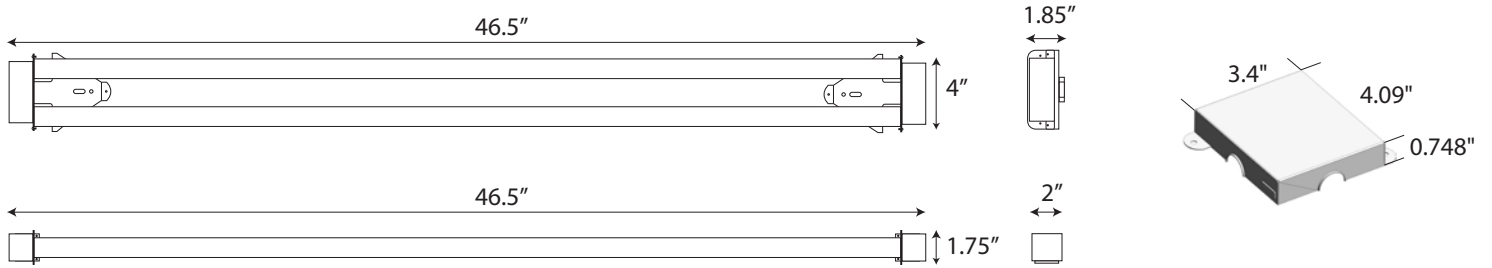

## PRODUCT OVERVIEW

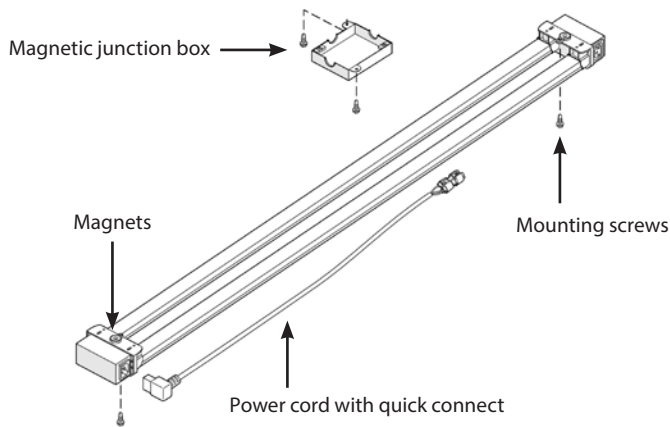

## INSTALLATION PROCESS

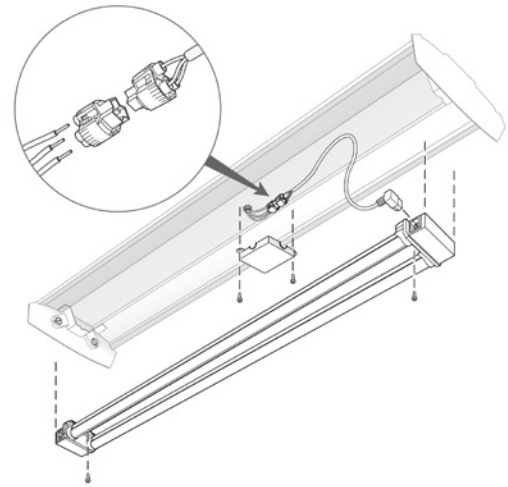

## PRODUCT MOUNTING OPTIONS

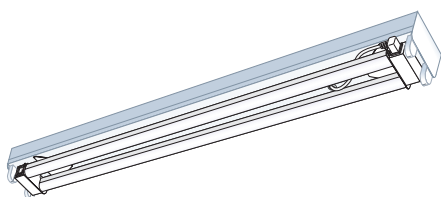

4' or 8' Strip Fixture

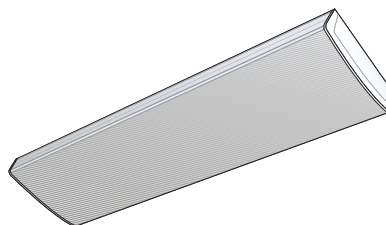

Wrap Fixtures

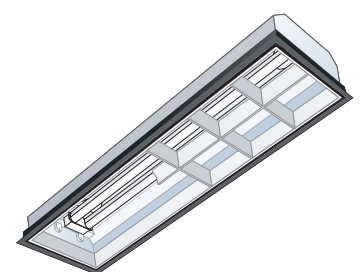

Troffer Fixtures