

Ascend[®] Smart In-Wall Timer

Next Generation 7-Day Programmable Timer (STW700W)



Save Time and Money Every Time You Install Ascend

The new Wi-Fi Ascend Smart In-Wall Timer helps contractors save time on installations while offering homeowners convenient tech-forward features.

Contractor Benefits

- **Save Time** – Save an average of 5 to 15 minutes on every Ascend time switch installation with streamlined smartphone programming options.
- **Wi-Fi Not Required** – Fully set and schedule Ascend with any smartphone or tablet using a secure peer-to-peer communication channel. Wi-Fi is not required for initial setup.
- **Schedule Templates** – Pre-programmed templates fit 80 to 90 percent of timer applications. Schedule Save feature makes it easy to duplicate custom schedules across multiple timers.

Homeowner Benefits

- **Anywhere Access** – Download the Ascend Smart Timer app to any Apple[®] or Android[®] device to update programming schedules on the fly.
- **Voice Control** – Pair the Ascend Smart In-Wall Timer with Amazon Alexa to enable voice-activated commands, including ON/OFF and status check.
- **Standalone Automation** – Get many of the same benefits of a complex home automation system without the hassle - **no hub required**.
- **Longevity** – LCD interface helps new homeowners connect to existing Ascend units, assists when syncing a new smartphone.

Ascend Smart in Light Almond coming soon.

Install in minutes using the Ascend Smart Timer app.

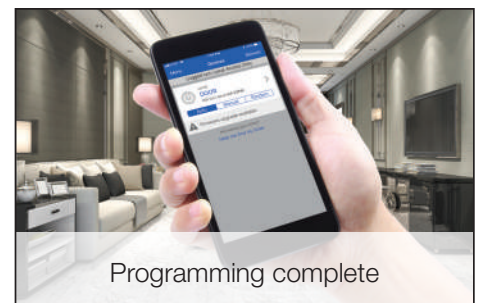
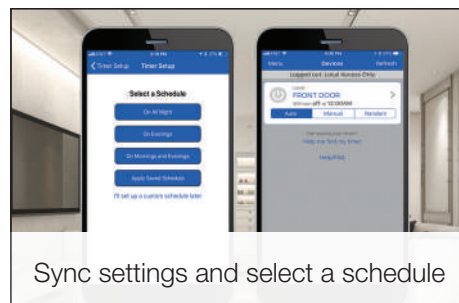

Connecting the Ascend™ Smart In-Wall Timer



4 Options Put Contractors and Homeowners in Control

Getting Started with Ascend

Syncing Ascend with our complimentary mobile app is quick and easy. It helps contractors speed up installations while proving lasting benefits to homeowners. Before pairing a new timer, be sure to complete the following steps:

- Visit Google Play or the App Store and download the Ascend Smart Timer app by Intermatic to any smartphone or tablet.
- Launch mobile app for instruction on initial connection and setup.





Communication Options

- 1. Peer-to-Peer (Access Point):** Used for initial setup, Access Point is a secure link that allows the timer to communicate directly with any smartphone or tablet without having a traditional local area network (Wi-Fi). Contractors will find a timer-specific Access Point network (e.g., "7DT-XXXXXXX") under their mobile device's list of available networks when in close proximity to the timer.
- 2. Wi-Fi Mode:** Primarily used by the homeowner, Wi-Fi Mode connects Ascend to any active local area network (commonly referred to as Wi-Fi). Once synced, it allows users to control the timer through the Ascend Smart Timer app from anywhere within the local area network's reach. Homeowners can quickly see all timers connected to their local area network and switch between timers to make updates.
- 3. Remote Access via Intermatic Connect (Cloud):** Remote Access lets homeowners control their timers from anywhere they have cellular coverage using the Ascend Smart timer app. This provides true mobile access and allows users to update programs and make manual schedule adjustments at any time. Homeowners must create an Intermatic Connect Cloud account (or log in to an existing profile) and register timers to their account to access this feature. Timers are also required to remain in Wi-Fi Mode.
- 4. Voice Control:** Voice Control allows homeowners to control their Ascend Smart In-Wall Timer with Amazon Alexa. Alexa is Amazon's cloud-based voice service, otherwise known as a voice assistant platform. Alexa is the only voice assistant platform Ascend is currently compatible with; however, other platforms will be added in the near future.

Helpful Tips

- › The communication symbols on the Ascend timer can help verify a connection is established and that you're updating the correct device.
- › During initial setup, label timers with user-friendly names, such as "Hallway" or "Porch."

Communication Symbols

-  — Access Point Not Connected
-  — Access Point Connected
-  — Wi-Fi Mode Not Connected
-  — Wi-Fi Connected

