



Item#: **PLT-20017**
LED 2x4 RECESSED DIRECT/INDIRECT
INDOOR FIXTURE

FEATURES

- Indirect lighting reduces shadows and glare
- Use 30% less energy than a linear fluorescent fixture.
- Swing down micro perforated lamp shield for easy re-lamping and for quick maintenance
- LED ready with non-shunted sockets, and standard T-grid ceiling

APPLICATION

Ideal for offices, retail, commercial buildings, classrooms, hospitals and work areas.

ELECTRICAL

Lamp Type (not included)	T8
Number of Lamps	2
Voltage	120-277V

ENVIRONMENT

Operating Temperature	-20°C ~ 50°C
Suitable Location	DAMP
Ingress Protection Rating	IP40

LIFESPAN

Warranty (Years)	2
------------------	----------

CONSTRUCTIONS

Housing	24 Gauge C.R.S.
Reflector	White Aluminum
Base / Power Supply	Hard Wired
Finish	High Gloss Baked White Enamel

CERTIFICATIONS



Operating temperature may vary depending on lamps used.

Item#: **PLT-20017**
LED 2x4 RECESSED DIRECT/INDIRECT

DIMENSIONS (Inches)

Length	48"
Width/Diameter	24"
Height	5.75"
Weight (Lbs)	--

Line drawings may not be to scale and are for general reference only.

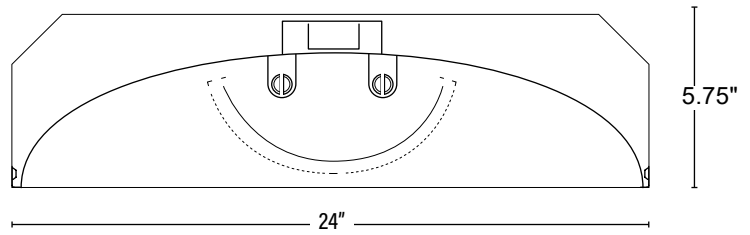

PACKAGING

		UPC	DIMENSIONS (LxWxH)	GROSS WEIGHT (Lbs)
Master Carton	1	811768025248	--	--
Country of Origin	China			
HS Tariff	9405.10.6020			

ORDERING

ITEM#	DESCRIPTION	CASE
PLT-20017	LED 2x4 RECESSED DIRECT/INDIRECT FOR 2 T8	1