

SYLVANIA

SMART⁺ LED

SMART CONNECTED LIGHT

Hardwired
Under Cabinet Light



9"



12"



18"



24"

Product Installation Instructions

TABLE OF CONTENTS

Package/Hardware Contents.....	3
Warnings and Cautions	3
Preparation.....	3
Direct Wire Instructions	4-5
Linking Instructions	6
Operating Instructions	6
Troubleshooting	6
Operating Instructions.....	7
Care/Maintenance	7
Warranty.....	7

PACKAGE/HARDWARE CONTENTS

- (1) Under Cabinet Light **A**
- (1) Paper Template **B**
- (1) Connector Cable **C**
- (1) Strain Relief **D**
- (2) Cord Clips **E**
- (2) Screws **F**
- (3) Wire Ferrules **G**

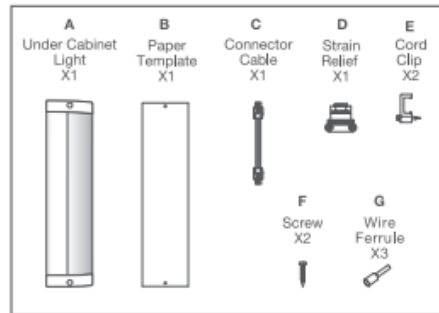

SAFETY INFORMATION

Please read and understand this entire manual before attempting to assemble, operate or install the fixture.

WARNING

Installation or Assembly Instructions. To avoid personal injury and/or possible product damage, the following cautions must be followed:

- To prevent early lamp failure, lamp should only be installed in operating environments ranging between 0°C and +40°C (+32°F and +104°F).
- Not for use in totally-enclosed cabinets.
- This fixture is not intended for use in emergency light fixtures or exit signs.
- Suitable for damp locations
- Lamp dims via wireless control and will not operate with a dimmer switch, remove all existing dimmers and replace with a regular switch, leave lamp in ON position.

CAUTION

- To prevent electrical shock, turn power off before inspection, installation or removal.

PREPARATION

Before beginning installation of the fixture, make sure all parts are present. Compare parts with the package contents list and hardware contents list. If any part is missing or damaged, do not attempt to install the fixture.

This fixture is controlled by a Smart Phone or Tablet App. If you are unfamiliar with electrical installations, it is recommended you have a qualified electrician do your installation.

Estimated Assembly Time: 30 minutes

Tools Required for Assembly (not included):

Safety Glasses, Tape Measure, Screwdriver (Phillips and Flathead), 0.08 inch Drill Bit, Drill, Ladder, pliers.

- Consult a local licensed electrician or electrical contractor if you are not sure about the installation.
- Select a suitable dry mounting location (for use indoors only). Make sure mounting surface is capable of supporting the fixture.
- (When applicable in selected models that come with power cord **C**, make certain that your 5ft. power cord will reach the nearest electrical outlet).

DIRECT WIRE INSTALLATION

WARNING

Make sure the POWER is OFF.
SHOCK HAZARD

Do not plug your power cord **C** into the fixture **A** for direct wire installation.

1. Position the paper template where fixture **A** is intended to be mounted. Create marks of the screw holes on the mounting surface with a pencil (not included) (Do not install the wood screws immediately).

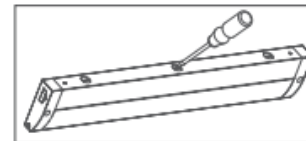

Then use a screwdriver to remove the knock-out at the side of the fixture **A**. CAREFULLY REMOVE THE KNOCK-OUT USING A FLATHEAD SCREWDRIVER (not included) to make it snap off.

2. Unscrew the screw on one end cap of the fixture **A**, then remove the end cap and open the driver cover of the fixture.

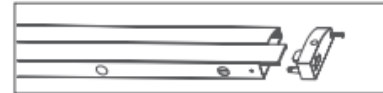

3. Attach the strain relief **D** by inserting the threaded end (from outside the fixture **A**) through the knock-out. Secure the strain relief to the fixture **A** by tightening the fastener (from inside the fixture **A**).

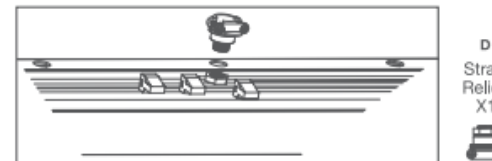

4. Insert the cable through the strain relief **D** and tighten the clamp until it is secure. Allow enough wire length to make the connection.

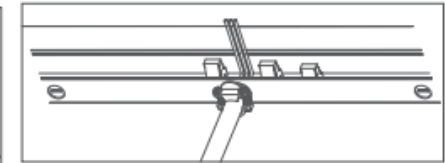
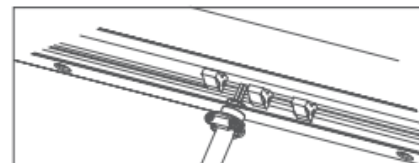

5. There are three lead wires in outside cable: neutral wire, live wire and ground wire. Install the wire ferrule **G** on three lead wires and tighten the wire ferrule **G** with pliers.

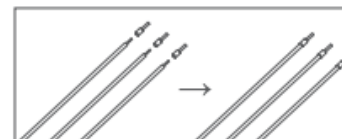

DIRECT WIRE INSTALLATION (CONTINUED)

Connect Terminal X3

6. There are three wire connect terminals **D** connected with neutral wire, live wire and ground wire from driver. After installing the terminals, connect the outside cable to the left available hole on the wire connect terminal. Connect the ground wire to the wire connector's ground wire (in green). Connect the live wire to the wire connector's live wire (in black). Connect the neutral wire to the wire connector's neutral wire (in white).

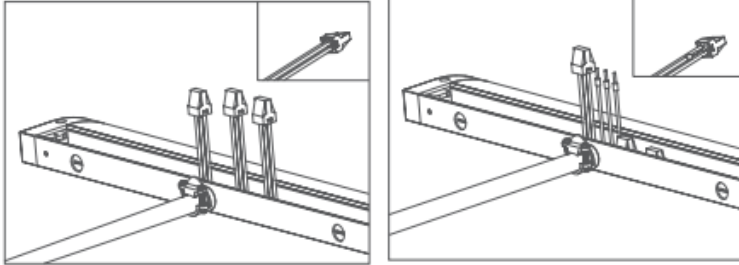

7. Put the wire connector terminal back into the fixture **A** after connecting.

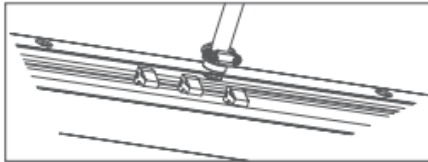

8. Assemble the driver cover back and tighten the screw of the end cap.



9. Position the fixture **A** where it marks the location of the screw holes. Fix the fixture **A** with a screw **F** in the cabinet, and tighten the screw with a screwdriver (not included).

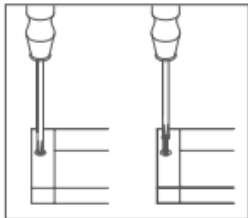

10. Install one wood screw **F** on the other side of the fixture **A**.

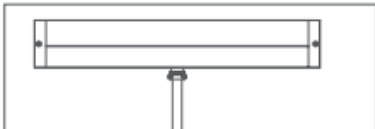

PLUGIN INSTALLATION

1. Position the paper template where fixture **A** is intended to be mounted. Create marks of the screw holes on the mounting surface with a pencil (not included).



2. Drive one wood screw **F** 0.24 inches deep into the same side of the surface of the cabinet.

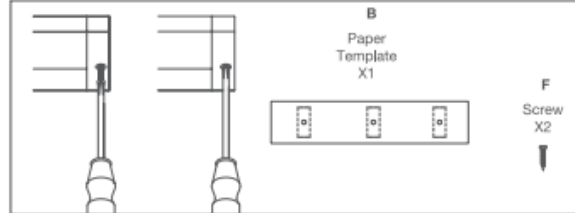

3. Align one end of the fixture **A** with the screw **F**. When the screw is snug inside the screw holes, tighten the screw with a screwdriver (not included).
4. Install one more wood screw **F** on the other end of the fixture **A**.
5. Do not plug the power cord into the 120V/60Hz electrical outlet before finishing the installation. The power cord plug will be fully inserted once the catch on the plug is engaged.

LINKING INSTRUCTIONS

⚠ WARNING

Make sure the POWER is OFF before connecting any additional fixtures (sold separately)

- Install additional fixtures following steps 1-4 of the PLUGIN INSTALLATION. Make sure that the additional fixture is no more than 12 inches away from the original fixture.

1. Using a screwdriver or other similar tool, pry off the protective end cap covering the fixture **A** in order to insert the connector cable **C**

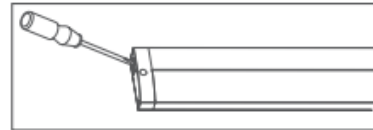

2. Use the connector cable to connect more fixtures. Use cord clips **E** to secure and reduce stress on the connector cable **C**. Make sure the protective end cap is plugged in on the far end of the last linked fixture **A**. Plug in power cord back into 120V/60Hz electrical outlet.



OPERATING INSTRUCTIONS

Please reference the SMART® Quick Install Guide for instructions on pairing the fixture.

TROUBLESHOOTING

PROBLEM	POSSIBLE CAUSE	CORRECTIVE ACTION
Fixture doesn't light	1. Power is off 2. Bad plug connection	1. Check if power supply is on 2. Check wiring
Fuse blows or circuit breaker trips when light is turned on.	Discontinue use	1. Call Customer Service.

• Call 1-800-LIGHTBULB for additional troubleshooting information

CARE AND MAINTENANCE

Periodically clean the fixture using a mild, non-abrasive glass cleaner and soft cloth. Do not use solvents or cleaners containing abrasive agents. When cleaning the fixture, make sure you have the power turned off and do not spray liquid cleaner directly onto the LEDs, fixture, diffuser or wiring.

WARRANTY

Limited Warranty. Manufacturer warrants this fixture to be free from defects in material or workmanship for 2 years from purchase date, when used as directed. This warranty does not cover accidents, abuse, acts of God, use in violation of law or electrical standards, or connecting the fixture with an alternative power supply or using the fixture cord to connect any other fixtures. Manufacturer may examine the fixture to determine if fixture is defective. If fixture is defective, Manufacturer will replace it with the same or similar fixture at no charge. LABOR IS NOT INCLUDED. Fixture should be returned with proof of purchase date to the location where purchased. For other information, contact customer service at 1-866-994-4148, 8 a.m.-6p.m., EST, Monday-Thursday, 8 a.m.-5p.m., EST, Friday. THIS IS THE EXCLUSIVE REMEDY AVAILABLE. LIABILITY FOR INCIDENTAL OR CONSEQUENTIAL DAMAGES IS EXPRESSLY EXCLUDED. SOME STATES AND JURISDICTIONS DO NOT ALLOW THESE EXCLUSIONS, SO THE ABOVE LIMITATIONS AND EXCLUSIONS MAY NOT APPLY. THIS WARRANTY GIVES YOU SPECIFIC LEGAL RIGHTS, AND YOU MAY ALSO HAVE OTHER RIGHTS WHICH VARY FROM STATE TO STATE OR PROVINCE.

SYLVANIA

E22305

Contains:
FCC ID: DZO-LDV-AET-HER
IC: 11099A-LDVAETHER