

LED DLC4S-1050e

5000K
CCT

Part #: EFDLC4DM/1/9W/750/120D/50K/JB/E Fixture Class: 4" Slim Fixed

Product Description

LED DLC4S-1050e, recessed downlight, replaces conventional 60 Watt incandescent bulbs delivering more brightness (lumens) for less energy (Watts). Its slim body design allows compatibility with 4" cans, as well as, reduction of internal bulb heat providing greater durability and constant fixture performance. Enjoy features such as: instant on, dimming options, shatter resistance, and mercury free.



Estimated Energy Cost: \$1.08 per year



Caution

- Do not install if the power is on.
- This product must be fully installed before the power is turned on.
- Failure to fully install this product might result in an electrical hazard.

Specifications

Input Power	Input Voltage	Lumen Output	Beam Angle	Center Beam	CCT
9 W	120V/60Hz	750 lm	120°	278 cd	5000 K
CRI	Luminous Efficacy	Power Factor	Input Current	Base	Lamp Lifespan
80	83 lm/W	0.9	0.08 A	Junction Box	30,000 Hrs.

Product Features

- Dimmable
- Instant-On/Off
- Mercury Free
- Wet Rated

Product Dimensions

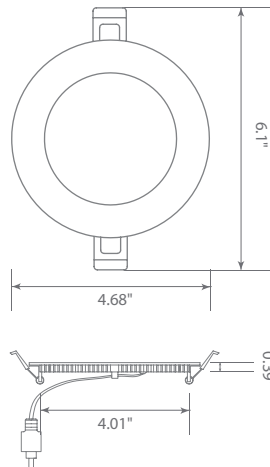

Product Photometric Data

