

8" CDL 27W TITANIUM LED SERIES



PRO



- ⌚ For retrofit or new construction installation
- ⌚ Universal housing compatibility
- ⌚ Adjustable lumen output – 3 defined light levels
- ⌚ Easy fit installation – Spring-action housing clips
- ⌚ Universal voltage 120-277V
- ⌚ Available in 2700K, 3000K, 3500K & 4000K CCT

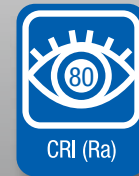

COMMERCIAL DOWNLIGHT PRODUCT FEATURES

Adjustable Lumen Output



Fluorescent Equivalence Table		
Power	Lumens	Equivalent
LOW-12W	1000	1X26W / 2X13W
MED-19W	1500	1X32W / 2X18W
HIGH-27W	2000	1X42W / 2X26W

This commercial downlight features adjustable lumen output for three distinct lumen levels equivalent to various CFL lamp combinations. Simply adjust the lamp power to the desired lumen output by sliding the selector switch on top of the fixture.

Easy-Fit Installation

The adjustable housing clips allow for installation in a large range of commercial and architectural housings ranging from 7.6" - 9.4" (195-240mm). These spring-action clips push up easily and fit securely for both retrofit and new construction installations.

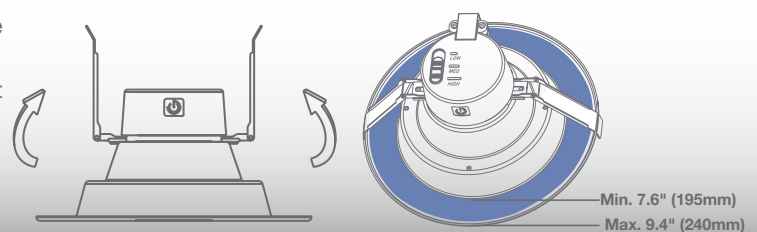

SIMPLE RETROFIT OR ECONOMICAL NEW CONSTRUCTION INSTALLATION

Retrofit Installation



Attach safety clip

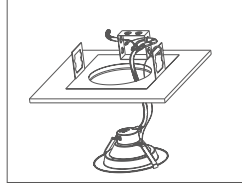

Bypass ballast & wire to j-box

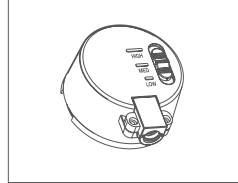

Adjust lumens to desired output

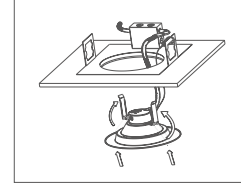

Push clips up & install into fixture

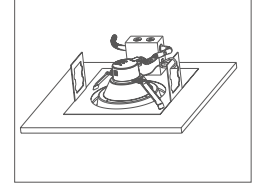

Ensure fixture is flush. Installation is complete

New Construction Installation

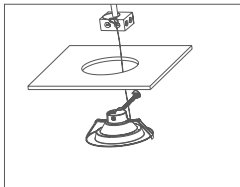

Attach safety clip

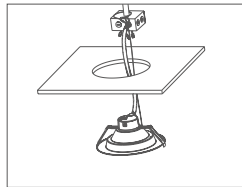

Wire to j-box

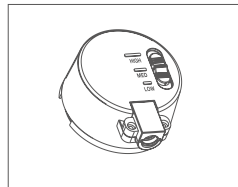

Adjust lumens to desired output

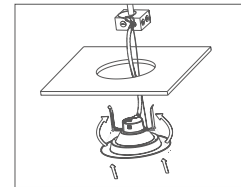

Push clips up & install into opening

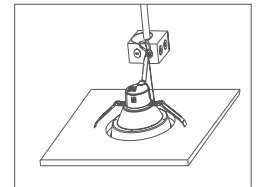

Ensure fixture is flush. Installation is complete

SPECIFICATIONS

Product Model	57873 27CDLA8/827/277V	57874 27CDLA8/830/277V	57875 27CDLA8/835/277V	57876 27CDLA8/840/277V
Type	8" Commercial Downlight	8" Commercial Downlight	8" Commercial Downlight	8" Commercial Downlight
Power (W)	12 / 19 / 27	12 / 19 / 27	12 / 19 / 27	12 / 19 / 27
Voltage - Frequency	120-277V 50-60Hz	120-277V 50-60Hz	120-277V 50-60Hz	120-277V 50-60Hz
Color Temp. (ANSI)	Soft White 2700K	Warm White 3000K	Neutral White 3500K	Cool White 4000K
CRI (Ra) (typ.)	80	80	80	80
Typical lumens (lm)	930 / 1400 / 1860	1000 / 1500 / 2000	1000 / 1500 / 2000	1000 / 1500 / 2000
Efficacy (LPW)	78 / 74 / 69	83 / 79 / 74	83 / 79 / 74	83 / 79 / 74
Beam Angle	110°	110°	110°	110°
Dimmable	No	No	No	No
Power Factor	0.9	0.9	0.9	0.9
Rated Lifetime - L70 (hrs.)	40,000	40,000	40,000	40,000
Dia. x MOL	10.24"x4.2"	10.24"x4.2"	10.24"x4.2"	10.24"x4.2"
Weight (lb. / g)	1.58 lb. / 717g	1.58 lb. / 717g	1.58 lb. / 717g	1.58 lb. / 717g

* Suitable for damp locations. Not for use where directly exposed to weather or water

** Full installation guide and more details available on website