



# 120V Flexible LED Neon Rope Light

---

INSTALLATION INSTRUCTIONS



# 120V Flexible LED Neon Rope Light

## INSTALLATION INSTRUCTIONS



### CUTTING AND CONNECTING Flexible LED Neon Rope Light (SEE FIGURES 1-5)

NOTE: Reels include one pre-attached power adapter cord with 4 additional power adapter cords.

1. Ensure the attached power adapter cord is fully secure by tightening threaded collar at connection. See Figure 1.
2. Determine the required length for the lighting application.
3. Cut the Flexible LED Neon Rope Light squarely at the nearest cut mark using a PVC pipe cutting tool or sharp shears. Cut marks are located every 18" and marked on the side of the housing. See Figure 1.
4. If using a new reel with the power cord attached, skip to steps 10 and 11. If using a previously cut length of Flexible LED Neon Rope Light, you'll need to add a DIY power connection kit (steps 4-9).
5. Trim off any wires that protrude from the cut end of the Flexible LED Neon Rope Light.
6. Holding the non-pointed side of the power pin with a pair of pliers, line up the pointed pins on the other end with the four conductors inside the Flexible LED Neon Rope Light. See Figure 2.
7. Push the pointed pins into the Flexible LED Neon Rope Light until flush, being sure to make solid contact with the flexible light's internal wires.
8. Slide the shrink tube over the power pins, onto the Flexible LED Neon Rope Light. See Figure 3.
9. Push the power cord sheath onto the assembly until fully seated. See Figure 4.
10. Use heat to affix the heat shrink tube making sure that it is centered over the junction of the Flexible LED Neon Rope Light and the power cord sheath.
11. When using splice kits and/or jumpers, follow steps 4-9 above, making connections in a similar manner.
12. Attach end cap to other end of flexible light to cover exposed dead end.

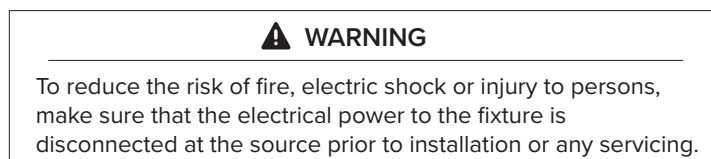
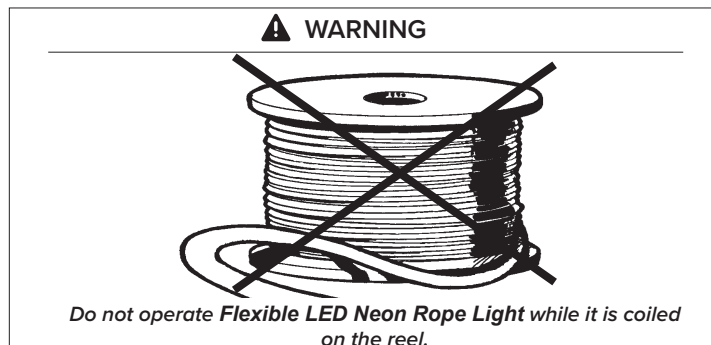
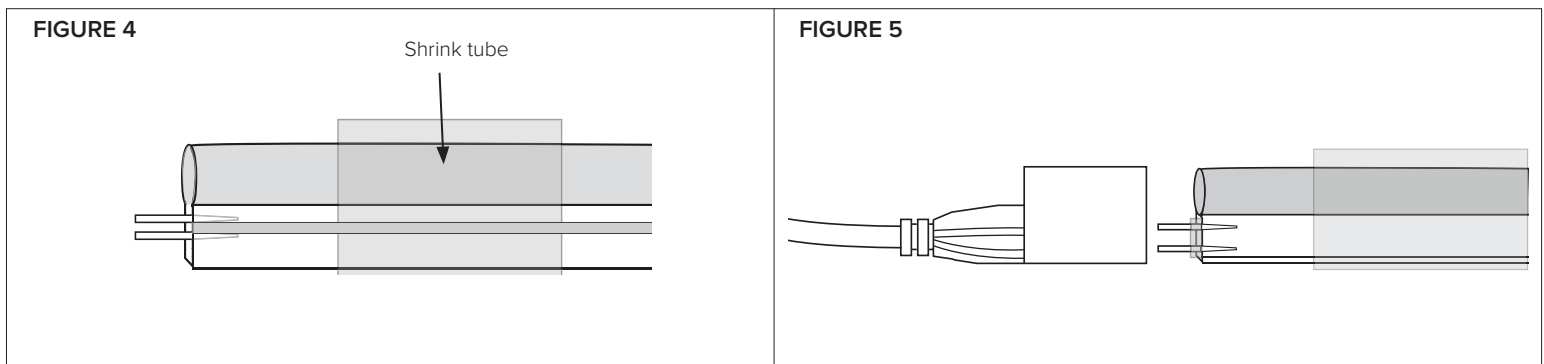
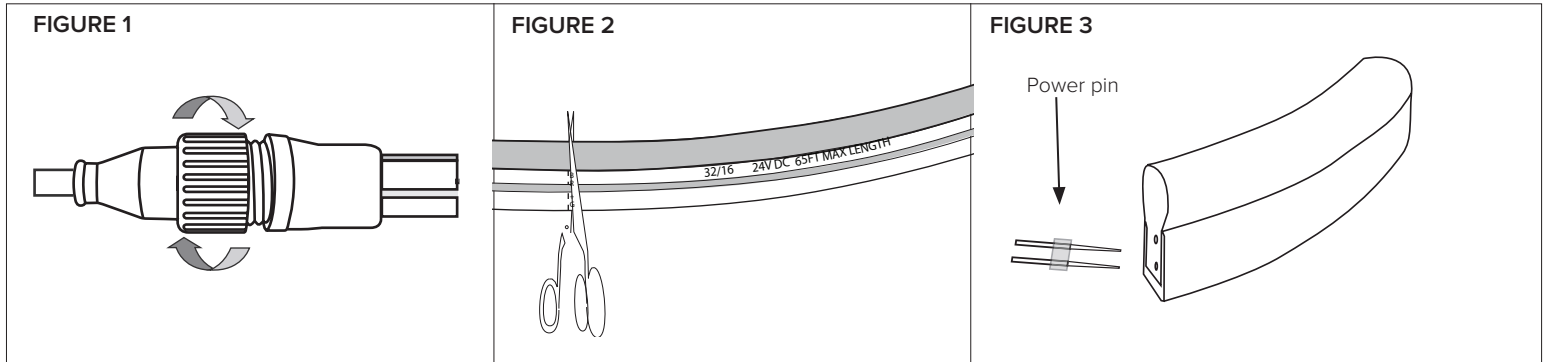

# 120V Flexible LED Neon Rope Light

## INSTALLATION INSTRUCTIONS



### MOUNTING

Note: Flexible LED Neon Rope Light share the same track, channel and end caps.

1. Make mounting clips using cut pieces of track or order clips (10 per pack, sold separately) for curves and Shapes on a flat mounting surface; or for straight line applications, use 3ft length (sold separately) mounting tracks; 3ft aluminum channel is also available (sold separately).
2. Make sure that the distance between any two parallel runs of lighting is at least 1/2" apart.
3. Gently press flexible light into track, channel and/or clips so that it snaps into place.

### TO REPLACE FUSE (SEE FIGURE 6):

This plug contains an electrical fuse as a safety feature.

1. Disconnect power before replacing the fuse.
2. Grasp plug and remove from the receptacle or other outlet device.
3. Do not unplug by pulling on the cord.
4. Slide open the fuse access cover (See figure 5).
5. Remove old fuse carefully.
6. Never attempt to replace the fuse with a higher wattage fuse. Use only 8Amp 125Volt fuse. Failure to do so may be a fire hazard. (One spare fuse is included; stored inside plug for convenience)
7. Set new fuse in holder and close fuse access cover.

FIGURE 6

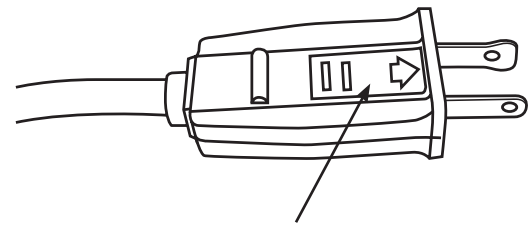

Fuse is inside plug.  
Slide open fuse access cover as shown.

**DO NOT TWIST, HANG VERTICALLY, SUSPEND UNSUPPORTED IN THE MIDDLE, BEND UPWARDS (ARCH) OR DOWNWARDS (DIP).  
MAXIMUM BEND RADIUS FOR SIDE-TO-SIDE BENDS IS SHOWN BELOW.**

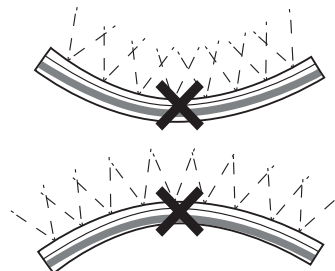
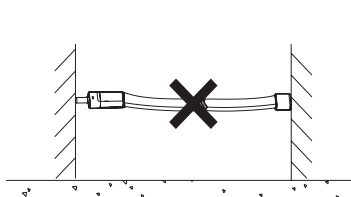
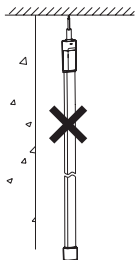

MAXIMUM BEND  
RADIUS = 50mm

