

NEW

Pico® Wireless Control

Adjust lights and shades from anywhere in the room



On the wall



On the table



In your hand

- **Add a new control wherever you want it**
 - On any wall surface
 - On a tabletop or desk
 - In your car, purse, or pocket
- **Easy to install**
 - No need to cut holes or pull new wires
 - Battery operated – requires no external power or wiring (10-year battery life)
- **Ultra-reliable operation**
 - Lutron patented **Clear Connect®** RF technology
 - Wireless signal works around corners and through walls
 - Compatible with all Lutron wireless systems

Typical applications include:

Residential

- Bedroom
- Living room
- Car

Commercial

- Hotel guestroom
- Conference room
- Private

Lutron

Add a new control wherever you want it



On the wall

Add a new control without cutting or wiring. You can install the Pico directly on any wall surface in minutes.



On a table

Mount the Pico to a pedestal and you have a simple and elegant tabletop control.



In your hand

Use the Pico as handheld remote, and adjust the lights or shades.



In your car

Clip a Pico to your car's visor and turn on the lights as you pull into the driveway. You'll never have to walk into a dark home again.

Product information

Button Functions

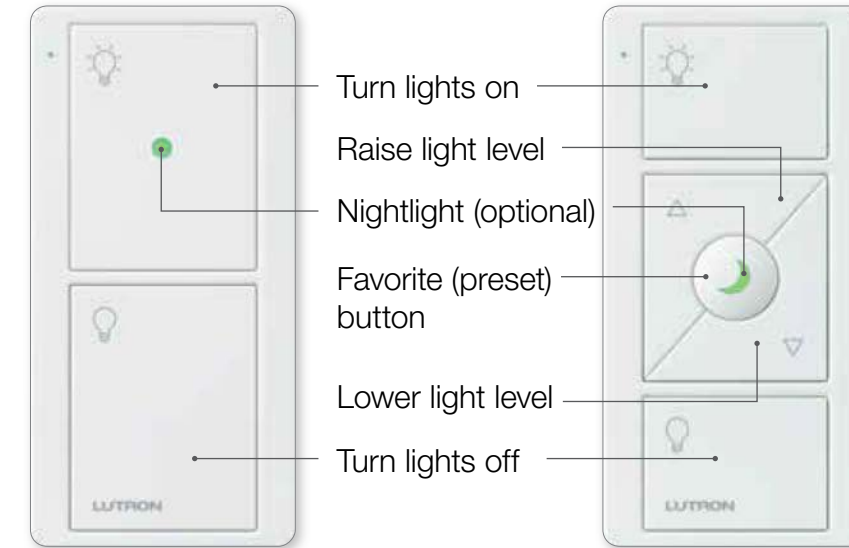

Pico® wireless control with nightlight, 2-button

Pico wireless control with nightlight, 3-button with raise/lower

**Coming soon—
Pico with nightlight**

The nightlight glows continuously, so it's easy to locate the Pico and turn on the lights in the dark.

- Available in two versions:
 - 2-button
 - 3-button with raise/lower
- 3-year battery life

Communicates via Lutron Clear Connect® RF technology

Compatible with:

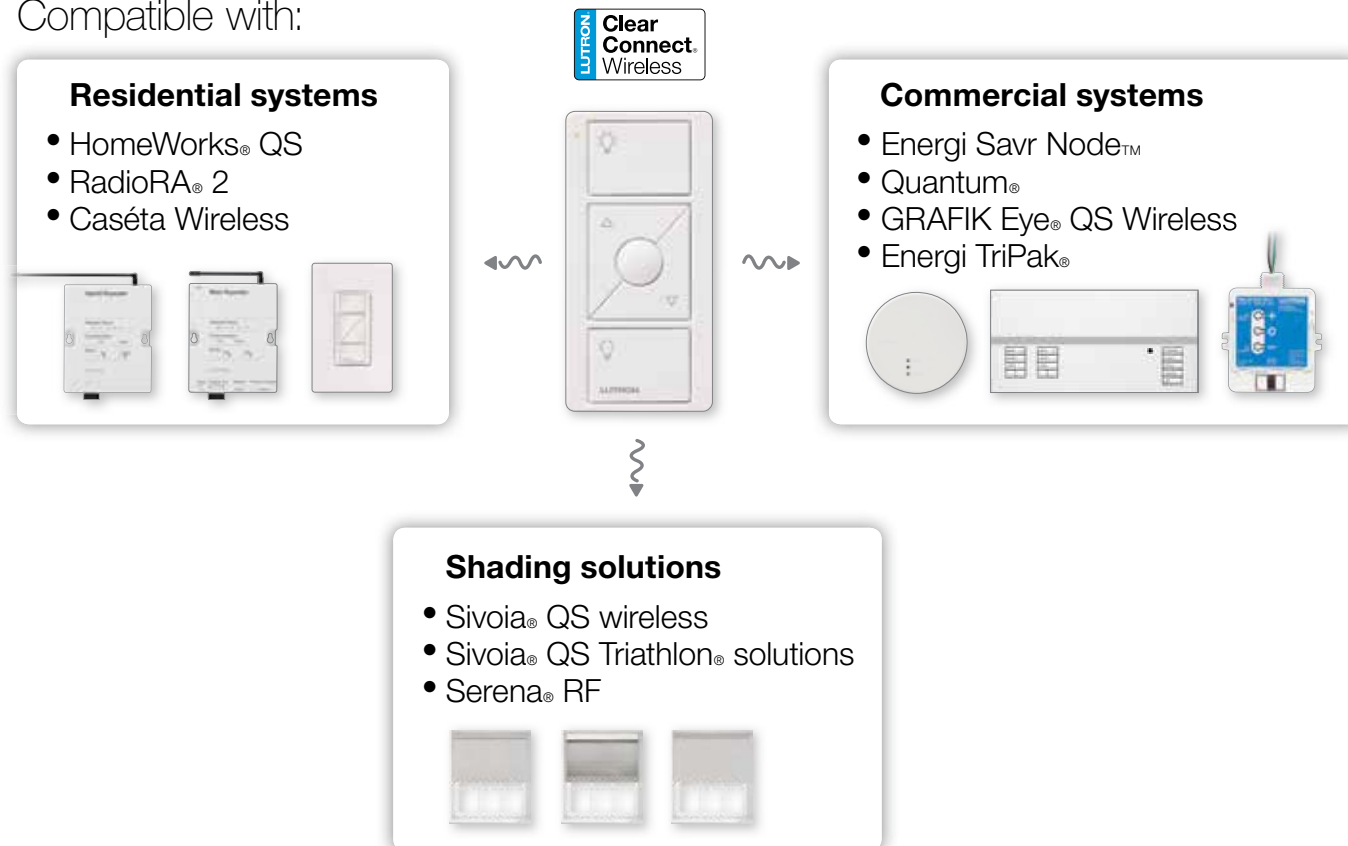

Accessories

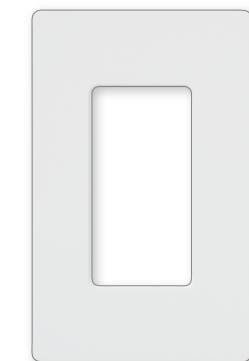

Claro® wallplate
(CW-1-WH)

- Provides a clean, screwless look
- Available with 1-6 openings



Wallplate bracket
(PICO-WBX-ADAPT)

- Use to surface-mount the Pico to a wall
- Required when mounting Pico over a 120V wallbox



Car visor clip
(PICO-CAR-CLIP)

- Insert the Pico into the clip for convenient control from your car



Tabletop pedestal
(L-PED1-, L-PED2*-, L-PED3-, L-PED4-)

- Single, double, triple, and quadruple pedestals available

* Double pedestal shown

Pico® ordering information

Build a Standard Pico Model Number

PJ2-XXXX-GXX-XXX

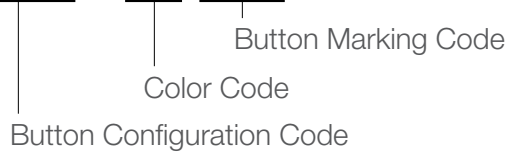

Coming Soon—build a Pico with Nightlight Model Number

PJN-XXXX-GXX-L01

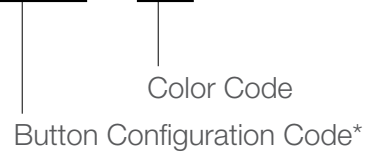

Button Configuration Codes:

Button Configuration	Code
2-button	2B
2-button with raise/lower	2BRL
3-button	3B
3-button with raise/lower	3BRL

Color Codes:

Gloss Color	Code
White	WH
Black	BL
Ivory	IV
Light Almond	LA
White/Gray	WG**

Button Marking Codes:

2-button

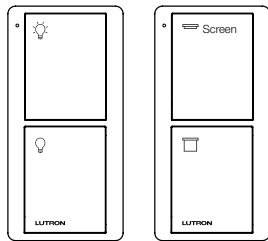

Light* (L01)

Screen (S08)

2-button with raise/lower

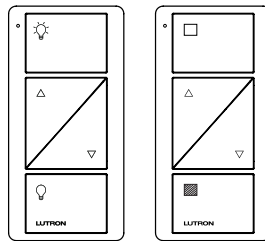

Light (L01)

Shade (icons) (S01)

3-button

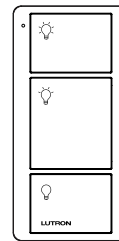

Light (L01)

3-button with raise/lower

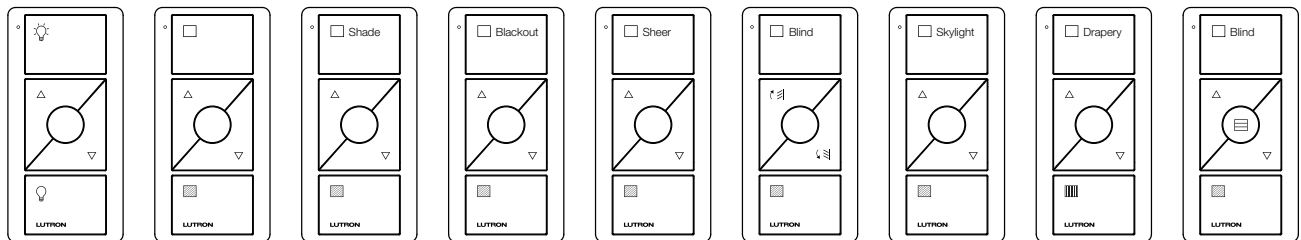

Light* (L01)

Shade (icons) (S01)

Shade (text) (S02)

Blackout (S03)

Sheer (S04)

Blind (S05)

Skylight (S06)

Drapery (S07)

Horizontal Sheer Blind (S09)

* Coming soon—Pico with nightlight will be available in 2-button (2B) or 3-button with raise/lower (3BRL) only

** On and Raise buttons are White; Preset, Lower, and Off buttons are Gray