

HL-VNRS Series LED Canopy Lights



VNRS-X-040 & 060(HLJ-L60C 40W & 60W)

FEATURES & SPECIFICATIONS

INTENDED USE

The energy savings, long life and easy-to-install design of the VNRS Series Canopy make it the smart choice for parking garage, gas station, recessed mounting or hang stright.

CONSTRUCTION

Heavy-duty cast aluminum housing; Die casting aluminum heatsink through conductive and convective cooling.

Housing is completely sealed against moisture and environmental contaminants(IP54).

FINISH

Dark Bronze and White finish. A tightly controlled multi-stage process ensures minimum 3 mils thickness for a finish that can withstand extreme climate change without cracking or peeling. Available in textured and non-textured finishes.

OPTICS

Precision-molded proprietary acrylic lenses provide multiple photometric distributions tailored specificall to building hang applications .Light engines are available in 4000k(80min.CRI) or 5000 K (80 CRI) configurations.

ELECTRICAL SYSTEM

Input Voltage: 120-277V or 347-480V, 50/60Hz ,Class 2 Driver

Power Factor: >0.87 at full load

Total Harmonic Distortion:<20% at full load

Integral 4kV surge suppression protection standard

INSTALLATION

Fast installation model , for quick and easy installation .

LISTINGS

ETL (CETL) certified to U.S and Canadian standards . Rated for -35°C minimum ambient DesignLights Consortium (DLC) qualified product.Not all versions of this product may be DLC qualified . Please check the DLC Qualified Products List at www.designlights.org to confirm which versions are qualified.

WARRANTY

Five year limited warranty.

Note: Actual performance may differ as a result of end-user environment and application. All values are design or typical values, measured under laboratory conditions at 25 ° C. Specifications subject to change without notice .

DIMENSIONS

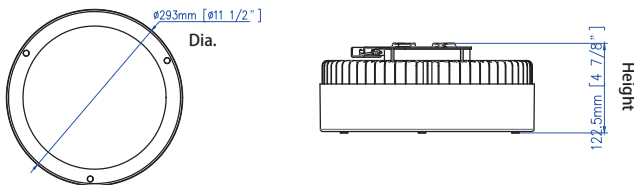

Surface Mounted With J-Box

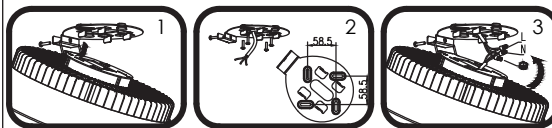

Pendent with 1/2 inch conduit

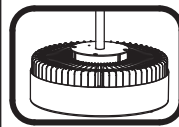

Hook Mount

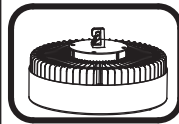

DIMENSION DATA

Luminaire	Dia.	Height	Weight (lbs.)
40W	11-1/2" (293mm)	4-7/8" (122.5mm)	12.78(5.8 kgs.)
60W	11-1/2" (293mm)	4-7/8" 122.5mm)	13.88 (6.3 kgs.)

PHOTOMETRICS

All published luminaire photometric testing performed to IESNA LM-79-08 standards by a certified laboratory.

Photometric Measurement

Luminous Flux (lm)	Efficacy (lm/W)	I _{max} (cd)	S/MH (C0/180)	S/MH (C90/270)
4078.27	100.87	1193	2.68	2.52

Luminous Intensity Distribution

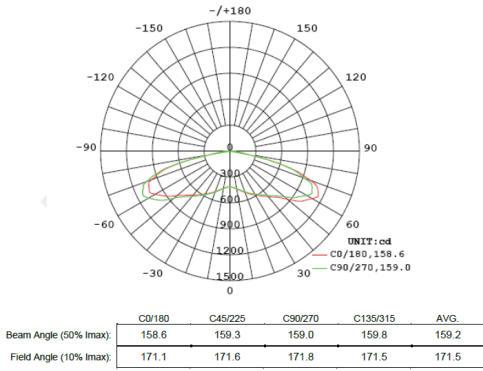

Angle: 159.2°. Flux out: 4002.0 lm.

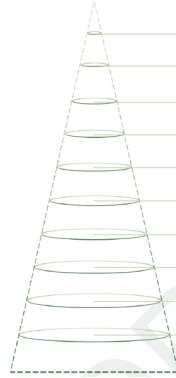

Height (m)	Diameter (cm)	E _{avg} (lx)	E _{max} (lx)
0.5	544.86	158.4	1722.0
1.0	1089.71	39.6	430.5
1.5	1634.57	17.6	191.3
2.0	2179.43	9.9	107.6
2.5	2724.29	6.3	68.9
3.0	3269.14	4.4	47.8
3.5	3814.00	3.2	35.1
4.0	4358.86	2.5	26.9
4.5	4903.71	2.0	21.3
5.0	5448.57	1.6	17.2

Photometric Measurement

Luminous Flux (lm)	Efficacy (lm/W)	I _{max} (cd)	S/MH (C0/180)	S/MH (C90/270)
5444.01	96.00	1507	2.28	2.38

Luminous Intensity Distribution

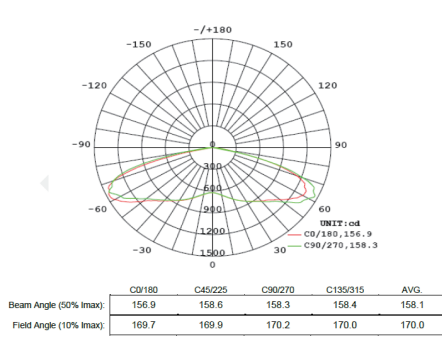

Angle: 158.1°. Flux out: 5350.0 lm.

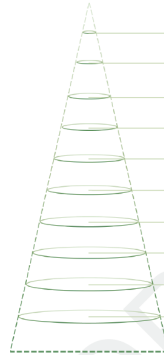

Height (m)	Diameter (cm)	E _{avg} (lx)	E _{max} (lx)
0.5	516.86	211.8	2569.0
1.0	1033.73	52.9	642.3
1.5	1550.59	23.5	285.5
2.0	2067.45	13.2	160.6
2.5	2584.32	8.4	102.8
3.0	3101.18	5.9	71.4
3.5	3618.04	4.3	52.4
4.0	4134.90	3.3	40.1
4.5	4651.77	2.6	31.7
5.0	5168.63	2.1	25.7

More optic photometrics , pls contact our sales or service .

Performance Data

Lumen Ambient Temperature (LAT) Multipliers

Use these factors to determine relative lumen output for average ambient temperatures from 0-40°C (32-104°F).

Ambient	Lumen Multiplier
0°C	1.12
10°C	1.11
20°C	1.11
25°C	1.05
30°C	1.01
40°C	1.00
50°C	0.98

Projected LED Lumen Maintenance

Data references the extrapolated performance projections for the VNRS LED Lights platform in a 25°C ambient based on 10,000 hours of LED testing (tested per IESNA LM-80-08 and projected per IESNA TM-21-11).

To calculate LLF, use the lumen maintenance factor that corresponds to the desired number of operating hours below. For other lumen maintenance values, contact factory.

Operating Hours	0	25,000	50,000	100,000
Lumen Maintenance Factor	1.0	0.90	0.87	0.80

Typical Specification

Products		VNRS-X-040-XXXX		VNRS-X-060-XXXX	
Item No.	Specification				
General Performance	CCT	3985+-275K	5028+-283K	3985+-275K	5028+-283K
	Input Voltage	120/277V	120/277V	120/277V	120/277V
	Input Wattage	40	40.5	57	57
	Initial Lumens	4049	4115	5424	5537
	Efficacy	100	102	96	98
	CRI	≥70		≥70	
	Power Factor	>0.87		>0.87	
	THD	≤20%+5% Tolerance		≤20%+5% Tolerance	
	Driver Type	Constant Current / Class 2		Constant Current / Class 2	
	Surge Protector	4KV		4KV	
Luminaire Life	50,000 Hours		50,000 Hours		
Feature	Driver	1-10V		1-10V	
	Photo Control	Compatible		Compatible	
	Microwave Sensor	N/A		N/A	
Operation Condition	Operating Temperature	-30°F ~ +130°F		-30°F ~ +130°F	
	Humidity	≤95%		≤95%	

1 DesignLights Consortium (DLC) qualified product. Not all versions of this product may be DLC qualified. Please check the DLC Qualified Products List at www.designlights.org to confirm which versions are qualified.

2 Specifications subject to change without notice. All values are design or typical values, measured under laboratory conditions at 25 °C. Actual performance may differ as a result of end-user environment and application.

Ordering Information

Example: VNRS-X-XXX-XXXX

Product	Mounting 1	Input Power 2	Voltage 3	CCT 4	Options 5
VNRS	E Parking Garage Mount F1 Low bay - G1/2" Pendent F2 Low bay - G3/4" Pendent H Hook Mount - G3/4"	040 40W 060 60W	2 120-277V 4 347-480V	4 4000K 5 5000K	MC - Microwave sensor XX - Non extra options (For optional parts, please kindly check the relative parts' spec sheet, it is not suitable for all the input voltage.)

† contact the sales for warranty terms.