

4" DOWNLIGHT 12W TITANIUM CRI^{SP} LED SERIES

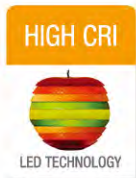

CRI^{SP}



12W REPLACES



50W Inc.

80% Energy Savings

\$151 Savings per lamp*

- ⌚ Suitable for installation in 4" housing
- ⌚ Wet location rated
- ⌚ Exceptional color rendering CRI 90
- ⌚ Richer reds and natural skin tones (R9 60, R13 90)
- ⌚ Smooth dimming with existing dimmers
- ⌚ GU24 connector available



DOWNLIGHT PRODUCT FEATURES

Installation Method

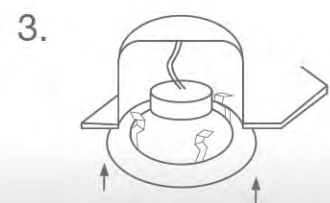
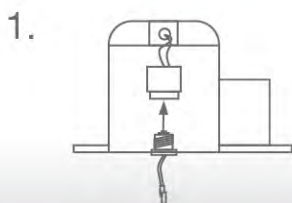

CRI & CA Quality Specification

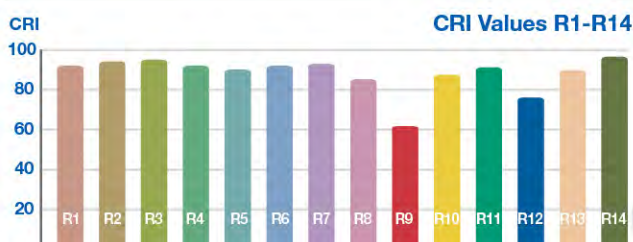

The CRI^{SP} SERIES DOWNLIGHT 12W lamp features a typical CRI 90, R9 60 and R13 90, providing crisp and vibrant colors across the whole spectrum. Its exceptional R9-R14 values (R9 & R13) provide redder reds, natural looking skin tones and whiter whites.

This lamp meets the California Quality Specification which requires a CRI of 90+ and demands color temperatures fall within a 4-step Macadam ellipse to ensure minimal color deviation across lamps.

4" DOWNLIGHT 12W TITANIUM CRI^{SP} LED SERIES



APPLICATIONS

General Lighting

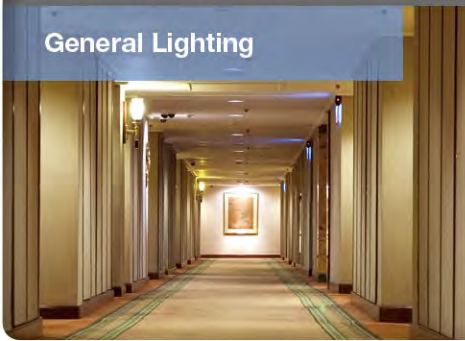

Recessed Lighting

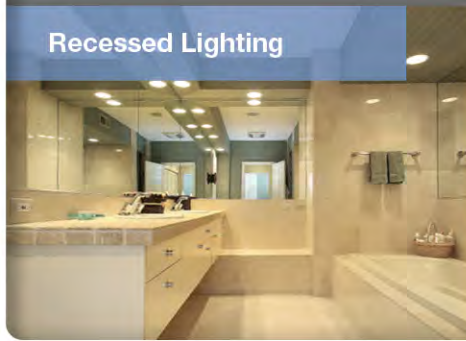

Accent Lighting



Ref. #DS095-4DL-12W

SPECIFICATIONS**

Product Model	97762 12DL4DIM/927	97763 12DL4DIM/930
Type	4" Downlight	4" Downlight
Base	E26 / LED Adapter (GU24 optional)	E26 / LED Adapter (GU24 optional)
Power (W)	12	12
Voltage - Frequency	120V 60Hz	120V 60Hz
Color Temp. (ANSI)	Warm White 2700K	Warm White 3000K
CRI (Ra)	90	90
R9 / R13 (typ.)	60 / 90	60 / 90
Typical lumens (lm)	600	650
Efficacy (LPW)	50	54
Beam Angle	85°	85°
Dimmable	Yes***	Yes***
Housing Compatibility	Most 4" housing	Most 4" housing
Power Factor	0.9	0.9
Rated Lifetime - L70 (hrs.)	35,000	35,000
Dia. x MOL	5.35"x3.50" (136x89mm)	5.35"x3.50" (136x89mm)
Weight (lb. / g)	0.46lb. / 209g	0.46lb. / 209g

* Savings per lamp based on \$0.11 / kw energy cost, 12 hrs / day lamp usage, \$4 incandescent with 1000-hr lifetime, \$28 LED with 35,000-hr lifetime
 ** Specification data is preliminary and may be subject to change

*** List of tested dimmer switches available on website
 **** Suitable for damp locations. Not for use where directly exposed to weather or water