



GREENCREATIVE

Bringing You the Latest in LED Technology

INNOFIT
SERIES



CDL INNOFIT SERIES

COMMERCIAL DOWNLIGHT PRODUCT FEATURES

Adjustable Lumen Output

This commercial downlight features adjustable lumen output for three distinct lumen levels equivalent to various CFL lamp combinations. Simply adjust the lamp power to the desired lumen output by sliding the selector switch on top of the fixture.



Easy-Fit Installation

The adjustable housing clips allow for installation in a large range of commercial and architectural housings. These spring-action clips push up easily and fit securely for both retrofit and new construction installations.

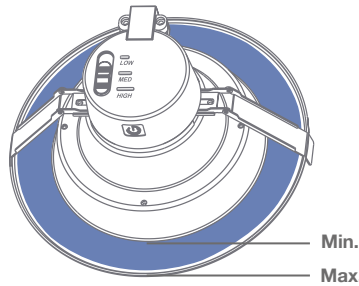
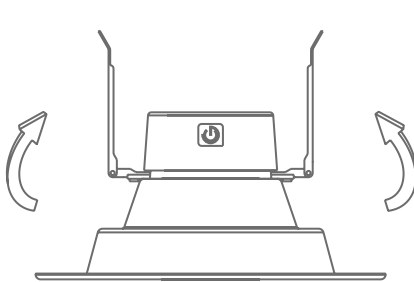

Housing Compatibility		
Model	Aperture Min.	Aperture Max.
9.5"	8.6" (220mm)	10.4" (265mm)
8"	7.6" (195mm)	9.4" (240mm)
6"	6.0" (153mm)	7.4" (190mm)
4"	3.9" (100mm)	5.1" (130mm)

Simple Retrofit or Economical New Construction Installation

Retrofit Installation

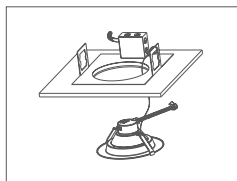

Attach safety clip

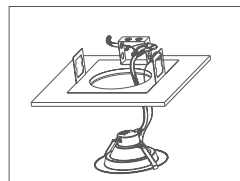

Bypass ballast & wire to j-box

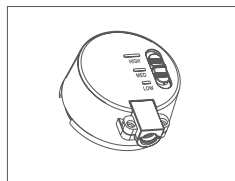

Adjust lumens to desired output

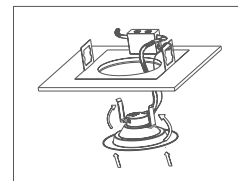

Push clips up & install into fixture

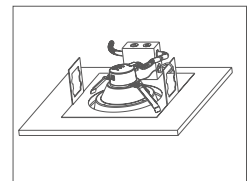

Ensure fixture is flush. Installation is complete

New Construction Installation

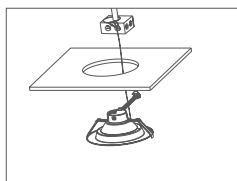

Attach safety clip

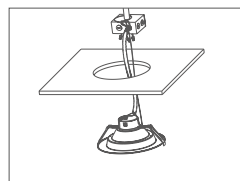

Wire to j-box

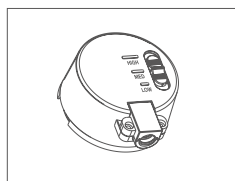

Adjust lumens to desired output

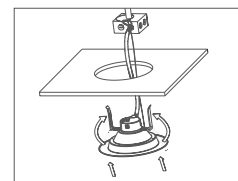

Push clips up & install into opening

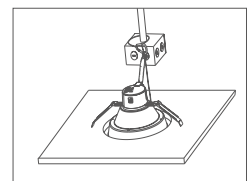

Ensure fixture is flush. Installation is complete

CDL INNOFIT SERIES

9.5" CDL 45W

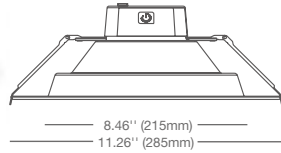

-4.84" (123mm)-

- 120-277V Universal voltage
- 23.5W / 32W / 45W
- 2000lm / 2500lm / 3200lm
- 2700K / 3000K / 3500K / 4000K CCT

Fluorescent Equivalence		
Power	Lumens	Equivalent
LOW-23.5W	2000	1X42W / 2X26W
MED-32W	2500	1X57W / 2X32W
HIGH-45W	3200	2X42W

8" CDL 27W

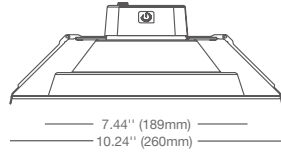

-4.33" (110mm)-

- 120-277V Universal voltage
- 12W / 19W / 27W
- 1000lm / 1500lm / 2000lm
- 2700K / 3000K / 3500K / 4000K CCT

Fluorescent Equivalence		
Power	Lumens	Equivalent
LOW-12W	1000	1X26W / 2X13W
MED-19W	1500	1X32W / 2X18W
HIGH-27W	2000	1X42W / 2X26W

6" CDL 21W

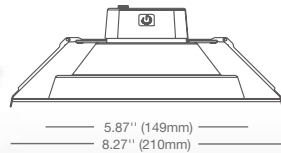

-4.02" (102mm)-

- 120-277V Universal voltage
- 8.5W / 13.5W / 21W
- 700lm / 1000lm / 1500lm
- 2700K / 3000K / 3500K / 4000K CCT

Fluorescent Equivalence		
Power	Lumens	Equivalent
LOW-8.5W	700	1X18W
MED-13.5W	1000	1X26W / 2X13W
HIGH-21W	1500	1X32W / 2X18W

4" CDL 14W

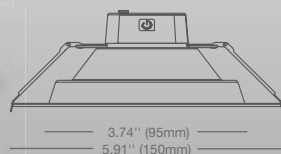

-3.46" (88mm)-

- 120-277V Universal voltage
- 6W / 9W / 14W
- 500lm / 700lm / 1000lm
- 2700K / 3000K / 3500K / 4000K CCT

Fluorescent Equivalence		
Power	Lumens	Equivalent
LOW-6W	500	1X13W
MED-9W	700	1X18W
HIGH-14W	1000	1X26W / 2X13W





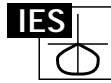

LM 79

LM 80

TM 21



SPECIFICATIONS*

	Model	Product	CCT	Power (W)	Lumens (lm)	LPW	Beam Angle	CRI (typ.)	Dim	Life (hrs)	Voltage	
 CDL 9.5\" 45W	45CDLA9.5/827/277V	57878	2700K	23.5/32/45	1860/2325/2975	79/73/66	110°	80	No	40,000	120-277V	Mar.
	45CDLA9.5/830/277V	57879	3000K	23.5/32/45	2000/2500/3200	85/78/71	110°	80	No	40,000	120-277V	Mar.
	45CDLA9.5/835/277V	57880	3500K	23.5/32/45	2000/2500/3200	85/78/71	110°	80	No	40,000	120-277V	Mar.
	45CDLA9.5/840/277V	57881	4000K	23.5/32/45	2000/2500/3200	85/78/71	110°	80	No	40,000	120-277V	Mar.
 CDL 8\" 27W	27CDLA8/827/277V	57873	2700K	12/19/27	930/1400/1860	78/74/69	110°	80	No	40,000	120-277V	✓
	27CDLA8/830/277V	57874	3000K	12/19/27	1000/1500/2000	83/79/74	110°	80	No	40,000	120-277V	✓
	27CDLA8/835/277V	57875	3500K	12/19/27	1000/1500/2000	83/79/74	110°	80	No	40,000	120-277V	✓
	27CDLA8/840/277V	57876	4000K	12/19/27	1000/1500/2000	83/79/74	110°	80	No	40,000	120-277V	✓
 CDL 6\" 21W	21CDLA6/827/277V	57868	2700K	8.5/13.5/21	650/930/1400	76/69/67	110°	80	No	40,000	120-277V	✓
	21CDLA6/830/277V	57869	3000K	8.5/13.5/21	700/1000/1500	82/74/71	110°	80	No	40,000	120-277V	✓
	21CDLA6/835/277V	57870	3500K	8.5/13.5/21	700/1000/1500	82/74/71	110°	80	No	40,000	120-277V	✓
	21CDLA6/840/277V	57871	4000K	8.5/13.5/21	700/1000/1500	82/74/71	110°	80	No	40,000	120-277V	✓
 CDL 4\" 14W	14CDLA4/827/277V	57863	2700K	6/9/14	465/650/930	78/72/66	110°	80	No	40,000	120-277V	Mar.
	14CDLA4/830/277V	57864	3000K	6/9/14	500/700/1000	83/78/71	110°	80	No	40,000	120-277V	Mar.
	14CDLA4/835/277V	57865	3500K	6/9/14	500/700/1000	83/78/71	110°	80	No	40,000	120-277V	Mar.
	14CDLA4/840/277V	57866	4000K	6/9/14	500/700/1000	83/78/71	110°	80	No	40,000	120-277V	Mar.

* Specification data is preliminary and may be subject to change

** Suitable for damp locations