

# FLANGE KITS

## INSTALL INSTRUCTIONS

### WARNING

**PLEASE FIND A QUALIFIED ELECTRICIAN FOR INSTALLATION.** Please read the instructions before you install and use the luminaire.

- Turn circuit breaker(s) off or remove fuse(s) before installation.
- Kits must be installed in accordance with all local codes and ordinances.
- SUITABLE FOR DAMP LOCATIONS.

### SAFETY INFORMATION - TO REDUCE THE RISK OF FIRE, OR INJURY TO PERSONS:

- Suitable for installation in sheet rock / plasterboard in both insulated ceilings and non-insulated ceilings. Not for continuous row mounting.
- Do not handle powered fixtures when hands are wet or standing on damp or wet surfaces.
- Vapor barrier must be suitable for 90°C.
- Flange kit to be independently supported to building structure.

SAVE THESE INSTRUCTIONS

### INSTALLATION

Fixture is suitable only for INDOOR RECESSED CEILING APPLICATION.

ITEM#	DESCRIPTION	CEILING OPENING (L x W)
55127	1X4 FLANGE KIT FOR TROFFER/WHITE- SUPERIOR LIFE®	48.6 x 12.6
55128	2X2 FLANGE KIT FOR TROFFER/WHITE- SUPERIOR LIFE®	24.6 x 24.6
55129	2X4 FLANGE KIT FOR TROFFER/WHITE- SUPERIOR LIFE®	48.6 x 24.6

### MOUNTING IN AN INSULATED OR NON-INSULATED - SHEET ROCK CEILING

1. Assemble the four pieces of the Flange Kit with the screws provided. Fig A
2. Secure the Flange Kit to the building structure by Hanger Wires (Fig B), alternatively screw to Wood Blocking (Fig C).
3. Bend the pre-installed Clips (4) flat to the fixture housing.
4. Follow wiring directions on fixture installation instruction sheet.
5. Rotate and slide the fixture to fit through the drywall opening and place it on the flange kit.

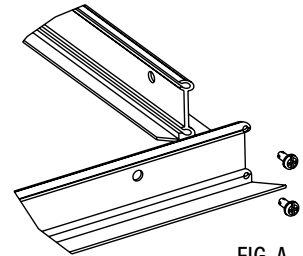

FIG. A

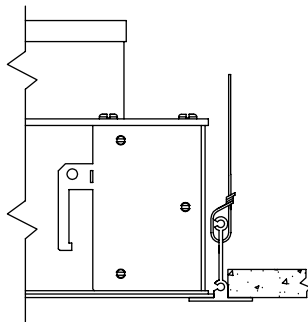

FIG. B

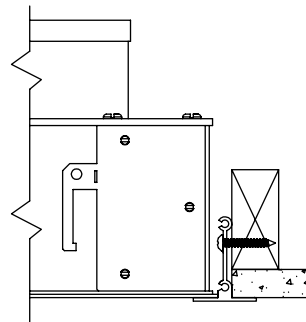

FIG. C