



Important: Read all instructions prior to installation

Wireless Quattro 4 Zone Dimmer

12-36vdc LED Wall+Mini Remote Control

Parts Included

- 1 - 4 Zone Wall Dimmer Control
(or use as mini touchpad remote)
- 1 - CR2032 Long Life Battery
- 1 - Installation Instructions

Wall Buttons

Button Actions: On/Off/Dimming Functions

Left & Right Buttons All Zones	Single push of Left zone button turns lights on in paired zone(s). Single push of Right zone button turns lights off in paired zone(s).
Left & Right Buttons All Zones	Press and hold Left zone button to increase brightness. Press and hold Right zone button to decrease brightness.
Note	Remote needs to be in range of receivers. Average range is 100'. Range will decrease as battery power gets low.

Pairing Instructions:

After you have wired all the receivers according to your project requirements, do the following:

- If you use multiple receivers, you have two choices: (1) Have all the receivers in the same zone, like zone 1 for example, or (2) have each receiver(s) in a different zone, like Zone 1, 2, 3 or 4.
- In order for each receiver to know what Zone it belongs to, you will need to "pair" it to the zone you wish to use. In order to do this, you need to power up the unit with the LED lights hooked to it. First reset the Receiver by pressing and holding the "Learning" button until the LED lights blink off and on; then release the "Learning" button. Immediately press and release the "Learning" button a second time, and then press and release the UP arrow in the desired Remote zone. The LED Lights will blink off and on a second time to indicate that the Receiver has been paired with the selected Remote zone.
- Do the same for any other receivers if you use them.

NOTE: Reset the receiver by pressing and holding the "Learning" button until the lights blink off and on. You can now pair it to a different zone.

#RAZ-Q4RF Wireless Wall Control Installation

- Install the Long Life Cr2032 battery in the touchpad.
(Can be used as a handheld remote)
- Securely attach the touchpad to the mounting plate.
- Install the touchpad mounting plate assembly into the desired electrical box location. The #RAZ-Q4RF can be gauged with other switches.
- Attach your coverplate (not included) and you're ready to pair your receiver to your touchpad.



RAZ-Q4RF LED Dimmer Wall Switch

Operating Voltage	Operating Frequency
3VDC	434 MHz/868 MHz

RAZ-WR96 LED Receiver

Input Voltage	Current	Output Voltage
1X(12-36)VDC	1X8A	1X(96-288)W

Safety

DO NOT expose the remote or receiver to direct or indirect moisture

Set-Up Instructions

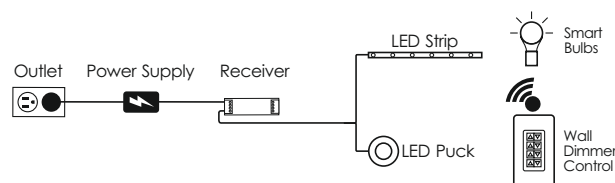

Set-Up Example 1

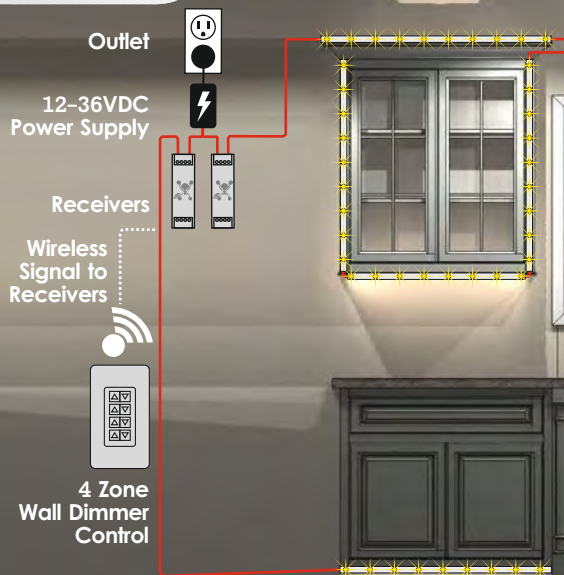

Set-Up Example 2



RAZ-WR96 HOOKUP GUIDE

1000Bulbs.com

The following steps(1-4) were taken to customize your RazorLED RAZ-WR96 Receiver for use with 1000Bulbs.com single color tape light offerings

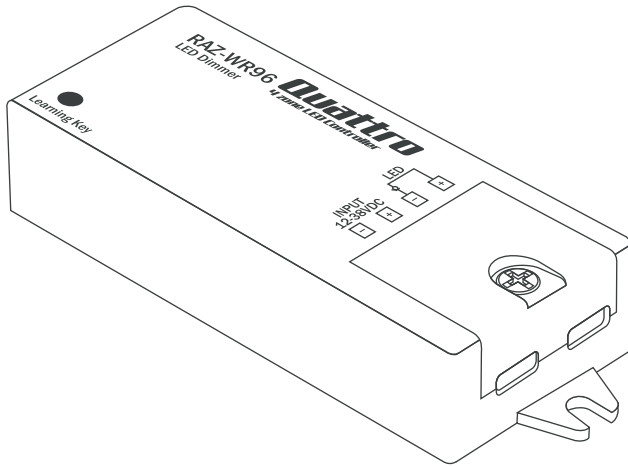

Pre-installation

Tools required



Wire Strippers

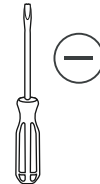

Flat Blade Screwdriver

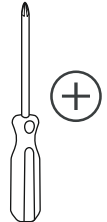

Phillips Screwdriver

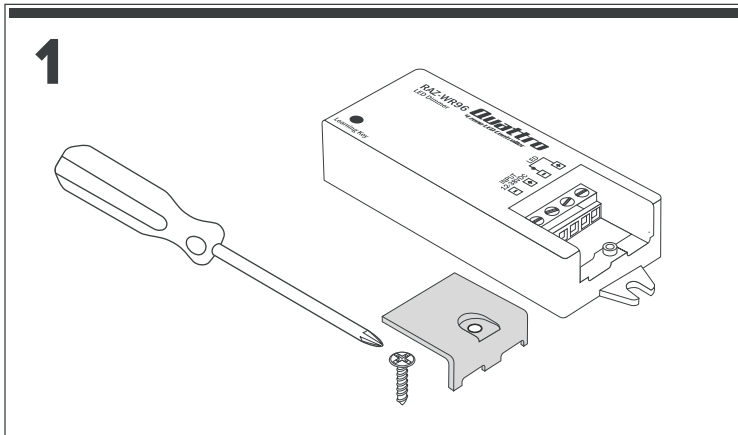

1. Remove cover with Phillips screwdriver.

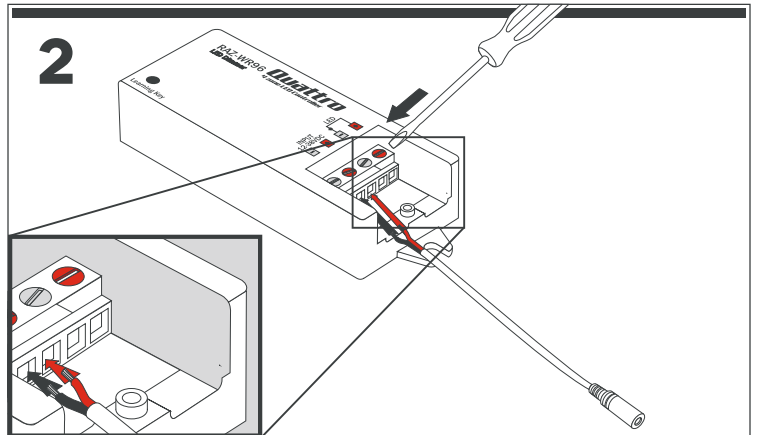

2. Loosen the 4 flat head terminal screws using the flat blade screwdriver. Connect the female plug cables as shown. Tighten 2 screws.(+ Red wire) (- Black wire)

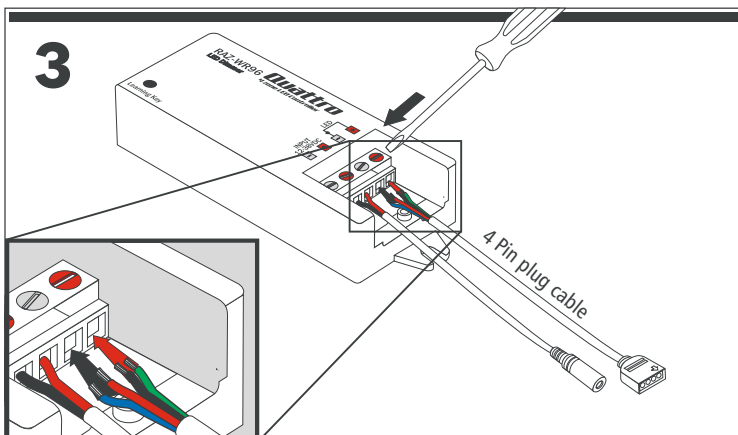

3. Connect the 4 pin connector cables as shown. Tighten 2 screws.(-Red Blue wire) (+ Black Green wire)

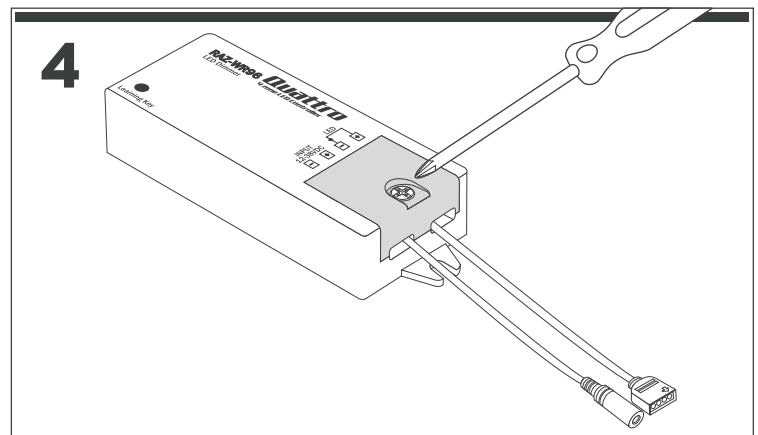

4. Attach cover with Phillips screwdriver. Do not over tighten.

RAZ-WR96 HOOKUP GUIDE

1000Bulbs.com

Steps(5-7) prepare your project for pairing instructions

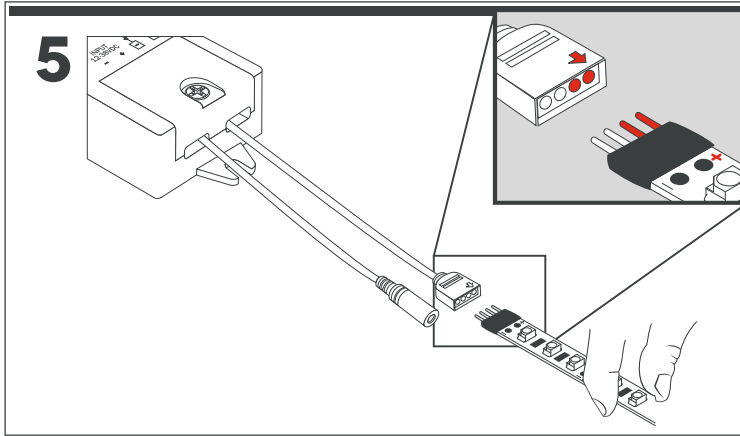

5. Insert LED Strip into the 4 plug connector.
Press firmly to ensure secure connection

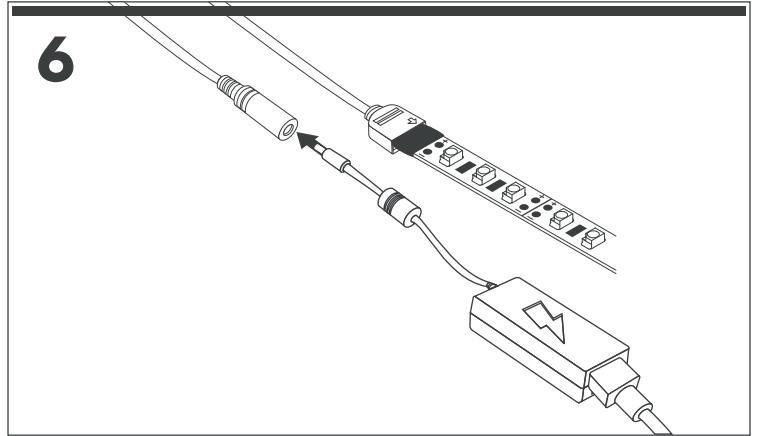

6. Connect the male end of the power supply to the
Female plug cable.

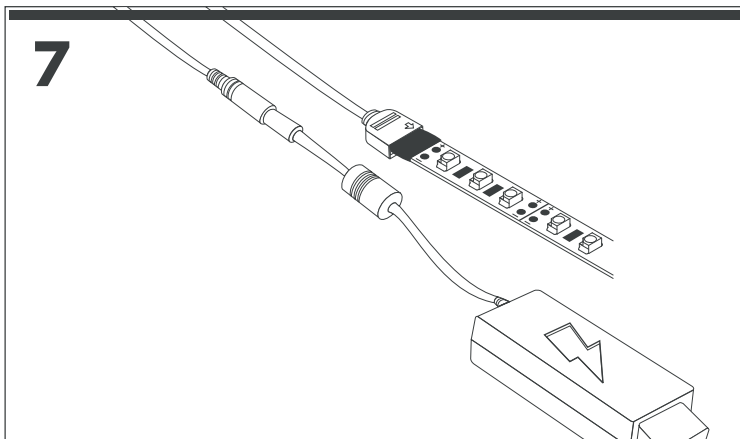

6. Plug in the power supply and proceed to the
pairing instructions

PAIRING INSTRUCTIONS

1000Bulbs.com

After you have wired all the receivers according to your project requirements, do the following:

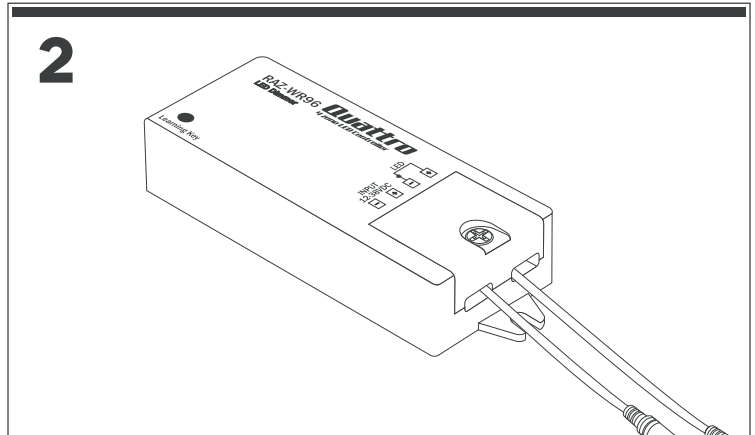
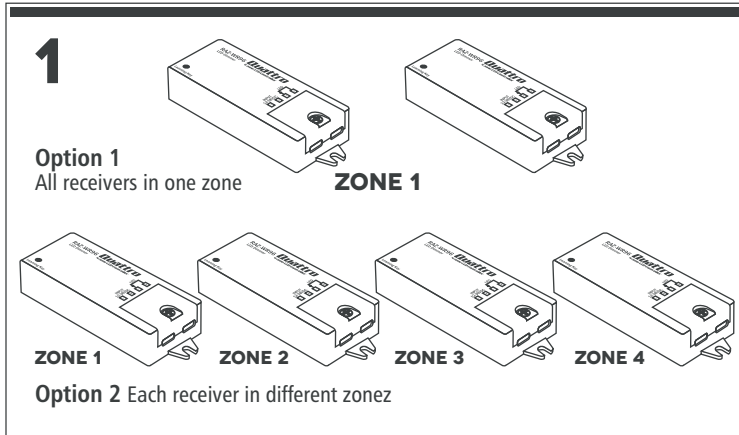

1. If you use multiple receivers, you have two choices:
(1) have all the receivers in the same zone, like zone 1, or
(2) have each receiver in a different zone, like zone 1, 2, 3 or 4.

2. In order for each receiver to know what Zone it belong to, you will need to "pair" it to the zone you wish to use. In order to do this, you need to power up the unit with the LED lights hooked to it.

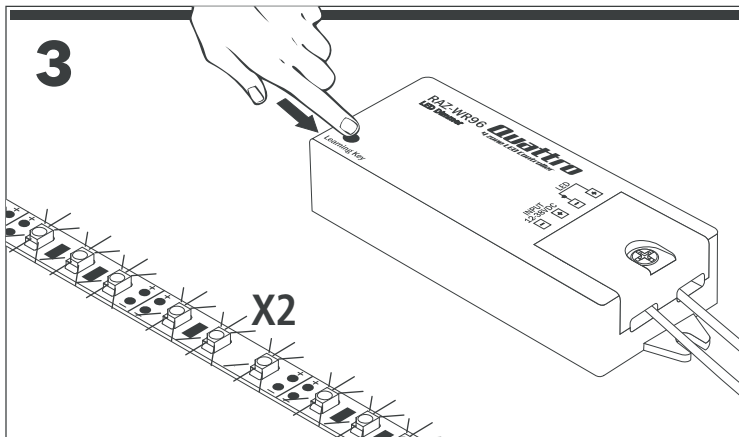

3. Reset the receiver by pressing and holding the "Learning" button until the lights blink off and on; then release the "Learning" button

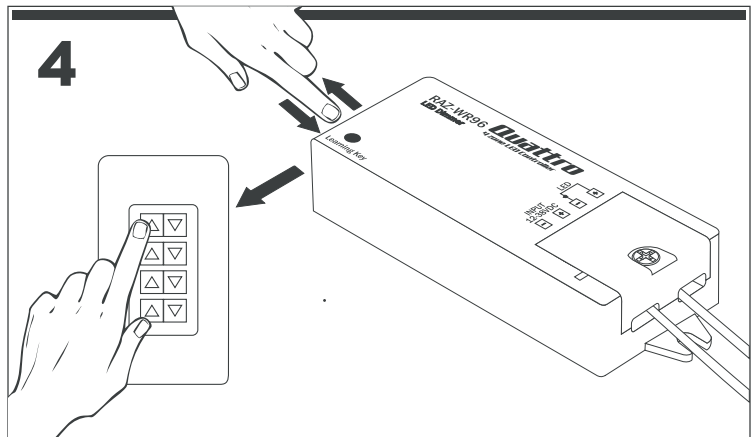

4. Immediately press and release the "Learning" button a second time, and then press and release the UP arrow in the desired Remote zone.

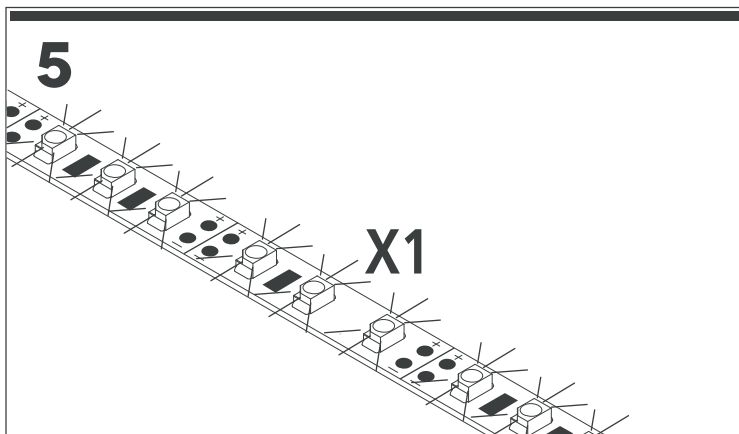

5. Once you do that, the lights will blink off and on a second time. Now your Remote and Receiver are paired.