

55174

LED 2x2 DIMMABLE PANEL / 40W

TECHNICAL DATA SHEET

FEATURES



INDOOR LUMINAIRES

LED panels provide smooth glare-free illumination and uniform edge-to-edge light distribution for a clean, modern look. Simple installation; for use in drop ceilings or drywall.

- 0-10V dimming function, dimming range is 10% - 100%
- Hanging apparatus not included.

APPLICATION

Panels are the ideal energy-efficient replacements for fluorescent fixtures in offices, schools, hospitality, healthcare and other commercial and industrial applications.

SPECIFICATIONS

Power Consumption	40W
Input Voltage	120-277V
Power Factor	0.9
Lumens	3800
Luminous Efficiency	95 Lm/W
Color Temperature	4000K
CRI	83
Frame	White
Average Life	50,000
Dimension (Inches)	23.7"(L) x 23.7"(W) x 0.5"(H)

Dimmable LED
SUITABLE FOR
DAMP LOCATIONS



DIMENSIONS

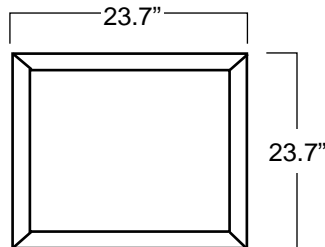

ORDERING

ITEM#	DESCRIPTION	WATT	COLOR	LUMENS	CRI	VOLT	HOURS	FRAME	CASE
55174	LED 2 X2 PANEL 40W/40K/120-277V/DIMMABLE/V4 - SL®	40	4000K	3800	83	120-277V	50,000	WHITE	2

Please check DLC website for the most current list of approved items
Published lumens on LED products are approximate and may vary slightly.