

NEW CONSTRUCTION DOWNLIGHT INSTALLATION GUIDE – WARNING

WARNING – Read all product labels and instructions before installing fixture.

WARNING – Risk of fire or electric shock. LED fixture installation requires knowledge of luminaire electrical systems. Installation should be performed only by a qualified electrician in accordance with the National Electrical Code and relevant local code.

WARNING – Risk of fire or electric shock. Install this fixture only in ceilings that have the construction features and dimensions shown in the photographs and/or drawings.

WARNING – To prevent wiring damage or abrasion, do not expose wiring to edges of sheet metal or other sharp objects.

WARNING – Do not make or alter any open holes in an enclosure of wiring or electrical components during fixture installation.

WARNING – The fixture is intended for mounting only in a covered ceiling where only the led side of the luminaire will be exposed to damp or dry locations.

WARNING – INSTALLATION SHOULD ONLY BE PERFORMED AFTER POWER TO THE FIXTURE HAS BEEN DISCONNECTED.

- For 11.6DLNC6DIM/xxx: MIN. LAMP COMPARTMENT DIMENSIONS 6.30" (DIA) x 2.36" (H).
- For 8.5DLNC4DIM/xxx: MIN. LAMP COMPARTMENT DIMENSIONS 4.25" (DIA) x 2.36" (H).

NEW CONSTRUCTION DOWNLIGHT INSTALLATION

1. Make sure the POWER IS TURNED OFF at the source to the area in which you are installing the product.
2. Using a pencil, trace the provided cardboard cutout on the ceiling (fig. 1). Cut the hole following the inside of the traced circle (fig. 2). If using a hole cutter, set the diameter to 6.3" (160mm) for the 11.6DLNC6DIM/xxx and 4.25" (108mm) for the 8.5DLNC4DIM/xxx.
3. Pull up on the tab to remove the j-box lid on the downlight (fig. 3) and insert the incoming wire through the plastic j-box wire clamp (fig. 4). If using flex conduit, insert through adjacent knockout.
4. Insert wires into the downlight quick connectors (black to black, white to white) and cap off the ground using the provided wire nut (fig. 4). Replace j-box lid and push down on the front tab until it clicks when done (fig. 5).
5. Push up the spring-action clips and insert the downlight into the ceiling (fig. 6). Release the springs and make sure the downlight is secure and sitting flush in the ceiling.
6. Restore power at the source and the installation is complete (fig. 7).

fig. 1

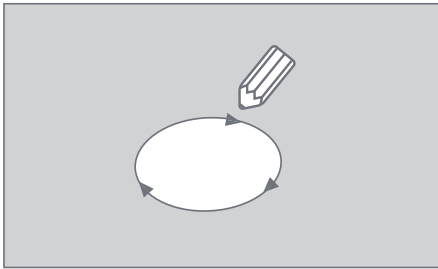

fig. 2

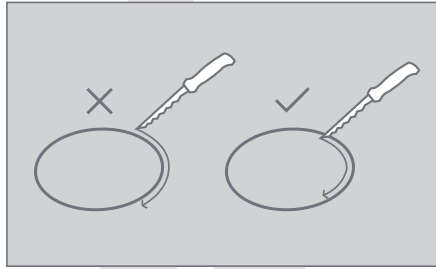

fig. 3

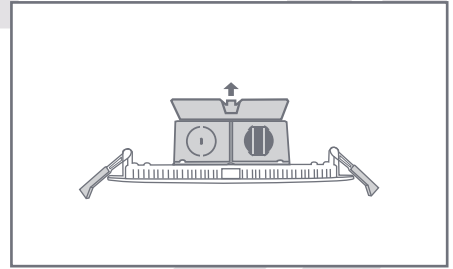

fig. 4

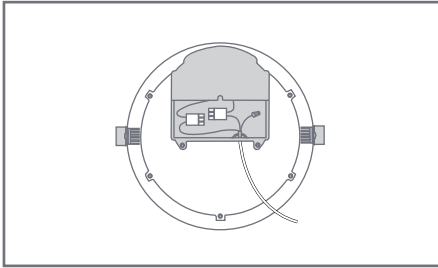

fig. 5

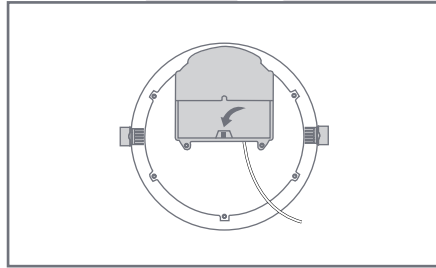

fig. 6

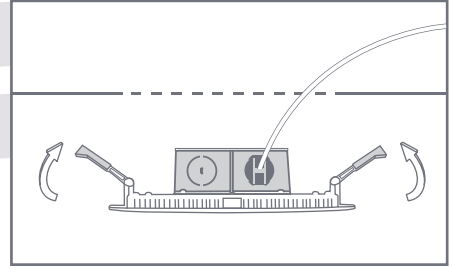

fig. 7

