

FEATURES

1. Lamp Cover Release Screw
2. Flashlight
3. Charging Indicator
4. Search Light / Led Light Selector
5. DC Jack
6. Handle
7. Battery Door
8. Battery Selector
9. Adaptor

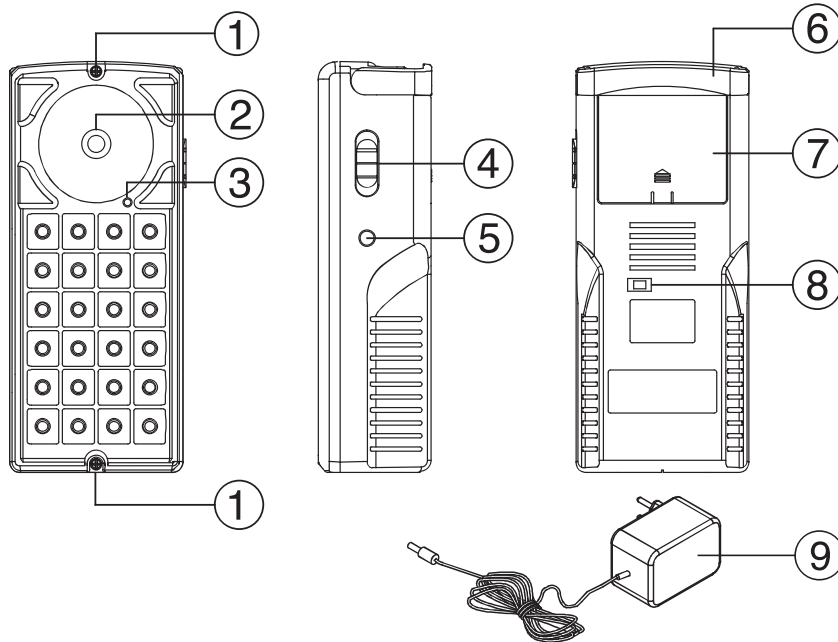

The lightning flash with arrowhead symbol, within an equilateral triangle, is intended to alert the user to the presence of uninsulated, "DANGEROUS VOLTAGE" within the product's enclosure that may be of sufficient magnitude to constitute a risk of electric shock to persons.



The exclamation point within an equilateral triangle is intended to alert the user to the presence of important operating and maintenance (servicing) instructions in the literature accompanying the appliance.

WARNING: TO REDUCE THE RISK OF FIRE OR ELECTRIC SHOCK, DO NOT EXPOSE THIS APPLIANCE TO RAIN OR MOISTURE.

GAMA SONIC[®]

RECHARGEABLE LED LANTERN

with FLASHLIGHT

INSTRUCTION MANUAL

MODEL: DL-972LS

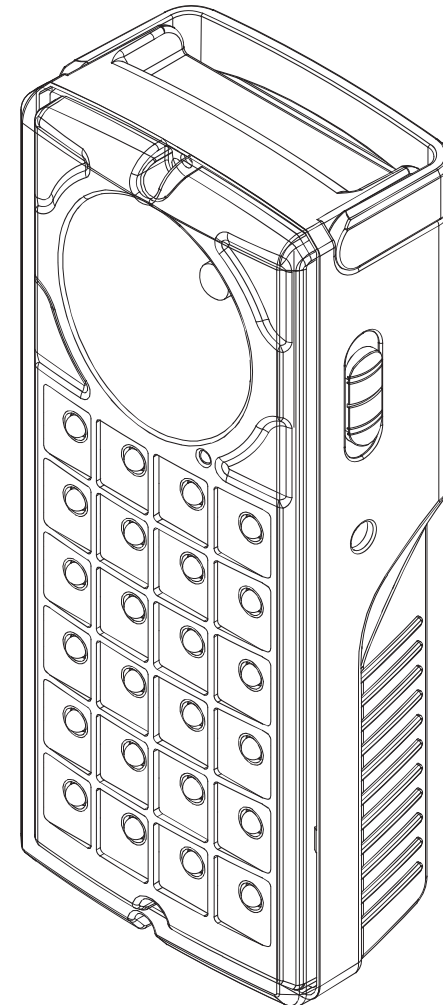

INDOOR USE ONLY



IMPORTANT

1. Please read the Instructions before operate on the lamp functions.
2. Make sure the electric rating of your home power supply before plugging in.
3. Always recharge the lamp when light goes dim, and keep within 3 month to recharge once.
4. The efficiency may decrease if the lamp is used or charged when temperatures are below 32°F(0°C) or above 104°F(40°C).
5. Please keep out of reach of water or rain for properly use.

HOW TO OPERATE THE LED LAMP & FLASHLIGHT

1. Full light-up (24pcs)
Place the power on/off switch (No.4), to position to light up all the 24 LEDs 
2. Torch of operate.
Place the power on/off switch (No.4), to position will light up the Torch. 
3. Place the power on/off switch (No.4), to "OFF" position to end the both operation.

NOTE: The lamp can be operated by DC power only.

CAUTION: Please make sure your home power supply before plugging in.

HOW TO RECHARGE THE LAMP

1. Plug in the AC adaptor "DC Jack" (Drawing 1) into the unit (No.8) and then plug-in the AC adaptor into the power source (wall socket).

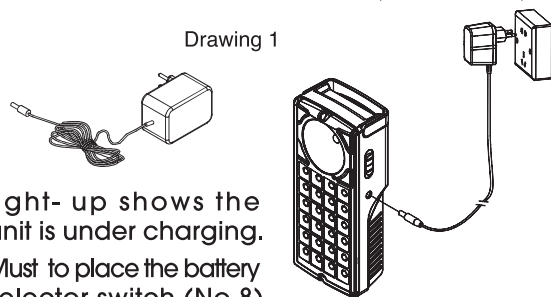



2. light- up shows the unit is under charging.
3. Must to place the battery selector switch (No.8) to lead acid battery position for recharge.

WARNING FOR THE RECHARGEABLE LEAD ACID BATTERY:

1. This Rechargeable Lamp is only applicable

for charging the sealed Lead-Acid battery. Do not charge with different types or non-rechargeable batteries.

2. Plug in the AC cord terminal into the appliance AC socket (No.5), and then plug in the AC power plug into the wall socket.
3. During using or recharging the lead-acid battery, the appliance must be placed in a well ventilated area.  
4. The orientation of the lead-acid battery with regard to polarity battery contact (+) & (-). Do not short circuit or put into fire, avoid reverse charging.
5. Regarding safe disposal of used lead-acid batteries, insert the batteries into battery charger according to the lead-acid battery polarity.
6. Leaking lead-acid battery must be removed from the appliance carefully. The lead-acid battery must be recycled or disposed of properly.
7. The lead-acid battery must be removed from the appliance before it is scrapped.
8. The lead-acid battery is to be disposed of safely by putting into battery compartment with cover.
9. The appliance must be disconnected from power supply before removing the battery.

HOW TO CHOICE OF THE DRY BATTERIES OR RECHARGEABLE LEAD ACID BATTERY FOR OPERATION

1. Place the battery selector switch (No.8) to choice dry batteries or lead acid battery position for unit operation.
2. The dry batteries function for unit operate only, cannot recharge process of the appliance.

How to replace the dry batteries (Please see Drawing 2)

1. Switch off the unit (No.4)
2. Open the battery door.
3. Remove the old battery.
4. Replace three new dry batteries properly and then close the battery door.

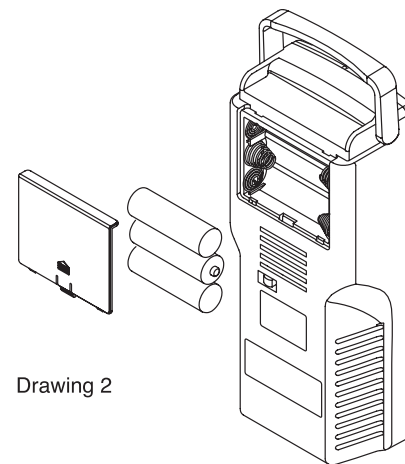

Drawing 2

TECHNICAL SPECIFICATIONS :

Input Voltage.....	DC6V
Input Power.....	2W
Operating Temperature.....	0°C-40°C
Humidity	lower than 90%

LED Specification:

Super bright SMD LED 3528 (0.06W) x 24pcs for Lamp	
8mm super bright LED 0.26W 1pc for Torch	
Charging Time.....	Approx 12Hours
Rechargeable Lead Acid Battery.....	4V/2Ah
Dry battery.....	"AA"size 1.5V x3pcs

Duration time of the rechargeable battery:

LED Lamp 24 pcs	Approx 6 Hours
LED Flashlight.....	Approx 35 Hours

Accessories Provided: AC Adaptor with UL approved

Input voltage:	AC100V-240V ~50/60Hz
Output voltage:	DC6V / 300mA

MAINTENANCE

Use a small cotton swab with cleaning alcohol to clean the lamp. Never use strong or volatile chemicals to the lamp as it will damage to the plastic parts.

WARNING

To avoid an electrical shock, please do not open the lamp unit for repairing or cleaning unless qualified person. If the power cord of the appliance is damaged. It is only to be repaired by a specialist named by the manufacturer as special tools are necessary.