

PL V 10W BYP TITANIUM LED SERIES



10W REPLACES



**26W
CFL**

60% Energy Savings

PRO



- Ⓞ **HYBRid installation - DIRect or BYPass**
- Ⓞ **Compatible with magnetic ballasts - DIRect installation**
- Ⓞ **Built-in universal voltage driver - BYpass installation**
- Ⓞ **Compatible with G24d, GX24d, G24q & GX24q bases**
- Ⓞ **Innovative round design**
- Ⓞ **Exceptional efficacy 102 LPW**

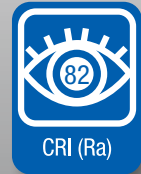

PL PRODUCT FEATURES

BYPass Installation - Electronic Ballasts

This PL V lamp is not compatible with electronic ballasts and requires bypassing the ballast during installation. The lamp runs directly off line voltage to eliminate compatibility problems, incidental power loss, lifetime issues, and maintenance costs associated with ballasts.

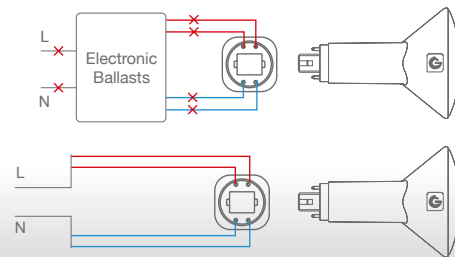

HYBRid Installation - DIRect or BYPass - Magnetic Ballasts

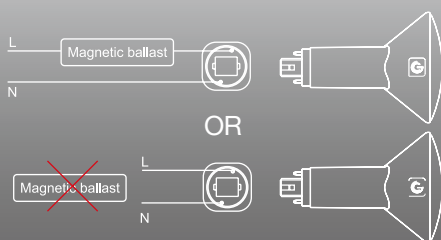

When used with a magnetic ballast, the PL V can function as a plug & play lamp and operate with the existing ballast. If the ballast is not compatible, it can be bypassed and the lamp can run directly off line voltage.

PL V 10W BYP TITANIUM LED SERIES



APPLICATIONS

Retail



Hospitality



Office



- Base:** G24d, GX24d, G24q & GX24q (2/4-pin CFL)
- Voltage:** Magnetic ballast compatible 120-277V
- Dimmable:** No
- PF:** 0.9
- Lifetime (L70):** 50,000 hrs
- Weight:** 0.21lb / 95g

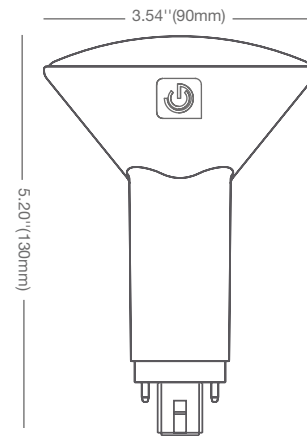

SPECIFICATIONS

Model	Product	Power (W)	CCT	CRI (typ.)	Lumens	LPW	Beam Angle
10PLV/827/BYP	28362	10	Soft White 2700K	82	950	95	120°
10PLV/830/BYP	28363	10	Warm White 3000K	82	1000	100	120°
10PLV/835/BYP	28364	10	Neutral White 3500K	82	1000	100	120°
10PLV/840/BYP	28365	10	Cool White 4000K	82	1020	102	120°

* Suitable for damp locations. Not for use where directly exposed to weather or water

** Not intended for use in enclosed fixtures

*** Full installation guide and more details available on website