



# LED ET8-2150T-12

Part #: ELT8/J/12W/1680/160D/50K/G13/T

Lamp Class: T8 (4 ft.)

5000K  
CCT



Nano-plastic composites deliver splendid light distribution without compromising brightness or producing undesirable glare.



## Product Description

**LED ET8-2150T-12** delivers superior brightness, valuable energy savings and long lasting performance. **EURI™** 4 ft. Bypass Ballast T8 LED lamp is ideal for offices, conference rooms, hotels, academic complexes, research buildings, medical facilities and commercial stores. Built-in driver reduces maintenance expenses while NANO plastic composites deliver splendid light distribution without compromising brightness or generating undesirable glare. Available in 4000K **Bright White** and 5000K **Cool White**. Enjoy features such as: instant on, shatter resistance and mercury free.



## Bypass Ballast

Built-in driver replaces ballast operation reducing significant maintenance expenses.

## Specifications

Input Power	Input Voltage	Lumen Output	Beam Angle	Center Beam	CCT
12 W	AC100-277 V	1680 lm	160°	N/A	5000 K

CRI	Luminous Efficacy	Power Factor	Input Current	Base/Cap	Lamp Lifespan
80	140 lm/W	0.9	0.05 A	G13	50,000 Hrs.

## Product Features



Non-Dimmable



Instant-On/Off



Mercury Free



Energy Efficient

## Product Dimensions

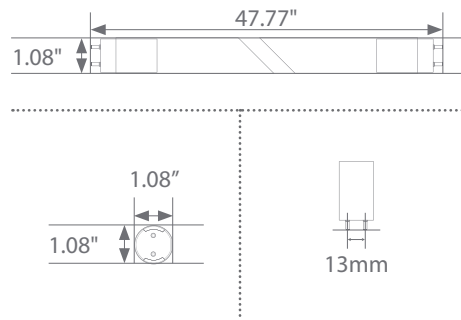

## Product Photometric Data

