

TROFFER 36W 1X4' TITANIUM LED SERIES



PRO



- ⌚ Exceptional efficacy 98 LPW in Cool White CCT
- ⌚ High performance lighting distribution and low glare lens
- ⌚ 120-277V circuit and 0-10V dimming control compatible
- ⌚ Modern look and high quality architectural finish
- ⌚ Easy installation for new construction or retrofit
- ⌚ Extra long L85 50,000 hour lifetime

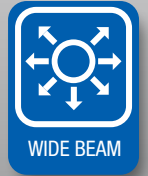

EFFICIENCY AT WORK



INSTALLATION GUIDE

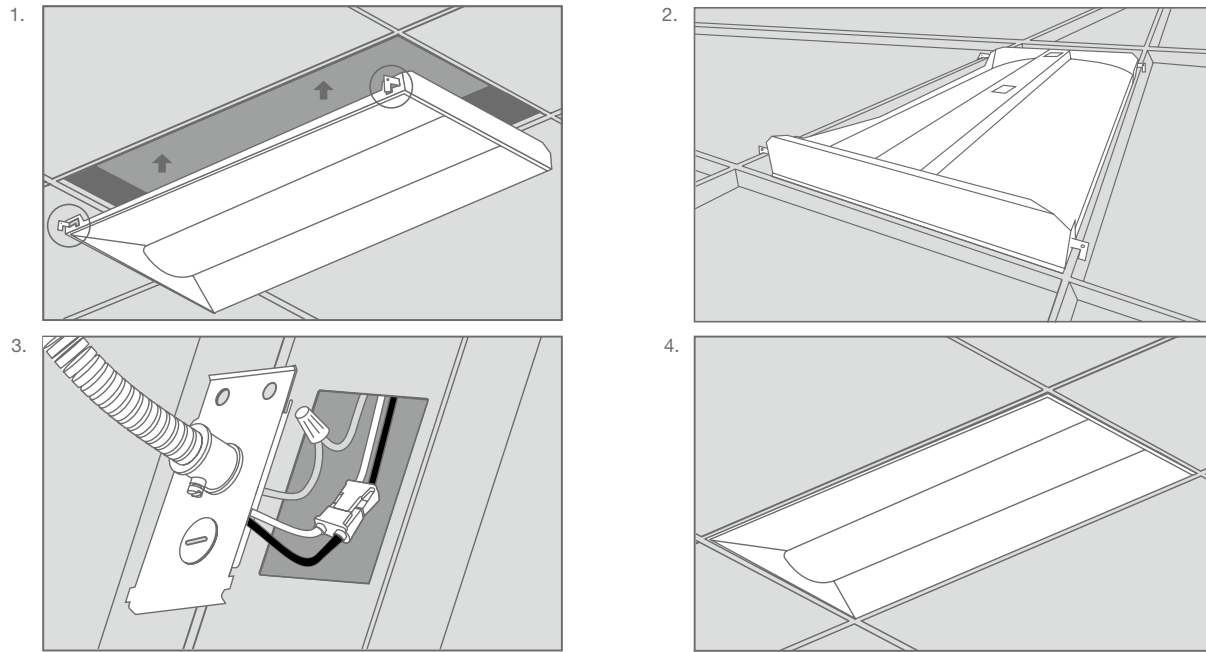

TROFFER INSTALLATION

- Step 1.** Make sure the **POWER IS TURNED OFF** at the source to the location at which you are installing the product.
- Step 2.** Remove existing troffer if applicable.
- Step 3.** Pull L tabs out on each corner. (fig. 1)
- Step 4.** Place troffer in ceiling making sure each L tab is securely hooked on T-bar grid. (fig. 1 & fig. 2)
- Step 5.** Remove power conduit plate. Insert power supply into power conduit plate using appropriate electrical fittings. (fig. 3)
- Step 6.** Return power back to the source and installation is complete. (fig. 4)

SPECIFICATIONS

| Product Model | 58003 36TROF14DIM/830/277V (MTO) | 57995 36TROF14DIM/835/277V | 57996 36TROF14DIM/840/277V | 58004 36TROF14DIM/850/277V (MTO) |
|------------------------------------|--|------------------------------------|------------------------------------|--|
| Type | 1x4' Troffer | 1x4' Troffer | 1x4' Troffer | 1x4' Troffer |
| Power (W) | 36 | 36 | 36 | 36 |
| Voltage - Frequency | 120-277V 50-60Hz | 120-277V 50-60Hz | 120-277V 50-60Hz | 120-277V 50-60Hz |
| Color Temp. (ANSI) | Warm White 3000K | Neutral White 3500K | Cool White 4000K | Daylight 5000K |
| CRI (Ra) | 82 | 82 | 82 | 82 |
| Typical lumens (lm) | 3320 | 3440 | 3510 | 3650 |
| Efficacy (LPW) | 92 | 96 | 98 | 101 |
| Beam Angle | 120° | 120° | 120° | 120° |
| Dimmable | Yes | Yes | Yes | Yes |
| Power Factor | 0.9 | 0.9 | 0.9 | 0.9 |
| THD | <20% | <20% | <20% | <20% |
| Rated Lifetime - L85 (hrs.) | 50,000 | 50,000 | 50,000 | 50,000 |
| L x W x H | 47.71"x11.73"x3.35"(1212x298x85mm) | 47.71"x11.73"x3.35"(1212x298x85mm) | 47.71"x11.73"x3.35"(1212x298x85mm) | 47.71"x11.73"x3.35"(1212x298x85mm) |
| Weight (lb. / g) | 11.22lb. / 5.10kg | 11.22lb. / 5.10kg | 11.22lb. / 5.10kg | 11.22lb. / 5.10kg |

* Suitable for damp locations. Not for use where directly exposed to the weather or water

ORDERING INFORMATION

| Model | Description | Instructions |
|-----------------|---------------------------|--|
| /STEPDIM | Step Dimming Module 50/50 | To order this option add /STEPDIM after the model number |
| /EM | Emergency LED Driver 10W | To order this option add /EM after the model number |

Example: 36TROF14DIM/835/277V/STEPDIM

Note: To order the emergency LED driver and step dimming module add both: ex. 36TROF14DIM/835/277V/STEPDIM/EM