

1. General

| Model | Rated voltage | Rated frequency | Rated current | Rated power | IP Class | Type of electricity protection |
|-------|---------------|-----------------|---------------|-------------|----------|--------------------------------|
| WL-3C | AC220-240V | 50-60Hz | 8A | 1920W | IP20 | I |
| WL-3C | AC100-120V | 50-60Hz | 8A | 960W | IP20 | I |
| WL-3C | AC24V | 50-60Hz | 8A | 192W | IP20 | I |
| WL-3C | AC12V | 50-60Hz | 8A | 96W | IP20 | I |

Note: Please refer to the label for the details.

2. Operation Instruction

- 1.Plug the power plug to power outlet and make sure both have the same rating.
- 2.Turn controller to ON position, ropelight will start working.
3. Turn the Mode button to choose a desired pattern, there are Eight choices. Operating effects are as follows:
 - 3.1. Static illuminating;
 - 3.2. Circle A Flashing;
 - 3.3. Circle B Flashing;
 - 3.4. Chasing;
 - 3.5. Flashing;
 - 3.6. Chasing Flash.
 - 3.7. AABB Flashing
 - 3.8. Automatic cycle
- 4.Turn speed button to adjust speed. The speed changes from slow to fast when turning clockwise; otherwise the speed will slower.
- 5.Control panel introduction.
 ON,OFF: power switch.
 SPEED: speed control switch.
 MODE: function selection switch.

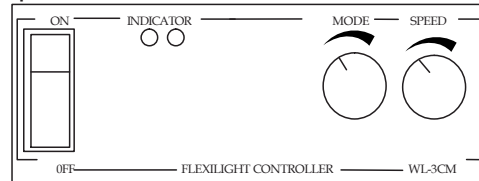

3. Warning

- 1.Rated voltage of power outlet must be the same as input voltage of the controller.
- 2.The loading current of the lighting must not exceed 8A.
- 3.Do Not use in water or in the environment that burn or explode easily. It must be used in ventilated environment.
- 4.Do Not use anything to cover the controller in order to dissipate heat when you use it.
5. For indoor use only
- 6.Keep out of reach from children or use when adult is present.

4. Instructions to Use

I.Check the rope light (Refer to diagram 2)

- a. Check the voltage of the rope light to see if it matches with the voltage of the controller(connection is only possible under the same voltage).

- b. Measure the length of the rope light, its length cannot exceed the maximum loading length. Cut the rope light according to the Cutting Mark as indicated on the rope light. Make sure that all split ends are cut at the given marking.
- c. Bend both ends of the rope light to show 2~3mm of the wire. Use a pair of scissors to cut away the split ends. Make sure that all split ends are cut away neatly; or else it will cause a short circuit and possibly burn the controller.
- d. Cover the end of rope light with an appropriate End Cap and seal with silicone adhesive and tie with a tie strap for insulation. The other end of the rope light can be joined to a power cord.

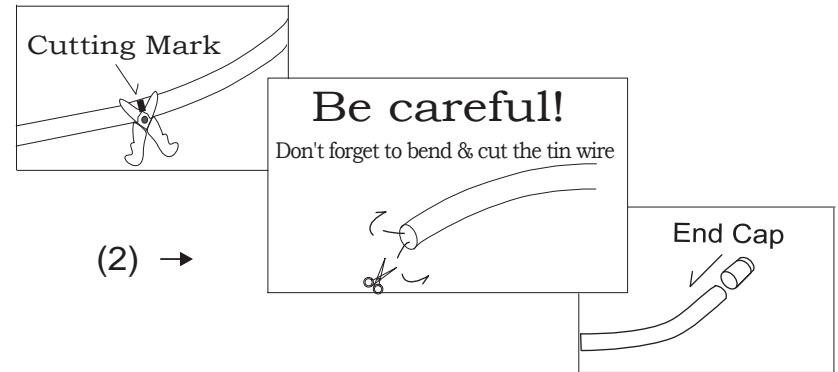

II. Connecting to Power Source

There are five ways to connect the controller power output to the rope light. Please check the accessories carefully and install in the right way.

Method1:Spiral Connection:(Refer to diagram3)

- a. Put the spiral nut (No.4) with thread onto one end of the rope light.
- b. Insert the splice connector pin(No.3) into the inner wires of the rope light vertically.
- c. After the insertion is done, tighten the spiral nut.
- d. Connect the splice connector crimp (No.2) with the wire connector, then tighten the spiral nut (No.1).

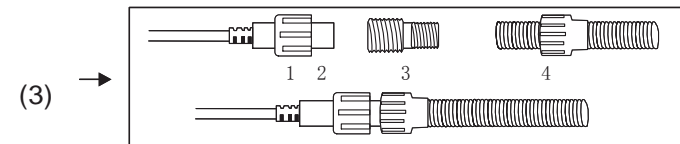

(Caution: This way is only for indoor use.)

Method2:Housing Clamp Connection:(Refer to diagram 4)

- a. Insert the splice connector pin into the inner wires of the rope light; then insert the splice connector crimp into the holes of the female power connector.
- b. Place the splice connector at the center compartment of the housing clamp female cover, apply glue thoroughly to 100% insulate splice connector, rope light and power connector
- c. Cover the female portion by male portion of housing clamp and tighten all screws.

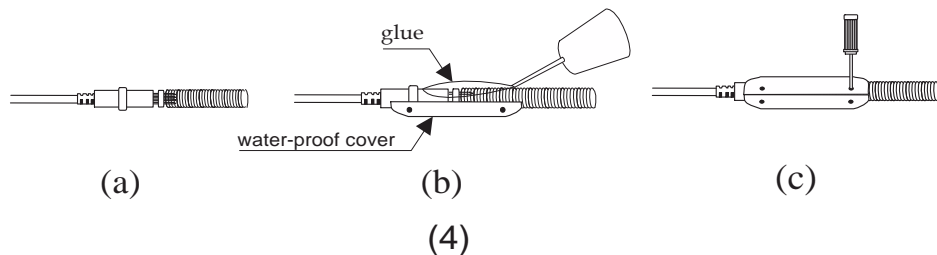

Method3:PVC Power Supply Connector Connection:

Make sure that the rope light which to be joined with the connector is not connected with any electricity & was cut nearly as instruction cutting rope light stated.

- a. Insert the male pin connector into center of the tubes of the rope light. The male pin & the rope light must run straightly.

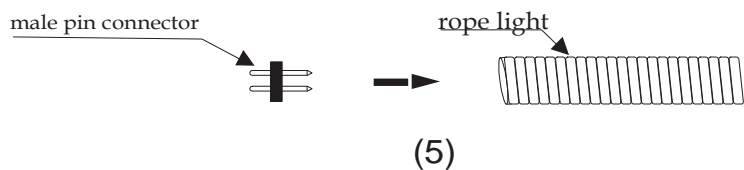

- b. Place the shrinkable tube over the rope light.
- c. Apply glue (around 3cm long from the end of the rope light) on the ropelight. Now push the rope light into the power supply so that the connector pins completely disappear into the sockets. Leave the glue dry before continuing installation.

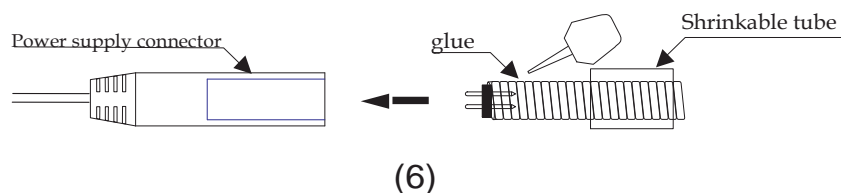

- d. Push half of the shrinkable tube over the power supply connector & half over the rope light & heat it up.

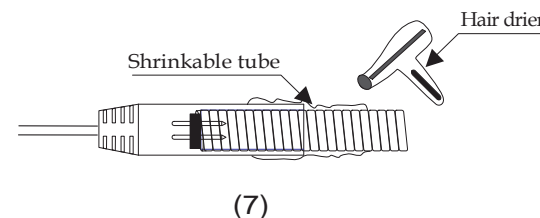

(Notice:) Connectors and joints can only withstand a limited amount of mechanical pressure.

Method4: Injection Molding Connection:

As the controller and the rope light have been connected by the plastic injection connector, the user may only plug the controller's power plug to the right power outlet and begin to use.

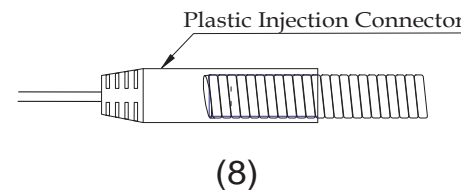

Method5:Light String Connection:

This controller also has the control effect on these products like : flexi-curtain, pearl light, shell light, icicle light, rattan flexi-star which are produced in our factory. The connecting method for the light string and the output connector of the controller is very simple :you only need to connect the output female connector with the male connector on the light string.

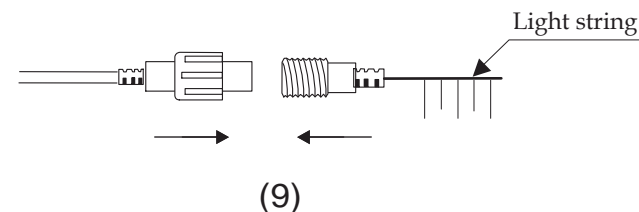

Our company has always put design and quality of our products in first priority. Should there be any changes, there will not be any notifications.