

# CIVILIGHT®

**FOR YOUR SAFETY, PLEASE READ AND UNDERSTAND THE INSTRUCTIONS COMPLETELY BEFORE BEGINNING INSTALLATION.**

## LED RETROFIT 5"/ 6" DOWNLIGHT INSTALLATION INSTRUCTIONS

Suitable for CUD216-52108, CUD216-52111, CUD216-52112, CUD216-52113, CUD216-52114, CUD216-52115, CUD216-52116, CUD216-52117, CUD216-52118, CUD216-52119, CUD216-52120, CUD216-52121, CUD216-52122, CUD216-52123

1



Turn off power to recessed fixture at circuit breaker.

2

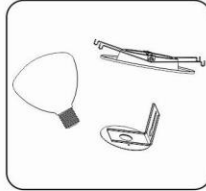

Remove existing trim, cover and bulb from the recessed fixture to reveal the existing socket.

3

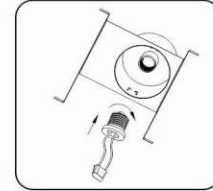

Disconnect the adaptor (E26 or GU24) from the LED downlight and screw into the socket in recessed housing by turning clockwise.

4

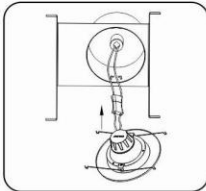

Plug the adaptor connector into LED downlight.

5

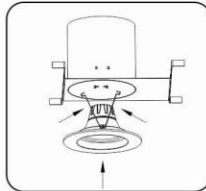

Squeeze torsion springs together as shown and install into torsion spring brackets inside recessed housing.

6

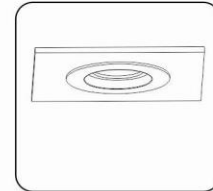

Carefully route wires into fixture (no wires are exposed) and push LED downlight up to flush with the ceiling surface, then power on.

# CIVILIGHT®

**FOR YOUR SAFETY, PLEASE READ AND UNDERSTAND THE INSTRUCTIONS COMPLETELY BEFORE BEGINNING INSTALLATION.**

## LED RETROFIT 5"/ 6" DOWNLIGHT INSTALLATION INSTRUCTIONS

Suitable for CUD216-52108, CUD216-52111, CUD216-52112, CUD216-52113, CUD216-52114, CUD216-52115, CUD216-52116, CUD216-52117, CUD216-52118, CUD216-52119, CUD216-52120, CUD216-52121, CUD216-52122, CUD216-52123

**WARNING** – Risk of fire or electric shock. Luminaire wiring and electrical parts may be damaged when drilling for installation of LED retrofit kit. Check for enclosed wiring and components.

**WARNING** – Risk of fire or electric shock. LED Retrofit Kit installation requires knowledge of luminaires electrical systems. If not qualified, do not attempt installation. Contact a qualified electrician.

**WARNING** – Risk of fire or electric shock. Install this kit only in the luminaires that have the construction features and dimensions shown in the photographs and/or drawings.

**WARNING** – To prevent wiring damage or abrasion, do not expose wiring to edges of sheet metal or other sharp objects.

**DO NOT MAKE OR ALTER ANY OPEN HOLES IN AN ENCLOSURE OF WIRING OR ELECTRICAL COMPONENTS DURING KIT INSTALLATION.**

**THIS LUMINAIRE HAS BEEN MODIFIED AND CAN NO LONGER OPERATE THE ORIGINALLY INTENDED LAMP.**

Contact Civilight at 919.234.0853  
[www.civilight-na.com](http://www.civilight-na.com)