

Catalog Number
Notes
Type

FEATURES & SPECIFICATIONS

INTENDED USE — LED downlight for retrofit of installed 8" nominal commercial "pan-style" housings with incandescent, compact fluorescent (CFL), or high intensity discharge (HID) sources. Compatible aperture range is 7-3/4" to 8-7/8". All installation can be performed from the room side without removing the existing fixture. Multiple lumen packages to replace the installed base of CFL or HID sources with energy savings up to 50%. See Lumen Equivalency Chart.

CONSTRUCTION — Innovative housing design that simultaneously retains and centers the fixture in the existing mounting pan.

OPTICS — LED light source with diffuse lens recessed in a reflector with a 55-degree cutoff. Aluminum full reflectors are optically designed to maximize lumen output and to provide superior glare control.

Anodized trim colors for open reflectors are clear diffuse, pewter or wheat. White polyester powder coat also available.

Minimum CRI of 80.

ELECTRICAL — Proprietary electrical design allows for excellent line voltage dimming down to 10% light output on 120V product. The zero inrush design enables maximum loading of incandescent dimmers. This enables customers to add dimming at a low cost without pulling additional wires. For compatible dimmers and dimming range, refer to Dimmer Compatibility Chart.

The system maintains 70% lumen output at more than 60,000 hours.

LISTINGS — CSA certified to US and Canadian safety standards. Wet location listed. ENERGY STAR® certified.

WARRANTY — 5-year limited warranty. Complete warranty terms located at www.acuitybrands.com/CustomerResources/Terms_and_conditions.aspx

Note: Actual performance may differ as a result of end-user environment and application.

All values are design or typical values, measured under laboratory conditions at 25 °C.

Specifications subject to change without notice.

RV8 LED

**8" OPEN LED
Non-IC
Retrofit Downlight**

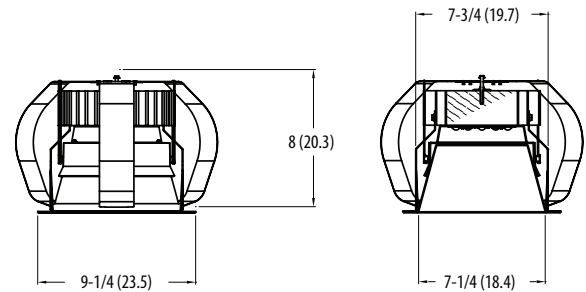
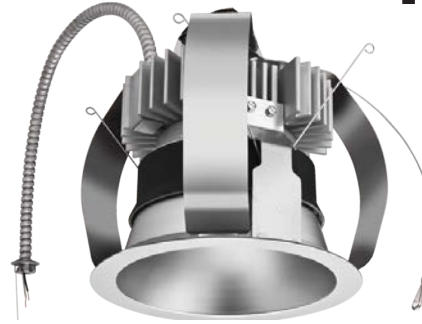

Specifications

Aperture:	7-1/4 (18.4)	Max. frame aperture:	8-7/8 (22.5)
Overlap trim:	9-1/4 (23.5)	Min. frame aperture:	7-3/4 (19.7)
Height:	8 (20.3)	Max. ceiling thickness:	2 (5.1)
Length:	9 (22.9)		

All dimensions are inches (centimeters) unless otherwise indicated.

LUMEN EQUIVALENCY CHART			
	Delivered lumen values		
	2000	2500	3000
Approximate LED wattage	26W	34W	42W
Comparable fluorescent	1/42W CFL 2/26W CFL	2/32W CFL	> 2/32W CFL
Comparable HID	N/A	50W ED17	70W ED17
Comparable incandescent	200W A21	N/A	300W BR40
Comparable halogen PAR	100W	N/A	N/A

ORDERING INFORMATION

Lead times will vary depending on options selected. Consult with your sales representative.

Example: RV8 35/30 R08AR 120

RV8 Series	Color temperature	Lumens	Reflector	Trim color	Finish	Voltage	Options
RV8	27/ 2700 K	20 2000 lumens ¹	R08 Downlight	AR Clear	(blank) Semi-specular	120	TRW White painted flange
	30/ 3000 K	25 2500 lumens ¹	RW8 Wallwash	PR Pewter	LD Matte-diffuse	277	TRBL Black painted flange
	35/ 3500 K	30 3000 lumens ¹		WTR Wheat	LS Specular		
	40/ 4000 K			WR White ²			

Accessories: Order as separate catalog number.

EAC ISSM 375	Compact interruptible emergency AC power system
EAC ISSM 125	Compact interruptible emergency AC power system
RK2 SDT 347277120 395VA AD JZ	347V step down transformer mounted in box installed by others
GRA810 JZ	Oversized trim ring with 10" outside diameter. Refer to TECH-GOOF RINGS for more options.
RV8RGIN	8" rough-in frame. Refer to RV ROUGH-IN FRAMES .
RV8RGIN IFB	8" install from below, rough-in frame. Refer to RV ROUGH-IN FRAMES .

Notes

1 Approximate lumen output.

2 Not available with finishes.

RV8 LED

PHOTOMETRICS

Distribution Curve

Distribution Data

Output Data

Coefficient of Utilization

Illuminance Data at 30" Above Floor for a Single Luminaire

RV8 35/20 120 R08AR, input watts: 26 , delivered lumens: 1768, LM/W = 68, test no. LTL23512.

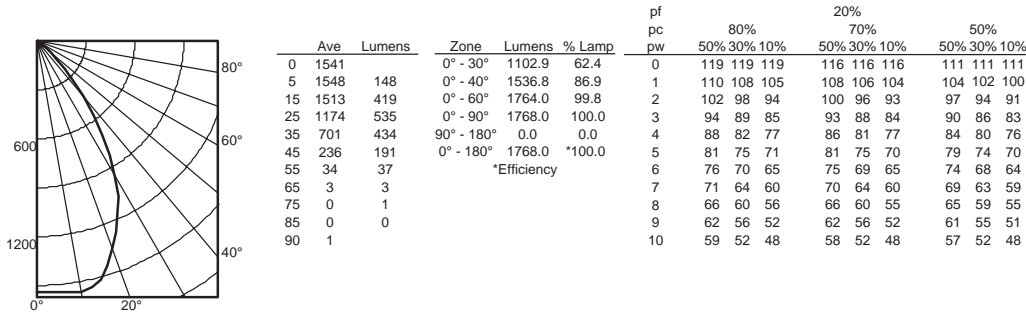

RV8 35/30 120 R08AR, input watts: 42 , delivered lumens: 2803, LM/W = 68, test no. LTL23505.

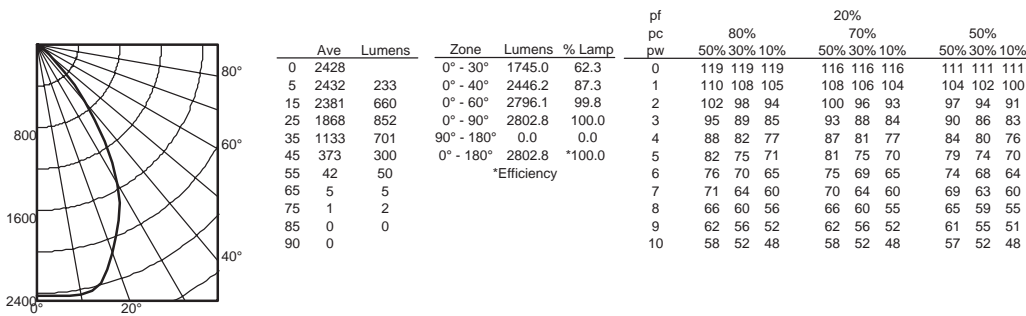

RV8 35/30 277 R08AR, input watts: 44 , delivered lumens: 2980, LM/W = 68, test no. LTL24235.

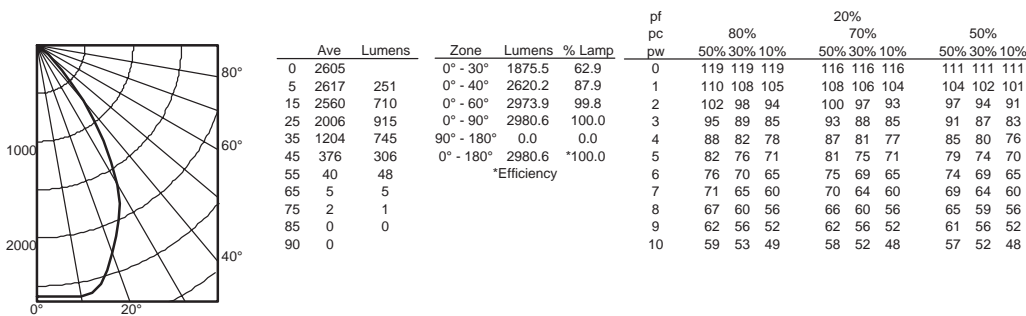

RV8 35/20 277 R08AR, input watts: 29 , delivered lumens: 2192, LM/W = 75, test no. LTL24233.

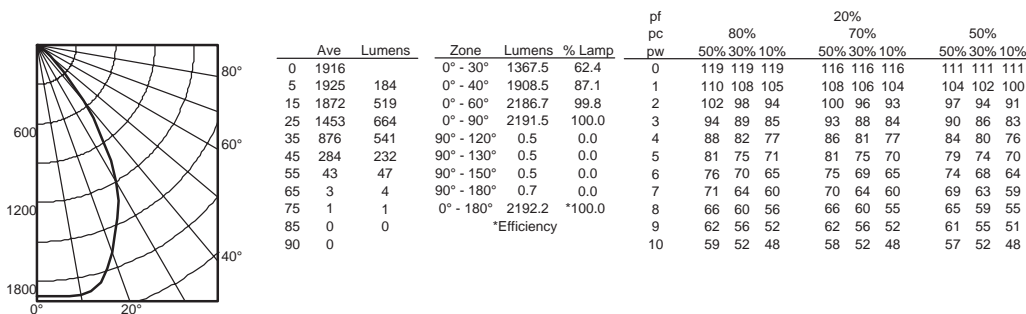

Notes

- Tested in accordance with IESNA LM-79-08.
- Tested to current IES and NEMA standards under stabilized laboratory conditions.
- CRI: 84 typical.

RV8 LED

ADDITIONAL DATA

Color temperature	Lumen multiplier
27K	0.94
30K	0.98
35K	1.00 (baseline)
40K	1.02

Trim finish	Lumen multiplier
Clear semi-specular (AR)	1.00 (baseline)
Clear specular (LS)	1.02
Clear matte-diffuse (LD)	0.93
Pewter (PR)	0.88
Wheat (WTR)	0.92
White (WR)	0.96

ENERGY DATA*	
Min. operating temp	-18°C (0°F)
Max. operating temp	45°C (113°F)
Min. power factor	0.98
Input frequency	50/60 Hz
*Values at non-dimming line voltage.	

ELECTRICAL DATA*		
Lumen package	Input current	
	120V	277V
2000 lm	0.22 A	0.10 A
2500 lm	0.10 A	0.14 A
3000 lm	0.36 A	0.16 A
* Values at non-dimming line voltage.		

DIMMER COMPATIBILITY CHART			
Manufacturer	Model/Series	Part numbers	Comments
Sensor Switch	nlight	nSP5 PCD 2W	
Lutron	Diva C-L	DVCL-153P	
	Diva	DVELV-300P	
	Diva	DVELV-600P	
	Skylark Contour	CT-603P	
	Skylark Contour C-L	CTCL-153P	
Leviton	Decora	6674-P	
	Decora	6633P	
	IlumaTech™	IPX06-70Z (for 277V)	Dims to 40%
	TRIMATRON	6681++	
	TRIMATRON	6684++	
++ Must have at least 40W on dimmer circuit.			