

## LED T8 - Linear Replacement Lamp

### L SERIES



### PRODUCT DESCRIPTION:

MaxLite LED T8 Linear Replacement Lamps are the ideal energy saving choices when upgrading traditional linear T8 or T12 fluorescent lamps in fixtures containing standard G13 (medium bi-pin) sockets. The LED T8 lamps are designed to provide appropriate light levels while utilizing a dedicated internal driver and require non-shunted G13 medium bi-pin lamp holders.

### FEATURES:

- 2' & 4' lamps are DesignLights Consortium® (DLC) qualified
- Universal voltage: 120V-277V applications
- Color Rendering Index (CRI): ≥82
- 50,000 hour life, 100,000 hours (10 years warranty)
- THD <20%
- High power factor: ≥.90
- Easy retrofit into most common linear fluorescent fixtures
- Simple ballast bypass
- Instant on
- Mercury free and virtually no UV or IR light
- Non dimmable
- Suitable for enclosed fixture
- Half aluminum, half plastic construction
- Five year limited warranty (10 Year optional)



Scan QR Code to view Installation Video  
or visit the following link: <http://bit.ly/T8InstallationVideo>

MODEL SELECTION (Full list of order codes on pg. 3)		Typical order example: L18T8SE441				
L		T8	SE			
FAMILY	WATTAGE	LAMP TYPE	POWER CONNECTION	LENGTH	CCT	WARRANTY
L= LED Linear	<b>10=</b> 10W (2FT & 3FT only) <b>15=</b> 15W (4FT only) <b>18=</b> 18W (4FT only) <b>22=</b> 22W (4FT & 5FT only) <b>31=</b> 31W (6FT only)	T8= T8 tube	SE= Single end	<b>2=</b> 2 FT <b>3=</b> 3 FT <b>4=</b> 4 FT <b>5=</b> 5 FT <b>6=</b> 6 FT	<b>35=</b> 3500K <b>41=</b> 4100K <b>50=</b> 5000K <b>65=</b> 6500K	<b>(OMIT)=</b> 5 Years <b>-10=</b> 10 Years

ACCESSORIES			
ORDER CODE	MODEL NUMBER	DESCRIPTION	ACCESSORIES IMAGE
73978	G13LPNS	G13 Low Profile Non-Shunted Lamp Holder	

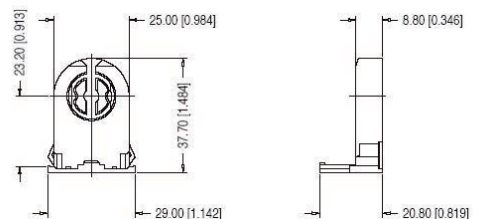

**SPECIFICATIONS:**

		2 - FOOT	3 - FOOT	4 - FOOT		5 - FOOT	6 - FOOT	
ITEM	SPECIFICATION	DETAILS						
GENERAL PERFORMANCE	Power Consumption	10W	10W	15W	18W	22W	22W	31W
	Lumens Delivered	1,050	1,080	1575	1,950	2,300	2,300	3,250
	Efficacy	105 lm/w	108 lm/w	105 lm/w	108 lm/w	105 lm/w	105 lm/w	105 lm/w
	CRI	≥82						
	Beam Angle	120°						
	Color Temperature (CCT)	3500K, 4100K, 5000K, 6500K						
	Lumen Maintenance (L70)	50,000 hours, 100,000 hours (10 years warranty)						
ELECTRICAL	Power Factor	Over 90%						
	Input Voltage	120V-277V 50/60 Hz						
PHYSICAL	Operating Temperature	-4°F to 122°F						
	Lens	Frosted						
CERTIFICATION	Certification	Classified UL, LM79, LM80, DLC (2FT & 4FT only)						
	Material Usage	RoHS compliant; no mercury						
	Environment	Dry & Damp						
	Warranty	5 Years, 10 Years (Optional)						

Lighting layouts and spacing criteria available upon request

**ORDERING:**

ORDER CODE	MODEL	WATTS	LENGTH	CCT	WARRANTY	DIMENSIONS (L" x DIA")
73949	L10T8SE235	10	2FT	3500K	5 Years	23.75" x 1.29"
73950	L10T8SE241	10	2FT	4100K	5 Years	23.75" x 1.29"
73951	L10T8SE250	10	2FT	5000K	5 Years	23.75" x 1.29"
73952	L10T8SE341	10	3FT	4100K	5 Years	35.75" x 1.29"
75184	L15T8SE435	15	4FT	3500K	5 Years	47.75" x 1.29"
73979	L15T8SE441	15	4FT	4100K	5 Years	47.75" x 1.29"
73980	L15T8SE450	15	4FT	5000K	5 Years	47.75" x 1.29"
74109	L15T8SE441-10	15	4FT	4100K	10 Years	47.75" x 1.29"
74097	L15T8SE450-10	15	4FT	5000K	10 Years	47.75" x 1.29"
75210	L18T8SE430	18	4FT	3000K	5 Years	47.75" x 1.29"
73557	L18T8SE435	18	4FT	3500K	5 Years	47.75" x 1.29"
72842	L18T8SE441	18	4FT	4100K	5 Years	47.75" x 1.29"
72841	L18T8SE450	18	4FT	5000K	5 Years	47.75" x 1.29"
74175	L18T8SE465	18	4FT	6500K	5 Years	47.75" x 1.29"
73946	L18T8SE435-10	18	4FT	3500K	10 Years	47.75" x 1.29"
73947	L18T8SE441-10	18	4FT	4100K	10 Years	47.75" x 1.29"
73948	L18T8SE450-10	18	4FT	5000K	10 Years	47.75" x 1.29"
73944	L22T8SE441	22	4FT	4100K	5 Years	47.75" x 1.29"
73945	L22T8SE450	22	4FT	5000K	5 Years	47.75" x 1.29"
73953	L22T8SE541	22	5FT	4100K	5 Years	59.75" x 1.29"
73954*	L31T8SE641	31	6FT	4100K	5 Years	70.13" x 1.29"

\* Special order only