

PJ2-2B PJ2-2BRL PJ2-3B PJ2-3BRL

Mounting accessories sold separately.

For a complete listing of Pico[®] wireless mounting accessories, please visit www.lutron.com/pico

Important Notes

Please Read Before Installing

- This install guide provides simple setup instructions for Maestro Wireless[®] systems only. If you are using your Pico[®] wireless control with any other Lutron[®] system, please refer to the system setup guide. If you no longer have your system setup guide, please download the latest version by following the links at www.lutron.com/pico**
 - The Pico[®] wireless control uses one (1) CR2032 battery (pre-installed). **DO NOT** use rechargeable batteries. Using improper batteries could damage the Pico[®] wireless control. **DO NOT** dispose of the battery in normal household waste. Please recycle, take to a proper battery disposal facility, or contact your local waste disposal provider regarding local restrictions on the disposal or recycling of batteries.
-  **Warning: Risk of fire, explosion and burns. May result in serious injury or death. DO NOT** recharge, disassemble, crush, puncture, heat above 212 °F (100 °C) or incinerate the battery. The battery in this device contains Perchlorate Material - special handling may apply. For more information visit www.dtsc.ca.gov/hazardouswaste/perchlorate
- The Pico[®] wireless control must be paired with dimmer(s)/switch(es) before it can communicate.
 - Up to 10 Pico[®] wireless controls can be configured to work together in a Maestro Wireless[®] system.
 - The range of the Pico[®] wireless control is 30 ft (9 m). Performance is highly dependent on a variety of complex factors such as:
 - Distance between system components
 - Geometry of the building structure
 - Construction of walls separating system components
 - Electrical equipment located near system components
 - Clean Pico[®] wireless control with a soft damp cloth only. DO NOT** use any chemical cleaners.
 - DO NOT** paint the Pico[®] wireless controller.
 - DO NOT** mount the Pico[®] wireless controller to a metal surface.

Set-Up (for Maestro Wireless[®] systems only)

To communicate with other systems or devices, including Radio RA[®] 2, QS sensor module (QSM), Quantum[®], Homeworks[®] QS, Serena Shades, and Sivoia[®] QS, refer to the system setup guides. See www.lutron.com/pico for more information.

Important: Set up a Pico[®] wireless control to a dimmer / switch before use.

- Press and hold the dimmer/switch tap button (Figure 1) for approximately 6 seconds. Once the LED(s) start to blink slowly, release the tap button.
- Press and hold the **OFF** button on the Pico[®] wireless controller (Figure 2) for approximately 6 seconds.
- Once the dimmer/switch pairs with the Pico[®] wireless control, the LED(s) on the dimmer/switch and the load will flash 3 times and it will exit Set-Up mode.
- Repeat steps 1 to 3 to pair multiple Pico[®] wireless controls with a single dimmer / switch. Repeat steps 1 to 3 to pair a single Pico[®] wireless control with multiple dimmers / switches.
- Pressing the **Preset** button (3B and 3BRL models only) on a Pico[®] wireless control will cause all dimmers to go to the favorite light settings. Switches can be configured to turn **ON** or **OFF**. To save a favorite light setting, adjust all the dimmers/switches controlled by a Pico[®] wireless control to the desired light setting. Then press and hold the **Preset** button on the Pico[®] wireless control for 6 seconds until all LEDs on the dimmers/switches flash several times.

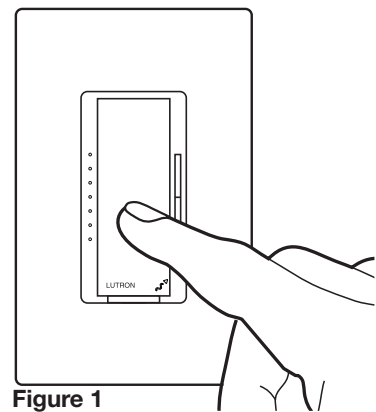

Figure 1

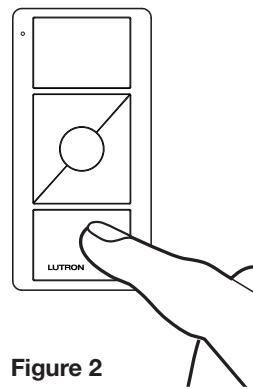
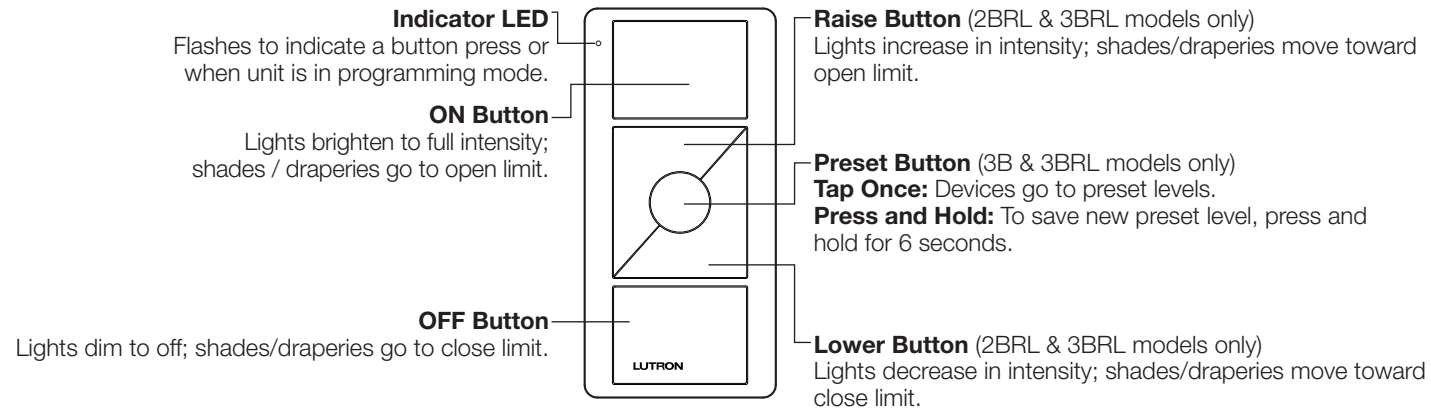

Figure 2

Wireless Control of Multiple Switches

If multiple wireless dimmers/switches are paired with the same Pico[®] wireless control, they will perform as follows:

- Pressing the **ON** button on the Pico[®] wireless control will cause all dimmers/switches to turn ON fully.
- Pressing the **OFF** button on the Pico[®] wireless control will cause all dimmers/switches to turn OFF completely.
- Pressing the **Raise** button (2BRL and 3BRL models only) on a Pico[®] wireless control will cause all dimmers to turn **ON** and gradually increase in intensity.
- Pressing the **Lower** button (2BRL and 3BRL models only) on a Pico[®] wireless control will cause all dimmers to gradually decrease in intensity. The dimmers will not turn off and will remain at low end.
- Pressing the **Preset** button (3B and 3BRL models only) on a Pico[®] wireless control will cause all dimmers to return to the favorite light settings. Switches can be configured to go to **ON** or **OFF**. (See Step 5 in **Set-Up**)

Operation**Un-pairing a Pico[®] Wireless Control**

(for Maestro Wireless[®] systems only)

To un-pair a previously paired Pico[®] wireless control from your system, tap the **OFF** button (Figure 2) on the Pico[®] wireless control three times, on the third tap hold for 6 seconds and then tap three more times. This will remove all dimmers/switches it was previously paired with.

Replacing the Battery in a Pico[®] Wireless Controller

- Place a flathead screwdriver into the slot at the bottom of the Pico[®] wireless control. Twist to open. **DO NOT** press buttons without back enclosure on.
- Slide the battery out, toward the top of the Pico[®] wireless control.
- Slide a new battery underneath the contact strap, with the (-) terminal toward the front of the Pico[®] wireless control.
- Replace the back enclosure.
- Confirm proper installation by turning the receiving device on and off using the Pico[®] wireless control.

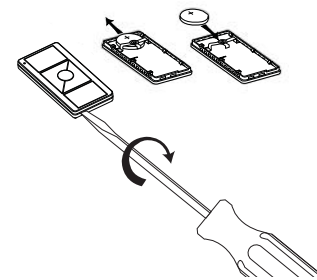
**Technical Assistance**

www.lutron.com

World Headquarters

For questions concerning the installation or operation of this product, call the Lutron Technical Support Center. Please provide exact model number when calling.

TEL +1.610.282.3800

FAX +1.610.282.1243

Toll Free 1.888.LUTRON1

USA, Canada, Caribbean 1.800.523.9466

Mexico +1.888.235.2910

Central/South America +1.610.282.6701

European Headquarters**United Kingdom**

Lutron EA Ltd.

TEL: +44.(0)20.7702.0657

FAX: +44.(0)20.7480.6899

Technical Support: +44.

(0)20.7680.4481

Freephone: 0800.282.107

www.lutron.com/europe

Asian Headquarters

Singapore

TEL +65.6220.4666

FAX +65.6220.4333

Asia Technical Hotlines

Northern China 10.800.712.1536

Southern China 10.800.120.1536

Hong Kong 800.901.849

India +91.11.4051.4300

Indonesia 001.803.011.3994

Japan +81.3.5575.8411

Macau 0800.401

Singapore 800.120.4491

Taiwan 00.801.137.737

Thailand 001.800.120.665853

Other countries +65.6220.4666

Troubleshooting

Symptoms	Possible Causes
Light does not respond to Pico [®] wireless controller	<ul style="list-style-type: none"> The dimmer/switch failed to pair with Pico[®] wireless control; see Set-Up. The dimmer/switch has already received and responded to a command or is already at the light setting the Pico[®] wireless control is sending. The Pico[®] wireless control is outside the 30 ft (9 m) operating range. The battery in the Pico[®] wireless control is low. The battery in the Pico[®] wireless control is installed incorrectly.
When in set-up mode the LEDs on the dimmer/switch flash when trying to setup with the Pico [®] wireless controller or sensor.	<ul style="list-style-type: none"> The maximum number of Pico[®] wireless controls or sensors have been paired with the dimmer/switch. More Pico[®] wireless controls or sensors can not be added. See Un-pairing a Pico[®] Wireless Control.