

## Cree GU24WHIPADAPTER - For LR6 Series Retrofit Downlight

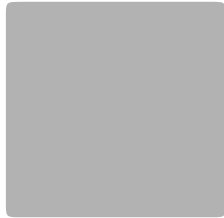

**GU24 INSTALLATION** (WHERE REQUIRED)

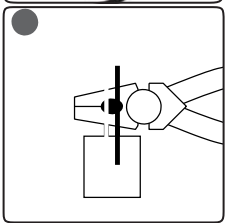
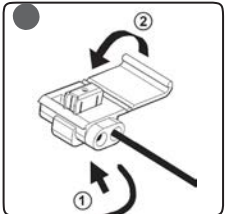

**STEP A: Remove GU24 connector cable from package.**

**STEP B: To assemble GU24 whip (shown above) cut wires on back side of existing socket. No stripping is required from remaining leads.**

**STEP C: Insert the input wires into the Insulation Displacement Connectors provided on the GU24 socket whip and clamp down on the metal U-connector until flush with the top of the plastic insulator.**

**STEP D: Close plastic hinged cover and snap lock.**

**STEP E: Place “Original Luminaire Modification Marking” label inside recessed housing adjacent to existing relamp label.**

**STEP F: Continue with recessed conversion installation.**