

SURGE PROTECTION DEVICE

Input Voltage	120 - 277Vac, 60Hz
Enclosure Material	Polycarbonate
Input Leads	6", 18AWG stranded, 105 degree C stripped 3/8" tinned

OPERATION :

- The LSP Series are 3-leaded devices that protect Line-Ground, Line-Neutral, and Neutral-Ground in accordance with IEEE / ANSI C62.41.2 guidelines
- Protects against surges according to IEEE C62.41.2 C High (10kA and 10kV)
- Surge current rating = 10,000 Amps using industry standard 8/20 μ Sec wave
- Surge Location Rated Category C3
- UL Recognized Component in the United States and Canada (UL1449)
- Type 4 Surge Protection Device
- High temperature, flame retardant plastic enclosure, 85°C maximum surface temperature rating
- Thermally Protected Transient Over-voltage Circuit

APPROVALS :



Hatch Surge Protector Features



MOUNTING

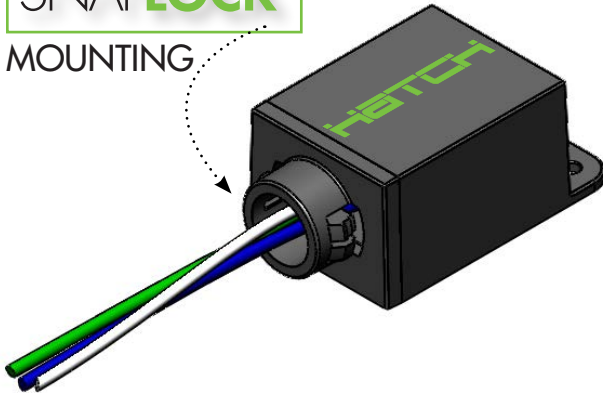

- One step secure mounting to a 3/4" standard electrical Knockout
- Eliminates need for lock nuts - quick and easy installation
- One hand installation
- No tools required

MODEL NUMBER : LSP10-SM

Model Number	Nominal Input	Surge Protection Level	Mounting
LSP10-SM	120-277 VAC	10 kV, 10 kA, ANSI C62.41 Category C	SNAPLOCK™ /Footed

The LSP series of products are designed to be used in conjunction with LED Drivers and fixtures to provide an additional level of protection against powerline disturbances in industrial, commercial and residential applications where surge protection to IEEE C62.41.2 is required. Can also be used with electronic fluorescent and HID ballasts.

DIMENSIONS:

SNAPLOCK™ Model

Snaps into a 3/4" K.O. or can be mounted by feet
All Dimensions are in inches (in)

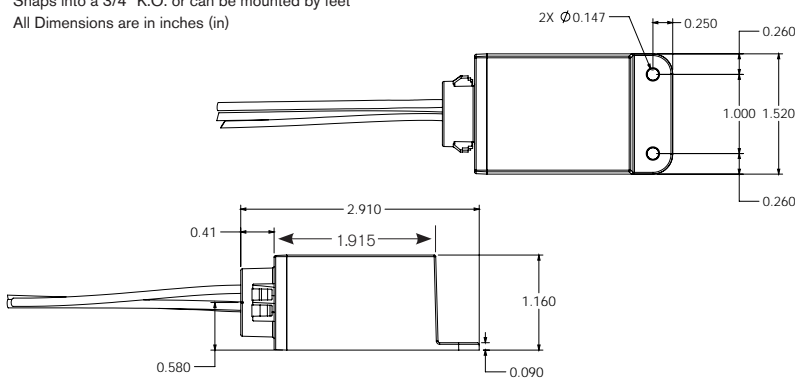

WIRING DIAGRAM:

