

# 200W COMPACT SUPER METALARC® PULSE START

High Lumen Maintenance, Reduced Color Shift, Reduced Outer Jacket, Premium Metal Halide Lamp



### PULSE START Technology

- Quicker hot re-strike\*
- Extended average rated life
- Less color shift over lamp life\*

### COMPACT Lamp Design

- Compact ET23.5 outer jacket
- 50% longer life than standard 250 watt

### SUPER Lamp Design

- Optimized light output
- Energy efficient
- Lead-free welded base
- Whiter light: CCT = 4200K
- Enhanced efficacy = 95LPW

\*Compared to Standard Metal Halide Lamps

### Product Availability

Wattage	Bulb Shape
200	ET23.5

SYLVANIA COMPACT SUPER METALARC PULSE START lamps combine the advantages of PULSE START lamp technology with a SYLVANIA COMPACT METALARC and SUPERSAVER® lamp design. The end result is an energy efficient lamp with high lumen maintenance and less color shift in a small outer jacket to improve system efficiency.

SYLVANIA 200W COMPACT SUPER METALARC PULSE START lamps provide increased system efficiency, less color shift, high lumen maintenance and a long life. Their premium performance provides opportunities for higher maintained illumination levels and substantial energy savings. The compact design offers the ability to improve fixture optics.

### Lamp Comparison

64837 versus 64457 and 64507

Lamp Type	Hot Re-strike	Avg. Rated Life (Hrs)	Outer Jacket	LCL	MOL
200 Watt PULSE START** MS200/PS/BU-ONLY/ET23.5	4 to 7 min.	15,000	ET23.5	4.5"	6.9"
250 Watt Standard M250/U	10 to 12 min.	10,000	BT28	5"	8.3"
320 Watt PULSE START MS320/PS/BU-HOR	4 to 7 min.	20,000	BT28	5"	8.3"

\*\*30% higher mean lumens than the standard 250 Watt METALARC lamps

### Application Information

#### Applications

Ambient Lighting: Industrial & Commercial  
Parking Lots  
Canopy Lighting

#### Fixtures

Contact your local fixture agent for available fixtures.

#### Application Notes

1. Operating orientation: Base-up only, within 15° of vertical
2. Lamps operate in standard mogul HID sockets rated to withstand 4000V pulses.

Contact your OSRAM SYLVANIA Representative for a list of compatible electronic operating systems.



**Sample Specification**

Lamp(s) shall be (a) 200W METALARC PULSE START lamp(s) with a 15,000-hour average rated life capable of operating on a M136 ballast. Lamp construction shall include a ET23.5 outer jacket with a lead-free welded base with a maximum temperature of 250°C.

**Installed Savings – Lowers Energy Costs!**

Item Number	Ordering Abbreviation	Watts	Number of Lamps	Energy Cost per Year***	% Savings vs.	
					250W	320W
64507	MS320/PS/BU-HOR	320	32	\$4,485	–	–
64457	MS250/U	250	32	\$3,504	–	–
64837	MS200/PS/BU-ONLY/ET23.5	200	32	\$2,803	20%	38%

\*\*\*4380 hours/year, \$0.1kWh

**Ordering and Specification Information**

Item Number	Ordering Abbreviation	Watts	Bulb	Base	ANSI Spec. No.	Average Rated Life (Hrs)	Initial Lumens	Mean Lumens	CCT	CRI
64837	MS200/PS/BU-ONLY/ET23.5	200	ET23.5	E39	M136/E	15,000	19,000	13,300	4200K	65

Notes:

- Based on 10 hrs/start operating cycle. On 120 hrs/start, life rating increases to 30,000 hours and mean lumens will be 28,000.
- When operated on ballasts having a sustaining voltage less than 270V, lamp life may be significantly reduced.

E = Lamps classified as E-type are to be used **OL** in suitably enclosed luminaires. See lamp warning.

**Ordering Guide**

MS	200	/	PS	/	BU-ONLY	/	ET23.5
S = Super Metalarc High Output Metal Halide	Wattage: 200 watts		PULSE START		Operating position: Base up Only		ET = Ellipsoidal Tubular 23.5 = 2 15/16" bulb diameter

**Dimensions**

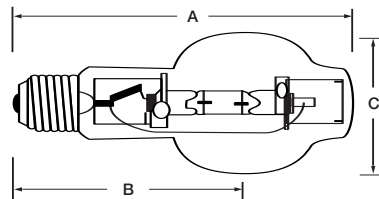

	A OL	LCL	C ulb Diameter
MS200/PS/BU-ONLY/ET23.5	6.9"	4.5"	2.94"

OSRAM SYLVANIA  
National Customer  
Service and Sales Center  
18725 N. Union Street  
Westfield, IN 46074

**Industrial Commercial**

Phone: 1-800-255-5042  
Fax: 1-800-255-5043

**ational Accounts**

Phone: 1-800-562-4671  
Fax: 1-800-562-4674

**OESpecialty arets**

Phone: 1-800-762-7191  
Fax: 1-800-762-7192

**PhotoOptic**

Phone: 1-888-677-2627  
Fax: 1-800-762-7192

In Canada  
OSRAM SYLVANIA LTD.  
Headquarters  
2001 Drew Road  
Mississauga, ON L5S 1S4

**Industrial Commercial**

Phone: 1-800-263-2852  
Fax: 1-800-667-6772

**Special arets**

Phone: 1-800-265-2852  
Fax: 1-800-667-6772

**Technical Information**

**Typical Lumen aintenance Curve**

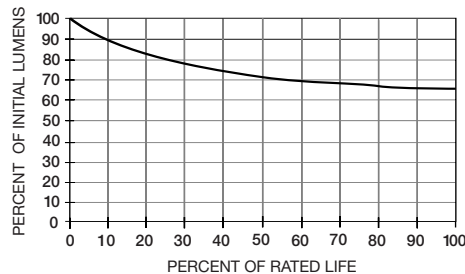

**Typical ortality Curve**

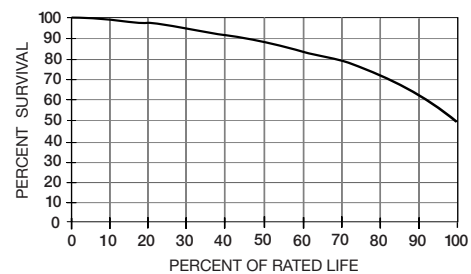

**Ultraviolet Radiation Exposure**

WARNING! THESE LAMPS CAN CAUSE SERIOUS SKIN BURN AND EYE INFLAMMATION FROM SHORT-WAVE ULTRAVIOLET RADIATION IF THE OUTER ENVELOPE (GLASS BULB) OF THE LAMP IS BROKEN OR PUNTURED. Do not use where people will remain for more than a few minutes unless adequate shielding or other safety precautions are used. Lamps that will automatically extinguish when the outer envelope is punctured or broken are commercially available from OSRAM SYLVANIA Products Inc. THESE LAMPS CONFORM TO FEDERAL STANDARD 21 CFR 1040.30 in the U.S. AND SOR/80-381 in Canada.