

IMPORTANT! PLEASE READ INSTRUCTIONS BEFORE ASSEMBLING!

TREE KEEPER

ROLLING STAND INSTRUCTIONS

MODEL TK-10259 & TK-10260

CONTENTS

INCLUDED TOOLS: Screwdriver & Wrench

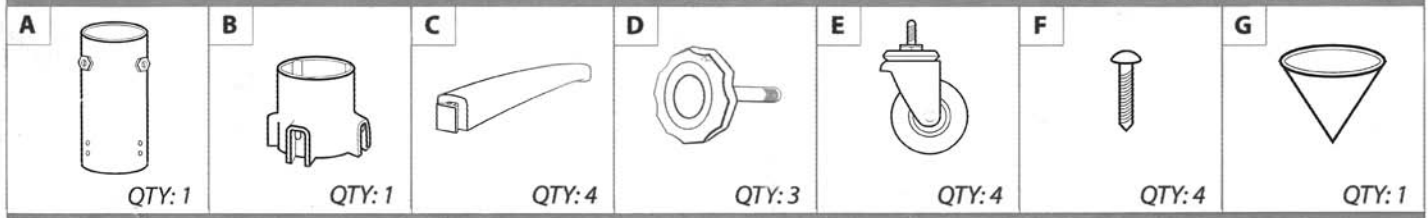

IMPORTANT NOTE: WHICH TRUNK DO YOU HAVE?



Before you begin, note the bottom of your tree trunk. If you have a pointed trunk then the below instructions are sufficient. However, if you have a flat trunk then there is one additional step to ensure your tree's stability involving the included cone, Part G. Before Step 3, simply rest the cone (G) in the hole on the bottom of the base collar (B); if you have already performed steps three and four just remove the inner collar and insert the cone (G). Then insert the inner collar (A), which will rest on top of the cone. Proceed onto step 4 as normal.

ASSEMBLY INSTRUCTIONS

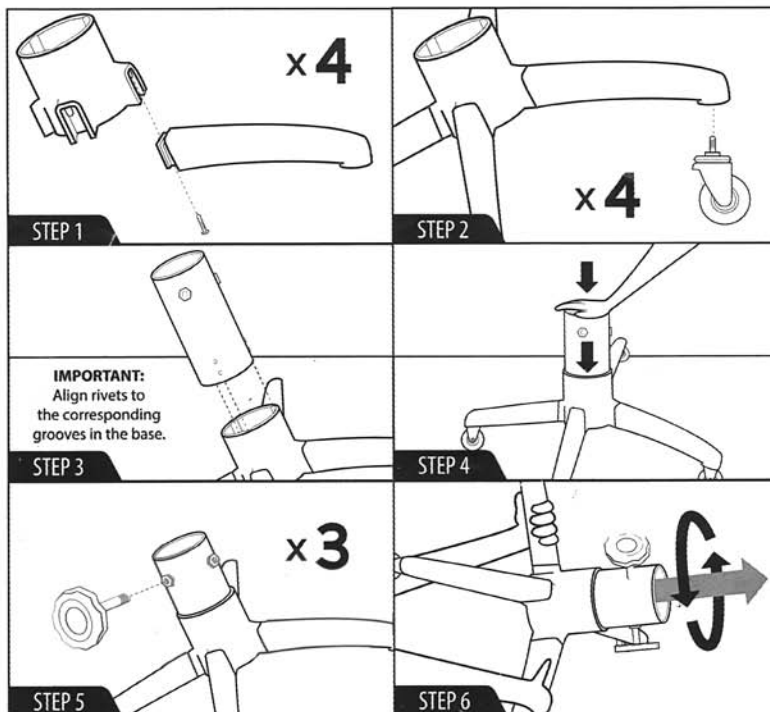

Step 1. Slide a stand leg (C) into the notched section on the base collar (B). Secure by fastening a screw (F) with the provided screwdriver. Repeat this with all legs.

Step 2. Attach a castor (E) to each of the four legs (C). Tighten with the provided wrench. **READ IMPORTANT NOTE BELOW BEFORE PROCEEDING.**

Step 3. When installing the inner collar (A) make sure the rest of the stand is sitting on a flat surface. In order to avoid installation problems make sure to align the inner collar (A) perfectly with the base collar (B) and **making sure to align the rivets with the corresponding indentations in the base before pushing it in.**

Step 4. Once perfectly aligned, push straight down with your hand while the stand rests on a flat surface. Make sure the metal inner collar is completely inserted all the way into the molded plastic center piece. You may have to exert some pressure directly down onto the metal collar to completely slide it into place. Remember to keep the collar aligned while pushing.

Step 5. Screw in all three tension knobs (D) into the stand collar (A) through the bolt holes. Once you set your tree into the stand. Tighten the knobs (E) equally to secure the tree trunk.

Step 6 - TROUBLESHOOTING. If you were unable to successfully install the inner collar in Step 4 due to misalignment then have someone hold the base of the stand while you use the knobs to get an appropriate grip. Next twist back and forth to loosen the inner collar from the base collar and pull it out as to allow you to then properly align it and reinsert it correctly.