

Absorbant Glass Mat (AGM) technology for superior performance. Valve regulated, spill proof construction allows safe operation in any position. Approved for transport by air. D.O.T., I.A.T.A., F.A.A. and C.A.B. certified. U.L. recognized under file number MH 20567.

Maintenance-Free

## Specification

|   |                                  |              |               |
|---|----------------------------------|--------------|---------------|
| <b>Nominal Voltage</b>                                    | 12 volts                         |              |               |
| <b>Nominal Capacity</b>                                   | 77° F (25° C)                    |              |               |
| 20-hr. (1.30A)  | 26.0 Ah                          |              |               |
| 10-hr. (2.42A)  | 24.2 Ah                          |              |               |
| 5-hr. (4.42A)   | 22.1 Ah                          |              |               |
| 1-hr. (15.6A)   | 15.6 Ah                          |              |               |
| <b>Approximate Weight</b>                                 | 17.0 lbs (7.7 kgs)               |              |               |
| <b>Internal Resistance (approx.)</b>                      | 14mΩ                             |              |               |
| <b>Shelf Life (% of normal capacity at 68° F (20° C))</b> |                                  |              |               |
| 3 Months  | 6 Months                         | 12 Months    |               |
| 91%   | 83%                              | 64%          |               |
| <b>Temperature Dependency of Capacity (20 hour rate)</b>  |                                  |              |               |
| 104° F (40° C)  | 77° F (25° C)                    | 32° F (0° C) | 5° F (-15° C) |
| 102%  | 100%                             | 85%          | 65%           |
| <b>AGM Operational Temperature</b>                        |                                  |              |               |
| Charge  | 32° F to 104° F (0° C to 40° C)  |              |               |
| Discharge   | 5° F to 113° F (-15° C to 45° C) |              |               |
| <b>AGM Storage Temperature</b>                            | 5° F to 104° F (-15° C to 40° C) |              |               |



Note: May be labeled as UB12260K  
Due to continuous improvements to our products, product may vary slightly from depiction.

|   |                 |                  |
|---|-----------------|------------------|
| <b>Charge Method (Constant Voltage)</b> |                 |                  |
| <b>Cycle Use (Repeating Use)</b>        | Initial Current | 7.8 A or smaller |
|   | Control Voltage | 14.6 - 14.8 V    |
| <b>Float Use</b>                        | Control Voltage | 13.6 - 13.8 V    |

## Physical Dimensions: in (mm)

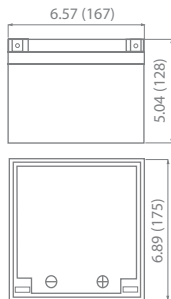

**L:** 6.57 in (167 mm)  
**W:** 6.89 in (175 mm)  
**H:** 5.04 in (128 mm)  
**TH:** 5.04 in (128 mm)  
 Tolerances are +/- 0.04 in. (+/- 1mm) and +/- 0.08 in. (+/- 2mm) for height dimensions. All data subject to change without notice.

## Terminals (T3)

### T Series (Tab Terminal)

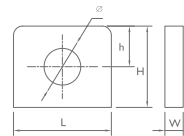

| Type | Dimension | L                  | W                  | H                  | h                  | ∅                  |
|------|-----------|--------------------|--------------------|--------------------|--------------------|--------------------|
| T3   |           | 14.0 mm<br>0.55 in | 2.00 mm<br>0.09 in | 12.5 mm<br>0.49 in | 6.00 mm<br>0.24 in | 6.00 mm<br>0.24 in |

## Discharge Time vs. Discharge Current

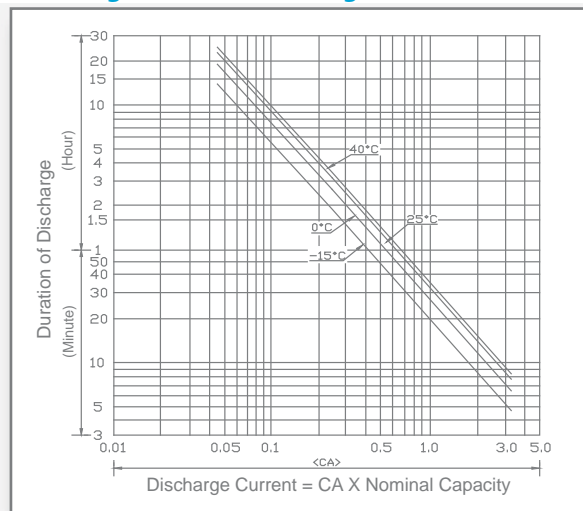

## Discharge Characteristics

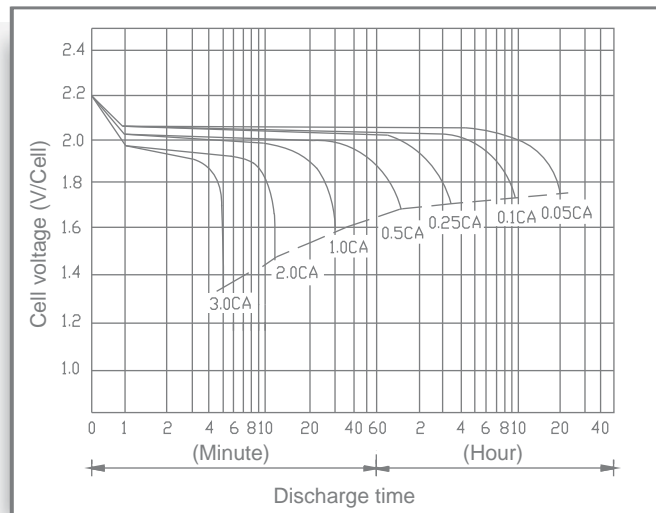

ISO 9001

All specifications subject to change without notice.

### Shelf Life & Storage

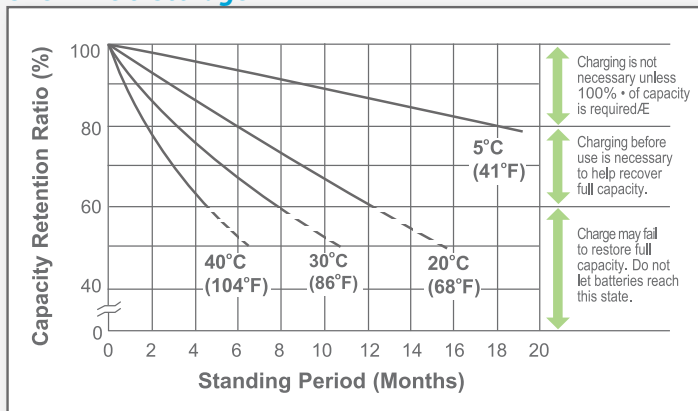

### Cycle Life vs Depth of Discharge

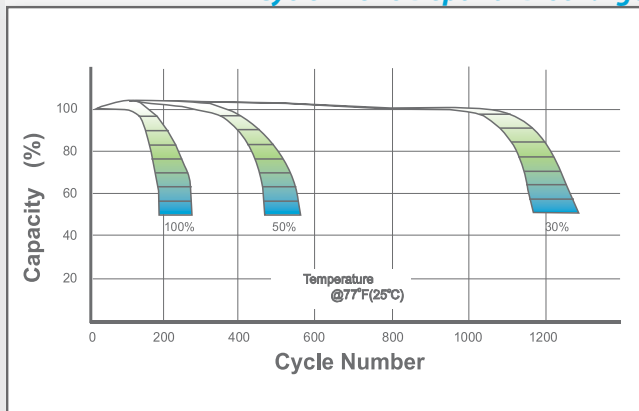

### Open Circuit Voltage vs Residual Capacity

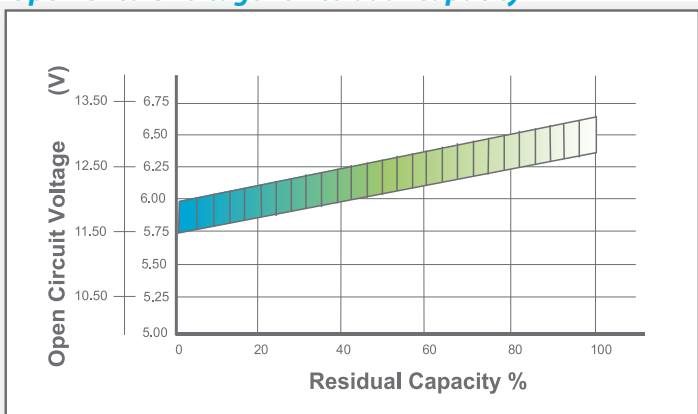

### Effect of Temperature on Capacity

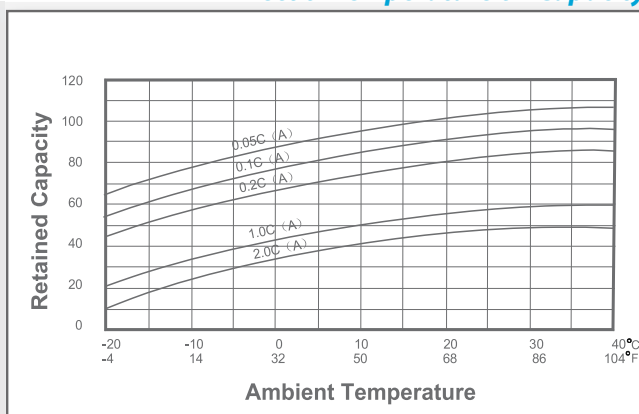

### Charge Current & Final Discharge Voltage

| Application | Charge Voltage(V/Cell) |           |                 | Max.Charge Current | Final Discharge Voltage V/Cell | 1.75     | 1.70          | 1.60          | 1.30     |
|-------------|------------------------|-----------|-----------------|--------------------|--------------------------------|----------|---------------|---------------|----------|
|             | Temperature            | Set Point | Allowable Range |                    |                                |          |               |               |          |
| Cycle Use   | 25°C (77°F)            | 2.45      | 2.40~2.50       | 0.30C              | Discharge Current(A)           | 0.2C>(A) | 0.2C<(A)<0.5C | 0.5C<(A)<1.0C | (A)>1.0C |
| Standby     | 25°C (77°F)            | 2.30      | 2.27~2.30       |                    |                                |          |               |               |          |



Let UPG Power Your Life.